

VOLUME XVI
NUMBER FOUR

THE QUARTERLY



LOCAL
HISTORY
AND
GENEALOGICAL
SOCIETY

DALLAS, TEXAS

DECEMBER, 1970

WINTER ISSUE

COOPERATING WITH THE DALLAS PUBLIC LIBRARY

CONTAINS NAME INDEX OF ALL ISSUES
VOLUME XV, 1969

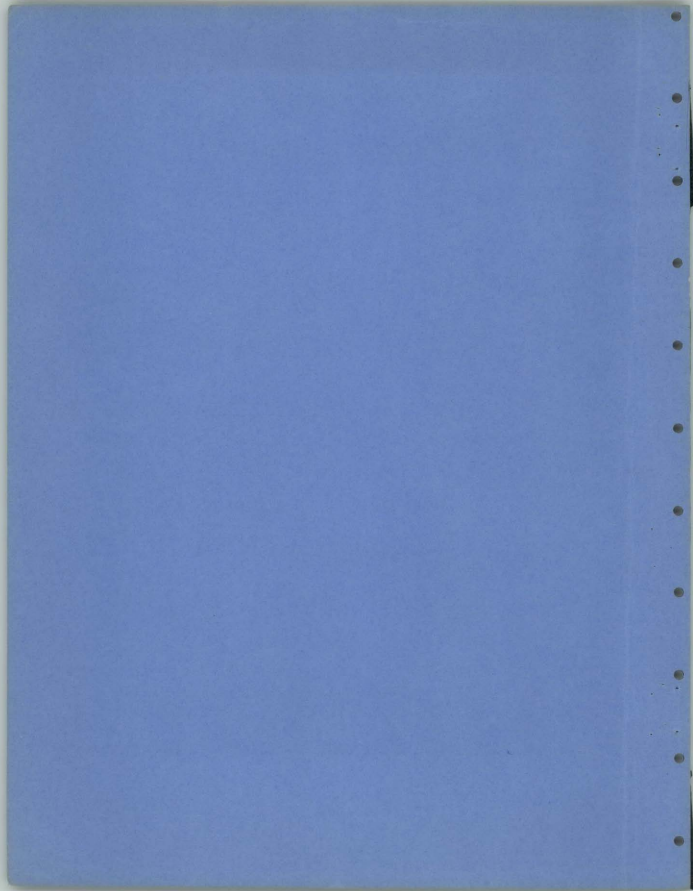

Local History and Genealogical Society

A TEXAS CORPORATION

DALLAS, TEXAS

Cooperating with the
DALLAS PUBLIC LIBRARY

MRS. P. E. DISHMAN
Editor

THE QUARTERLY

VOLUME XVI

DECEMBER, 1970

NUMBER FOUR

OUR CREED: A people which takes no pride in the noble achievements of remote ancestors will never achieve anything worthy to be remembered with pride by remote descendants." Lord Macaulay

C O N T E N T S

	PAGE
1970 Annual Report of Local History & Genealogical Society -----	1 - 2
Dallas County Marriages - continued -----	3 -10
Early Days in Dallas - Mrs. R. E. Sanders, Jr. -----	11-17
Calahan Family Bible Records - Mrs. Jewell Young -----	18
Webb Chapel Cemetery Records - Mrs. J. W. McMillan -----	19-25
Annual Book Award -----	25
Logan Bible & Family Records - Mrs. M. L. Moore -----	26-34
Surname Query Index - Genealogy Dept., Dallas Public Library -----	34-36
Hutchins, Dallas County, Cemetery Records - Mrs. Lowell I. Cansler, Jr. -----	37-46
The Strachan Family Bible -----	47-50
Collin County, Texas - 1867 - Assessment of Property Situated in other Counties - Mrs. Edward Hughston -----	51-57
The Dallas Herald - July 12, 1856 -----	58-59
News Items - From The Board -----	60-61
Officers & Directors of Local History & Genealogical Society -----	62
Membership Information from Article III By-Laws of Local History & Genealogical Society -----	63
INDEX to Volume IV, Nos. 1, 2, 3 and 4 -----	64-74

Local History and Genealogical Society

1914
Dallas, Texas
Volume 10, No. 1

THE OF ARKLY

1	...
2	...
3	...
4	...
5	...
6	...
7	...
8	...
9	...
10	...
11	...
12	...
13	...
14	...
15	...
16	...
17	...
18	...
19	...
20	...
21	...
22	...
23	...
24	...
25	...
26	...
27	...
28	...
29	...
30	...
31	...
32	...
33	...
34	...
35	...
36	...
37	...
38	...
39	...
40	...
41	...
42	...
43	...
44	...
45	...
46	...
47	...
48	...
49	...
50	...
51	...
52	...
53	...
54	...
55	...
56	...
57	...
58	...
59	...
60	...
61	...
62	...
63	...
64	...
65	...
66	...
67	...
68	...
69	...
70	...
71	...
72	...
73	...
74	...
75	...
76	...
77	...
78	...
79	...
80	...
81	...
82	...
83	...
84	...
85	...
86	...
87	...
88	...
89	...
90	...
91	...
92	...
93	...
94	...
95	...
96	...
97	...
98	...
99	...
100	...

1970 ANNUAL REPORT
OF
LOCAL HISTORY AND GENEALOGICAL SOCIETY

The success of our society for 1970 has been reached by the combined efforts of our Officers and Directors and the participation of our members in our Workshop and our meetings. Our thanks to Mrs. Lucile Anderson Boykin and her staff for their cooperation and continuing efforts for all of us.

The change in location of our evening meetings from downtown to Preston Center may be measured as popular and a big success. Attendance after the change increased from around forty to eighty. The coffee break after the program has been well attended and has given us time to get acquainted with an informal, friendly atmosphere.

The Workshop in May met the demand for research help in Georgia, Tennessee and Louisiana by talented speakers Mrs. Mary Bondurant Warren, Miss Pollyana Creekmore and Mr. Norman E. Gillis. Over a hundred people attended these lectures. Our thanks to Mrs. J. R. Macdonald, Dr. Ben Smith, Mr. Porter Lindsley, Mr. and Mrs. Tom Walker, Mr. L. A. Busby, Mrs. A. E. Lush, Mrs. D. C. Cleare, Mrs. Jo Ann Martin, Miss Mable Wilkerson, Mrs. Jeremiah Welch, Mrs. Arthur Prestridge and many others whose efforts made the meetings successful. We greatly appreciate the cooperation of the Lone Star Gas Company and El Centro Junior College who provided places for us to meet.

We appreciate the work of Miss Nancy Miller, our Recording Secretary, who has done a thorough job of reporting our meetings accurately and in detail.

Our Quarterly Magazine continues to get approval from our readers. Thanks to our contributors and, especially, to our Editor Mrs. Roy E. Dishman are gratefully extended.

We are proud of the courses initiated and continued at El Centro Junior College for beginners in family research and later for advanced study in how to get the job done. We credit Mrs. Macdonald's efforts to win approval of El Centro Junior College to present the courses. We applaud the success of the course leaders Mrs. Lush and Mr. Conger for the first session. They also presented the advance course at the second session with Mrs. Ben Dickson and Mr. Will F. Lowrance ably assisting with the second beginners course. We think the courses will continue to fill the demands and needs for learning how to research family history in the future.

The postcard notices of meetings continue to keep our members informed of our meetings. Mr. Percy Fewell helped to start this program. Mrs. Jack A. Morris has handled our communications very well and deserves our thanks.

Our memorials to deceased members have been reported in our Quarterly. Usually appropriate books to the Dallas Public Library have been selected and given, as authorized by our Board of Directors, as memorials.

Our annual income tax report has been made with the assistance of Judge Dee Brown Walker and Miss Ada Miller, our treasurer.

A detailed report of our finances has been made at our regular meetings. There is a cash balance to start 1971 satisfactorily. Our thanks to Miss Ada Miller, our Treasurer, for handling her duties so promptly and well.

Thanks again for the fine assistance of the offices and members who helped me carry the Society in new and continuing areas the past two years. Your help will maintain the quality of our programs and the Quarterly.

Respectfully yours,

Hershel W. Anderson

Hershel W. Anderson
President, 1970

LUSH CUSTOM MICROFILM (Mr. & Mrs. A. E. Lush) 2737 O'Bannon Drive, Dallas, Texas 75224. (941-0606). PRESERVE YOUR RESEARCH NOTES, DOCUMENTATIONS, RARE BOOKS, NEWSPAPERS, ETC. ON MICROFILM FOR SAFEKEEPING OR FOR DONATION OR SALE. 16 or 35 mm. PERSONAL ATTENTION AND REASONABLE RATES (\$10 min.) INQUIRIES WELCOMED.

History of Lexington, Kentucky by G. W. Ranck (Henry Clay Press, Box 116, Lexington, Kentucky. Reprint of 1872 edition. \$10.95 pp.) The original is a very scarce book, though the Texas History and Genealogical Dept. has a copy. Mr. Ranck covered all possible subjects in Lexington with one exception. He has interesting paragraphs on some of the more important leaders. He covers the churches, the doctors, the banks, in chapters of varying lengths. The one subject he doesn't cover is the War, which was too recent in a border state to be written about without losing friends. If you are interested in Lexington, get it before it goes out of print again.

History of the Little Church on the Circle, Christ Church Parish, Indianapolis, 1837-1955. (Available from Christ Church, Indianapolis, Indiana.) This story of the first Episcopal Church in Indianapolis, is the story of that city and has much about the church in Indiana, as Christ Church became the Cathedral. The book is thoroughly researched and the author was able to find much interesting material to make the early days come alive. A number of fine pictures are included of the church, clergymen and some outstanding laymen. A good book for anyone, Episcopalian or otherwise, interested in the city of Indianapolis.

EARLY MARRIAGE RECORDS, DALLAS COUNTY, TEXAS

MARRIAGE BOOK A-B - 1852 - 1854

Part III, Continued from Vol. XVI, No. 3, September 1970

- Stephen B. McCommas and Caroline Barnes, Dec. 14, 1851, by A. Beard, J.P.
A. Harwood Clk. Co. Ct.
- John M. Holland and Orzilla M. Heath, Jan. 8, 1852, by Wm. Horne, J.P.
A. Harwood Clk. Co. Ct.
- Amos T. Heath and Sarah L. Parks, 11 Dec. 1851 by Wm. Horne, J.P.
A. Harwood Clk. Co. Ct.
- Solomon Dixon and Kissiah Wiley, Feb. 26, 1852, by A. Beard, J.P.
A. Harwood Clk. Co. Ct.
- James G. Manley and Rosana Campbell, Jan. 8, 1852, by D. W. Wright, M.G.
Meth. Epis. Ch. S. A. Harwood, Clk. Co. Ct.
- Robert G. Gilbert and Mary Jane Wisdom, March 14, 1852, by J. W. Latimer,
Chief Justice. A. Harwood, Clk. Co. Ct.
- A. B. Lanier and Judah Burchfield, Feb. 7, 1852, by John Lanier, J.P.
A. Harwood, Clk. Co. Ct.
- James W. Ingleheart and Mary A. Conditt, Feb. 26, 1852, by Wm. Horne, J.P.
A. Harwood, Clk. Co. Ct.
- Jefferson Weatherford and Sarah Neely, March 4, 1852, by Samuel Clark, M.G.
A. Harwood, Clk. Co. Ct.
- John L. Frost and Elizabeth F. Blue, March 11, 1852, by John U. Vance, M.G.
A. Harwood Clk. Co. Ct.
- Geo. W. Ferguson and Mary Ann Hyder, March 27, 1852, by Wm. Horne, J.P.
A. Harwood Clk. Co. Ct.
- James D. Shelby and Mary Ann Elizabeth Adams, May 6, 1852, by Jacob Reager,
J. P. Harwood, Clk. Co. Ct.
- Claiborne Hughs and Martha America Walker, June 8, 1852, by T. W. Griffin,
Elder C. Ch. A. Harwood Clk. Co. Ct.
- Chas. H. Spencer and Sarah Marion, June 10, 1852, by N.H.O. Polly, Elder,
Church of Christ. W.W. Peak, Dpty. Clk.Co.Ct.
- Anderson D. Rice and Ann Frances Russell, June 24, 1852 by James A. Smith, M.G.
W.W. Peak, Dpty.Clk.Co.Ct.
- Wm. H. Newby and Elizabeth Lerner, July 14, 1852, by D. Myers, M.G.
W.W. Peak, Dpty.Clk.Co.Ct.
- Carter H. Hurst and Mary Ann Evans, July 19, 1852, by J. J. Metcalf, J.P.
W.W. Peak, Depty. Clk. Co.Ct.

- James Morris and Susanna Chowning, Aug. 22, 1852, by ^{John M.} P. Myers, M.G.
W.W. Peak, Dpty. Clk. Co. Ct.
- Riley Hunsaker and Rebecca Beets, Aug. 26, 1852, by A. Beard, J.P. W.W. Peak,
Dpty. Clk. Co. Ct.
- Reuben W. Rowe and Elizabeth Marks, Sept. 20, 1852, by Thos. D. Coats, J.P.
A. Harwood Clk. Co. Ct.
- Franklin S. Perry and Sarah Jane McCants, Sept. 15, 1852, by Eli Witt, M.G.
A. Harwood, Clk. Co. Ct.
- Allanson Dowdy and Mary Kinney, Oct. 10, 1852, by M. R. Fondren, J.P.
W. W. Peak, Dpty. Clk. Co. Ct.
- Geo. W. Fisher and Elizabeth Cook, Oct. 13, 1852, by Eli Witt, M.G.
W. W. peak, Dpty. Clk. Co. Ct.
- Eli Murphy and Mary Leake, Oct. 14, 1852 by Eli Witt, M.G. W. W. Peak,
Clk. Co. Ct.
- Joseph H. Lacy and Elizabeth Smith, Oct. 14, 1852, by W. B. Fondren, J.P.
W. W. Peak, Dpty. Clk. Co. Ct.
- James G. Hyden and Matilda Smith, Oct. 19, 1852, by John Lanier, J.P.
W.W. Peak, Dpty. Clk. Co. Ct.
- William Whitfield and Sarah Prigmore (no date) by James A. Smith, License
issued Oct. 27, 1852. by J. Lanier Dpty. Clk. Co. Ct.
- Daniel Castor and Nancy Beets, Nov. 18, 1852 by A. Beard, J.P.
W.W. Peak, Dpty. Clk. Co. Ct.
- Alexander R. Rawlins and Virginia E. Bledsoe, Oct. 20, 1852, by N.H.O. Polly,
Elder in Christ Church. W.W. Peak, Dpty. Clk. Co. Ct.
- James M. Bennett and Miranda Dye, De. 23, 1852, by Thos. D. Coats, J.P.
W.W. Peak, Dpty. Clk. Co. Ct.
- W. W. Ware and Martha Jane Ledbetter, Dec. 26, 1852, by S. Durrett, J.P.
W.W. Peak, Dpty. Clk. Co. Ct.
- John J. Reese and Elizabeth Wood, Dec. 2, 1852, by Wm. Horne, J.P.
W. W. Peak, Dpty. Clk. Co. Ct.
- Daniel Brown and Mary Blacker, Jan. 2, 1853, by James A. Smith, M.G.
W.W. Peak, Dpty. Clk. Co. Ct.
- Wm. Masters and Mary Elizabeth Newby, Nov. 4, 1852, by Robert Crawford, M.G.
W. W. Peak, Dpty. Clk. Co. Ct.
- Robert F. Merrell and Mary Jane Horn, Jan. 11, 1853, by J. J. Metcalf, J.P.
W.W. Peak, Dpty. Clk. Co. Ct.
- Wm. Beverly and Rebecca Crownover, Feb. 17, 1853, by James A. Smith, M.G.
W.W. Peak, Dpty. Clk. Co. Ct.

- Benjamin J. Prigmore and Nancy L. Jackson, Feb. 8, 1853 by James A. Smith, M.G.
W.W. Peak, Dpty. Clk. Co. Ct.
- Wm. S. Ricketts and Sarah M. Wampler, Feb. 17, 1853, by W. B. Fondren, J.P.
W.W. Peak, Dpty. Clk. Co. Ct.
- William H. Keen and Mary R. Marley, March 3, 1853, by Joseph Amos, J.P.
W. W. Peak, Dpty. Clk. Co. Ct.
- John W. Farns and Mary Jane Fletcher, March 13, 1853, by S. Durrett, J.P.
W.W. Peak, Dpty. Clk. Co. Ct.
- Andrew T. Low and Mary Elizabeth Hart, Feb. 17, 1853, by J. A. Cope, M.G.
W.W. Peak, Dpty. Clk. Co. Ct.
- Jeremiah H. Holford and Mary Hart, March 3, 1853 by A. Beard, J.P. W.W. Peak
Dpt. Clk. Co. Ct.
- James Beverly and Mary Jane Huffhine, March 16, 1853, by Jas. A. Smith, M.G.
W.W. Peak, Dpty. Clk. Co. Ct.
- James Cook and Sarah E. Mayes, March 31, 1853, by Jas. A. Smith, M.G.
W.W. Peak, Dpty. Clk. Co. Ct.
- Charles G. Newton and Adaline L. Keen, April 6, 1853, by Jas. A. Smith, M.G.
W. W. Peak, Dpty. Clk. Co. Ct.
- Jas. Martin and Clara A. West, April 14, 1853, by A. J. Clark, J.P.
W. W. Peak, Dpty. Clk. Co. Ct.
- F. N. Fassallo and Susan A. T. Dye, April 19, 1853, by Jas. A. Smith, M.G.
W. W. Peak, Dpty. Clk. Co. Ct.
- William E. Morris and Nancy J. Marshall, March 27, 1853 by R. Crawford, M.G.
W.W. Peak, Dpty. Clk. Co. Ct.
- Nathaniel B. Everts and Eunice H. Baker, May 1, 1853 by W. B. Fondren, J.P.
W.W. Peak, Dpty. Clk. Co. Ct.
- William J. Snow and Eleanor Ottwell, May 5, 1853, by Elder Milton Glover,
W.W. Peak, Cpty. Clk. Co. Ct.
- Wm. H. Shelton and Elizabeth Ottwell, 19 April 1853, by Elder Milton Glover.
W.W. Peak, Dpty. Clk. Co. Ct.
- Augustus H. Martin and Susan A. Merryfield, May 19, 1853, by Jas. A. Smith, M.G.
W.W. Peak, Dpty. Clk. Co. Ct.
- Archer Fyke and Jemima Myers, May 22, 1853, by J. M. Myers, M.G.
W.W. Peak, Dpty. Clk. Co. Ct.
- Francis M. White and Martha Jane Gray, May 11, 1853, by W. B. Fondren, J.P.
W.W. Peak, Dpty. Clk. Co. Ct.
- Joseph N. Whittenberg and Nancy E. Wilson, June 14, 1853 by Finis E. King,
Minister, of C.P.Ch. A. Harwood, Clk. Co. Ct.

- . Calvin Black and Narcissus Reed, June 16, 1853, by S. Durrett, J.P.
W. W. Peak, Dpty. Clk.Co.Ct.
- . Matthew Howard and Milla Edwards, June 12, 1853, by Elder Milton Glover.
A. Harwood, Clk. Co. Ct.
- . Eldridge Gill and Lucinda M. McDonald, June 23, 1853, by T. V. Griffin,
Elder C. Ch. A Harwood, Clk. Co.Ct.
- . Benj. Harper and Cinthia Ellison, July 3, 1853, by Jno. Snead, M.G.
W. W. Peak, Dpty. Clk.Co.Ct.
- . John Edwards and Mary Francis Rowe, May 29, 1853, by Thos. D. Coats, J.P.
W. W. Peak, Dpty. Clk. Co.Ct.
- . Elijah D. Bennett and Priscilla Skurlock, July 9, 1853, by A. Beard, J.P.
W. W. Peak, Dpty. Clk. Co. Ct.
- . Edmund Morris and Mary W. Nance, July 15, 1853, by Wm. Horne, J.P.
W. W. Peak, Dpty. Clk. Co. Ct.
- . Wm. D. Hittson and Eliza Jane James, Aug. 1, 1853, by Amon McCommas, M.G.
W.W. Peak, Dpty. Clk. Co. Ct.
- . Stephen D. Conger and Mary E. Rhodes, July 5, 1853, by R. Crawford, M.G.
W.W. Peak, Dpty. Clk. Co. Ct.
- . Foster W. Dunaway and Eureka M. Granberry, Aug. 24, 1853 by James A. Smith,
M.G. W. W. Peak, Dpty. Clk. Co. Ct.
- . Russell G. B. Williams and Eliza Earnest, Aug. 4, 1853, by J. J. Metcalf, J.P.
W. W. Peak, Dpty.Clk.Co.Ct.
- . Thomas A. Burks and Delilah Hall, July 10, 1853, by Elder N.H.O. Polly.
W. W. Peak, Dpty.Clk.Co.Ct.
- . James Wimberly and Priscilla A. Turner, Sept. 1, 1853, by James A. Smith, M.G.
W.W. Peak, Dpty. Clk.Co.Ct.
- . David Eddlemon and Nancy P. Earnest, Aug. 18, 1853, by Wm. Horne, J.P.
W.W. Peak, Dpty. Clk.Co.Ct.
- . Hubbard M. Rawlins and Lydia A. Parks, Sept. 19, 1853, by Samuel Clark, M.G.
W.W. Peak, Dpty.Clk.Co.Ct.
- . Thomas I. McCarroll and Susan O. Carpenter, Sept. 15, 1853, by Finis E. King,
C.P.Church. W.W. Peak, Dpty.Clk.Co.Ct.
- . Joshua L. Smith and Margaret S. Daniels, Aug. 10, 1853, by W. H. Hughes, M.G.
W.W. Peak, Dpty. Clk.Co. Ct.
- . Wm. H. Thomas and Mary J. Skiles, Sept. 29, 1853, by Jas. A. Smith, M.G.
W.W. Peak, Dpty.Clk.Co.Ct.
- . Luther Alexander Ogle and Angeline Cheshire, Aug. 9, 1853, by T.V. Griffin, M.G.
W.W. Peak, Dpty. Clk.Co.Ct.

- Ephraim J. Robinson and Catherine House, Oct. 13, 1853, by A. Beard, J.P.
W.W.Peak, Dpty. Clk.Co.Ct.
- Jackson F. Smith, and Martha E. Thompson, Aug. 29, 1853, by A. J. Clark, J.P.
W.W.Peak, Dpty.Clk.Co.Ct.
- Hope Mills and Malissa Hilton, Aug. 25, 1853, by A. J. Clark, J.P.
W.W.Peak, Dpty.Clk.Co.Ct.
- Ben Merrell and Sarah Ann Manning, Oct. 20, 1853, by Jas.A. Smith,M.G.
W.W.Peak, Dpty.Clk.Co.Ct.
- Thos. M. Hart and America Lowe, Oct. 18, 1853, by J.A. Cope, M.G.
W.W.Peak, Dpty.Clk.Co.Ct.
- Jacob Routh and Lodema A. Campbell, Oct. 30, 1853, by Arthur Ledbetter, M.G.
W.W.Peak, Dpty.Clk.Co.Ct.
- Jos. C. Reed and Emarine Horton, Nov. 7, 1853 by T.V.Griffin, M.G.
W.W.Peak, Dpty.Clk.Co.Ct.
- Pleasant R. Snow and Ann B. Hutt, Nov. 13, 1853, by Wm. Horne, J.P.
W.W.Peak, Dpty.Clk.Co.Ct.
- Thos. W. Archibald and Mary C. Maloy, Nov. 30, 1853, by Robert D. King,
Minister Cumberland Presbyterian Church. W.W.Peak, Dpty.Clk.Co.Ct.
- Henry Cook and Rachel J. Martin, Nov. 29, 1853, by Eli Witt, M.G. W.W. Peak
Dpty.Clk.Co.Ct.
- Micheal Faren and Myranda Haggard, Jan. 19, 1854, by Wm. Horne, J.P.
W.W.Peak, Dpty. Clk.Co.Ct.
- F. A. Sayrs and Sarah A. Thomas, Jan. 5, 1854, by Jas. A. Barker, M.G.
E. Crockett McKenzie, Dpty. Clk.Co.Ct.
- Garrett Langford and Rebecca Jane Evans, Feb. 27, 1854, by W. H. Hughes, M.G.
W.W. Peak, Dpty. Clk. Co.Ct.
- Geo. W. Paul and Eliza Ann Sandford, Jan. 29, 1854, by Thos. D. Coats, J.P.
E.C. McKenzie, Dpty. Clk.Co.Ct.
- Benjamin G. Lanham and Mary Ann Beeman, Feb. 5, 1854, by Samuel Clark, M.G.
E. Crockett McKenzie, Dpty.Clk.Co.Ct.
- Jefferson R. Rawls and Margaret Phillips, Jan. 29, 1854 by J.J. Metcalf, J.P.
W.W. Peak, Dpty.Clk.Co.Ct.
- John C. Heart and Nancy Ann Low, by license taken out 27, Dec. 1853. Filed 23
Jan. 1854. W.W.Peak, Dpty.Clk.Co.Ct.
- ^{Daniel} David Clepper and Elizabeth Hughs, Feb. 3, 1854, by John U. Vance, M.G.
(License was issued to David Tlepper and Elizabeth Hughs) Filed by W.W.
Peak, Dpty.Clk.Co.Ct. ^{Daniel}

- Peter Haight and Susanah Pruitt, March 1, 1854, by J. W. Latimer, Chief Justice. W.W. Peak, Dpty.Clk.Co.Ct.
- Nat M. Burford and Mary J. Knight, Jan. 18, 1854, by Jas. A. Smith, M.G. E. C. McKenzie, Dpty.Clk.Co.Ct.
- Leroy Worsham and Nancy Catherine Ashlock, March 17, 1854, by J. W. Latimer Chief Justice. E. Crockett McKenzie, Dpty.Clk.Co.Ct.
- Asher W. Carter and Ann Elizabeth Wood, March 23, 1854, by James A. Smith, M.G. W.W.Peak, Dpty.Clk.Co.Ct.
- James M. Russell and Irene Elizabeth Mackimer, Dec. 28, 1853, by Wm. Horne, J.P. W.W.Peak, Dpty.Clk.Co.Ct.
- Wm. H. Martin and Louisa Wilburn, Dec. 25, 1853, by A. J. Clark, J.P. E. Crockett McKenzie, Dpty. Clk.Co.Ct.
- Samuel A. Horn and Louisa McAnaw, Feb. 2, 1854, by J. J. Metcalf, J.P. E. Crockett McKenzie, Dpty.Clk.Co.Ct.
- J. L. Berry and America I. Hart, (no date) by Robt. Crawford, M.G. License issued April 8, 1854, filed April 15, 1854, by E.C. McKenzie, Dpty.Clk.Co.Ct.
- Calvin Guest and Nancy Henderson, Jan. 10, 1854, by Wm. Horne, J.P. E.C.McKenzie, Dpty.Clk.Co.Ct.
- Wormly Carter and Lucy Ann Anderson, Jan. 5, 1854, by Thos. D. Coats, J.P. W.W.Peak, Dpty.Clk.Co.Ct.
- William Sachse and Martha Ann Frost, March 23, 1854, by R. R. Dunlap, M.G. W.W.Peak, Dpty.Clk.Co.Ct.
- Henry Dye and Sarah E. Schiles, ---27, 1854, by James A. Smith, M.G. (License issued April 25, 1854 filed May 3, 1854) E.Crockett McKenzie, Dpty.Clk.Co.Ct.
- Amus Nicholson and Milissa Myrach, Feb. 12, 1854, by W.H.Ware, M.G. E.Crockett McKenzie, Dpty.Clk.Co.Ct.
- John Horton and Clarinda M. Young, March 30, 1854, by J.J.Metcalf, J.P. E.Crockett, McKenzie, Dpty.Clk.Co.Ct.
- Bradford C. Hurst and Emily Jane Irving, April 27, 1854, by Samuel Clark, M.G. E. Crockett McKenzie, Dpty.Clk.Co.Ct.
- Wm. W. Knight and Lucinda Rawlins, April 30, 1854, by Samuel Clark, M.G. E.C. McKenzie, Dpty.Clk.Co.Ct.
- Josiah Lockett and Sarah Jane Ray, May 14, 1854, by A. Beard, J.P. E.Crockett McKenzie, Dpty.Clk.Co.Ct.
- Thomas Montgomery and Zerilda Riley, April 30, 1854, by A. Beard, J.P. E. Crockett McKenzie, Dpty.Clk.Co.Ct.

- Joseph M. Tolver and Elizabeth Freeman, May 19, 1854, by J.W. Latimer, Chief Justice. W.W.Peak, Dpty.Clk.Co.Ct.
- John J. Good and Susan Anna Floyd, July 26, 1854, by James A. Smith, M.G. E.C. McKenzie, Dpty.Clk.Co. Ct.
- Drurey Green and Epsy Ann Sanford, July 28, 1854, by A. M.Dean, M.G. E. C. McKenzie, Dpty.Clk.Co.Ct.
- Samuel Hoover and Lucretia Frost, May 11, 1854, by R. R. Dunlap, M.G. E.C. McKenzie, Dpty. Clk.Co.Ct.
- Clement Goar and Susan Renfro, June 28, 1854, by W.B. Fondren, J.P. E.C.McKenzie, Dpty.Clk.Co.Ct.
- Samuel Brandenburgh and Lydia Houstes, by James Baker, M.G. June 14, 1854, by E.C.McKenzie, Dpty.Clk.Co.Ct.
- Wm. H. Rowe and Emily Daniels, (no date) License issued Feb. 9, 1854 by A. Harwood Clk.Co.Ct., filed for record Feb. 18, 1854, by W.W.Peak Dpty.Clk.
- Thomas B. Martin and Sarah M. Langford, July 20, 1854, by A. Beard, J.P. E.C.McKenzie, Dpty.Clk.Co.Ct.
- Quincy Adams Sweatt and Mary C. Miller, May 27, 1854 by Elder N.H.O. Polly. E.C.McKenzie, Dpty.Clk.Co. Ct.
- S. P. Mulkin and Eliza Jane McNeal, July 23, 1854, by W.D. King, M.G. E. Crockett McKenzie, Dpty.Clk.Co.Ct.
- Benjamin T. Davis and Liddy I. Mills, July 4, 1854, by Joseph L.Amus, J.P. E.C.McKenzie,Dpty.Clk.Co.Ct.
- Charles H. Brown, and Clarissa M.P.Bennett, June 13, 1854, by W.B. Fondren,J.P. E.C.McKenzie, Dpty. Clk.Co.Ct.
- Daniel Delay and Mary Smith, July 30, 1854 by Wm. Horne, J.P. W.W.Peak, Clk.Co.Ct.
- E. Caudle and Sarah Ann Rowland, Aug. 1, 1854, by W.B.Fondren, J.P. W.W.Peak Co.Ct.Clk.
- Absolem Potter and Lydia Badgley, July 5, 1854, by Thos. D. Coats, J.P. W.W. Peak Co.Ct. Clk.
- Jacob King and Martha C. Brown, Aug. 16, 1854, by A. Beard, J.P. A.W.Harwood, Dpty.Clk.Co.Ct.
- Thomas Jefferson Nolen and Emily (Emaline also given) T. Beedle, June 17, 1854, by A.Ledbetter, M.G. W.W.Peak, Clk. Co.Ct.
- James Moore and Sarah Ann Cox, Aug. 23, 1854, by A.Beard J.P. W.W.Peak Co.Ct.Clk.

- John J. Goodwin and Mary C. Hoggard, Aug. 24, 1854, by A. McCrackin, J.P. W.W. Peak, Clk.Co. Ct.
- John R. Lenard and Margaret M. Harrison, Aug. 31, 1854, by A. M. Dean, M.G. W.W. Peak, Clk.Co.Ct.
- Sampson Hart and Nancy Caldwell, Sept. 14, 1854, by A. Beard, J.P. W.W.Peak, Clk.Co.Ctd.
- Joseph Ruth and Sarepta Ellen Campbell, Sept. 28, 1854, by Jas. A. Smith, M.G. Clk.Co.Ct.
- Fayett Gracy and Margaret (Martha also given) A.E.Harris, Sept. 7, 1854, by Finis E. King, M.G. W.W. Peak, Clk.Co.Ct.
- George D. Peeler and Elizabeth T. Montgomery, Oct. 11, 1854 by (no name) W.W. Peak Clk.Co.Ct.

A Goodly Heritage, The Episcopal Church in Florida, 1821-1892 by John D. Cushman, Jr. (University of Florida Press, Gainesville, Fla. 1965.). When the Soundex Indexes of the 1880 censuses for the southern states were ordered by the Texas History and Genealogical Dept., Fla. was forgotten. This is a perfect indication of Florida's place in southern history. The Spanish and the English were the early settlers there, the American came late. There was much trouble with the Indians and soon after Florida gained its coveted statehood, it succeeded from the Union. Its history is most interesting but little known and not much written about. Besides being a thorough Episcopal history, this book gives much other information about Florida. Pictures and an excellent bibliography.

Lest We Forget. A Guide to Genealogical Research in the Nation's Capital, Compiled by June Andrew Babbel. (Published by Potomac Stake of the Church of Jesus Christ of Latter-Day Saints, P.O. Box 89, Annandale, Virginia 22003, \$3.50). I don't know why writers give titles to their books that are of no help in knowing what a book is about. However, the sub-title is descriptive. The inner cover of this paper-bound 110 page book has a map of Washington, with arrows pointing to the main libraries. The first page has columns listing what these libraries are, where they are and when they are open. It gives detailed chapters on the National Archives, Library of Congress, Library of Congress Annex, the D.A.R. Library and the National Genealogical Society. Detailed information is given, including such tips as being able to take a tape-recorder into a certain room, or that you must register the serial number of your typewriter with the guard. It also lists the location of various groups of material, describes the different indexes. A must to read before going to Washington, D.C.

EARLY DAYS IN DALLAS

By Mrs. Robert E. Sanders, Jr.
Dallas, Texas

(Copy of an address given by Mrs. Sanders at the Fall meeting of the
Local History & Genealogical Society, September 24, 1970)

What I intend to tell today are some of the factors that have gone into making Dallas the great city it is today. Whenever I have given this little talk - and it is in no sense a scholarly work - someone always says "Why don't you go past 1910 and tell some of the interesting things that happened in the 20's, or 40's or 60's?" My reply is always "I am a lawyer's daughter and I am not to be rash enough to get involved with any eye witnesses". Some of those who hear me may remember the years before 1910, but may not want to admit it.

Dallas has always been unique. This was just as true in the early days as it is now. Probably our most outstanding feature is our dynamic, determined people - the wheeler-dealers. They made a city out of a village that had no assets that a half-dozen other communities of this area already had, except its people.

John Neely Bryan - Dallas's founder - was the first wheeler-dealer. He first came to Texas in 1839, crossing the Red River and following the lay of the land for 100 miles until he reached the three Forks of the Trinity. He noticed a small bluff above a natural river crossing. He took a piece of buckskin and with Indian paint wrote his name, attached it to a stake and drove it into the ground at the highest point on the bluff, approximately where Main Street crosses the railroad tracks at the Triple Underpass. Bryan returned to his home in Arkansas and two years later, in 1841, was back to stay.

The next settlers were the Beeman brothers who settled in 1842 on White Rock Creek, about three miles from Bryan. They raised the first crop in Dallas County. Also in 1842 Thomas Keenan settled on the Elm Fork of the Trinity near what is now Farmers Branch.

In 1843 Bryan married Margaret Beeman. He built for her the log cabin which now stands on the old Courthouse lawn. The Bryans used this log cabin for one winter. In it was held the first court in Dallas, and in it was born the first white child in Dallas. While living here, Bryan laid out the town of Dallas, made the first sale of town lots, and chose the name of the city. Bryan soon built a larger cabin, and the old cabin was moved upriver and set up, several times, until it was bought by Dr. R. C. Buckner, founder of the Orphan's Home, who presented it to the city. It was set up for the fifth time where it now stands on the square, which Bryan presented to the city, 100 yards from its original site. What other city has such a personal and intimate reminder of its early days?

Dallas was laid out in the spring of 1844. A town one-half mile square was planned and platted. It extended eight blocks from West to East, from now vanished Water St. by the old course of the Trinity to Poydras St. It reached ten blocks North to South, from McKinney to Young.

Oak Cliff began as Hord's Ridge in 1845. Judge William Hord settled on a square mile which is now the business section of Oak Cliff.

In 1845, at the time of Texas' annexation to the United States, Dallas had four families, two bachelors, one store and one saloon. Farmers' Branch was larger, having a grist mill and a blacksmith. Also in the area was a settlement called

Cedar Springs, about four miles north of Dallas where the new Tollway crosses Cedar Springs Road.

In 1846 things began to break for Dallas. Bryan was granted a ferry concession by the State of Texas. Two new stores opened; the owner of one became Dallas' first postmaster. His postoffice was a rough cotton container with pockets stitched into it, into which mail was sorted alphabetically. This hung on the wall, and people looked through the pockets themselves, so the Postmaster could continue helping his customers.

Also in 1846 the first hotel opened, the first private school began, and Dallas was named temporary County Seat after much politicking by Bryan. A 16ft. x 16 ft. cabin became the first court house, erected on the square donated by Bryan. It occupied one corner so it wouldn't interfere with Bryan's corn crop which was planted there! A larger building was erected when Dallas became the permanent County seat the following year.

A little about Dallas life in these very early years -- Here is a note from a traveler from the east about an 1844 journey to Dallas. They sailed down the Missouri and Mississippi Rivers to New Orleans and then on to Galveston. From there they went overland to Houston, confident of finding a boat to bring them up the Trinity. From Houston they went by wagon to Cincinnati, Texas; from there by flatboat to Fort Alabama, and the rest of the way on horseback.

There was one sewing machine in Dallas. All store goods came by ox wagon from Houston or Jefferson. Venison cost 3 cents a pound; a saddle of deer was 40 cents. The first cabins were log, and there was no window glass available. Clothes were of handwoven cloth or buckskin. Moccasins were the usual footwear. There was a weekly newspaper. By the early '50's, room and board at the leading inn was \$12.50 to \$15.00 per month.

The grist mill at Farmers Branch attracted farmers from as far away as 100 miles. As many as twenty-five wagons might be lined up to use the mill. The first social events were the old camp meetings, and the Masonic Lodge was established early.

Popular sports were horse races, dog fights, and cock fights in the pit of the Glen Lea saloon at Main and Murphy Streets. Boxers met regularly in back of Flanagan's Saloon, located where the Wilson Building now stands.

All types of people came to early Dallas. The men and women who came to find new homes and establish a decent way of life and a reputable business climate were only a small part of the total population. They were far outnumbered by the frontier riff-raff. A compromise was established -- each group left the other alone. But when things got completely out of hand at one or another "joint" a few of the solid citizens sent an agent to burn down the offender's place of business! Quite a frontier town, weren't we?

Dallas' first capitalist was Alexander Cockrell, who came to visit a cousin in 1845 and returned to live in 1847. He observed the stimulating effect on Dallas on becoming the County seat, and decided to invest in the city. For \$7000.00 he bought Bryan's Ferry concession and what remained unsold of his original town. (Bryan, who had begun to drink heavily, then faded from the Dallas scene.) Cockrell was the first man with a vision of what Dallas could be, and he set out to make it come true.

Cockrell first concern was that if Dallas was to become the center of the region it had to be easier to reach, especially from west of the Trinity. He obtained a franchise and built a toll bridge and causeway across the river. He built a sawmill and after cutting the bridge timbers, sold building material in 1857. He built an impressive three story brick hotel, spacious, with large rooms for public functions. Cockrell died in a duel in 1858 at age 38. Don't you wonder what he might have accomplished if he had had twenty years instead of only five?

In the fifties Dallas grew. Dallas County had more towns than any other Texas county, the weekly paper boasted. Actually, we were not much ahead of these others, except that the courthouse brought people here on public business.

In 1855 the French colony arrived. This was an experiment in a cooperative community - not communistic, I hasten to add. This idea of co-op living was quite popular in Europe, but failed everywhere it was tried, including Dallas. This French Colony, called LaReunion, settled on 2000 acres at what is now Cement City on Hampton Road, and began to farm. The land was poorly chosen for agriculture, and by 1860 many colonists had left. One hundred and sixty came to Dallas. From them we acquired much of the sophistication and culture of Dallas' early years. An orchestra leader and composer brought the first piano to Dallas. Others gave music, painting and dancing lessons. Others opened bakeries, breweries, butcher shops, millinery shops. Two distinguished American naturalists, Ball and Reverchon, trace their beginnings to the French Colony, which contributed much to Dallas.

To enter its third decade, Dallas had a spectacular fire in 1860. Only one building remained standing on the square. Abolitionists were suspected. One historian described the fire as "not so spectacular, but proportionately just as inconvenient" as the Chicago fire.

In the fall, national elections were held. Lincoln won. Throughout the South during that winter ran a high tide of feeling in favor of leaving the North to form a nation of the south. Dallas people were overwhelmingly in favor of secession. When war was declared, the young men rallied to the Southern cause. Fighting never came to Dallas, but the life and economy of the town were much affected by the war, as the North managed to cut the South off from the rest of the world.

Dallas felt the war most directly in reconstruction. The gloom and demoralization which settled over the South was felt in Dallas of course, but strangely enough, almost from the close of the war, Dallas grew steadily and regained its economic health, and was the only part of Texas to do so. Primarily, this growth was farmers who felt they couldn't make a living growing cotton without slave labor, saw the great wheat growing area around Dallas, and came here to live. In the seven years after the war, Dallas gained between two and three thousand people.

The lack of adequate transportation throttled Dallas both as a seller of cotton and wheat and as a buyer of building materials and other items. In 1867, a small steamboat navigated the Trinity carrying cargo, and a group of Dallas businessmen commissioned a steamboat of their own "The Sally Haynes". She made several hauls, was finally wrecked. This dream still lives 100 years later!!

Finally the railroad reached Dallas in 1872 - the Houston & Texas Central. Dallas wasn't big enough to induce the railroad to come all the way into the town, but obtained a promise for the tracks to pass one mile east. The small station was

quite near where Baylor Hospital now is. A gala celebration, featuring buffalo steaks, was held when the first train arrived. The terminal merchants, who moved from town to town as the tracks progressed, built a new town overnight on Elm Street between Record and Griffin. More than nine hundred buildings went up to accommodate these new people and businesses. Among these firms were Sanger Brothers, Padgett Brothers and Huey & Philp.

The Texas & Pacific arrived in 1873. At the same time railroad construction was halted because of a depression and panic which swept the whole country. For three years, the terminal was at Eagle Ford, six miles west of Dallas. Both railroads made Dallas the shipping and receiving point for everything west of the City. If the panic had come a few weeks later, Ft. Worth would have received this large volume of business.

A prime example of the wheeler-dealer aspect of the Dallas personality is the story of how Dallas got the T&P. The T&P was crossing the southern part of the U.S. (following the 32nd parallel). Somewhere along its route it would cross the H&TC and this junction was bound to create a flourishing city.

Dallas leaders could see that this point would be about fifty miles south of Dallas, but with the experience gained in dealing with the H&TC, they had learned the ins and outs of the legislative directive that charted the courses of railroads. They also knew that any direct attempt to put through a law in Austin diverting the T&P would be defeated. This was their strategy: In what is now City Park, there was a group of springs known as Browder Springs. The city fathers framed a rider to the railroad bill - which the Legislature was very anxious to pass so they could go home - which included, among other things, the stipulation that the T&P pass within one mile of Browder Springs. The bill was passed, the Legislature adjourned. The T&P found this rider later, and Browder Springs meant Dallas. They were upset, to say the least, and threatened to retaliate by building one mile South. Dallas quickly voted a \$100,000.00 bond issue and granted a broad right-of-way through Dallas - what is now Pacific Avenue. The meeting of the two railroads brought on a big expansion for Dallas.

A Western atmosphere was still very much a part of Dallas in the Seventies. Herds of cattle were driven through the streets as this was a good fording spot. Cowboys left their herds to graze and came to Dallas for diversion. There was plenty of it. Gambling halls and saloons lined Main St. from Houston to Austin Sts. and the southwest part of town was given over to dance halls. Over one hundred professional gamblers headquartered here. Often cowboys raced up and down the streets, firing their guns. Dallas was also the center of the buffalo skin trade and the largest buffalo skin market in the world.

Dallas also began to become a city. A gas plant was built and gaslights installed. A streetcar line was started. An iron bridge crossed the Trinity. A water system was installed and the first telephone installed.

Unfortunately, we didn't have a city's traffic plan - in fact, the only plan was to get traffic from the west through town and out to the H & TC station in East Dallas. There was no plan for radiating, well placed streets.

The principal Dallas Streets were then, as now, Elm, Main and Commerce. They were unpaved and extended only as far as Murphy St. Ross and Bryan Streets were country lanes. John Neely Bryan had envisioned a riverfront town like Memphis or Nashville. The prime residential area was to have been between the courthouse and the Trinity. Instead, homes were built to the north, along the road

to McKinney, which joined the Preston Road and the Cedar Spring Road. This addition was known as - you guessed it -- Caruth's Addition. William Caruth had bought the area bounded by Ross, Lamar, McKinney and Orange streets and had developed it.

The future growth of Dallas was affected by physical factors which had already formed in the 1870's. The railroads, with their lines through the city and their switch yards, blocked large areas from street crossings. Natural waterways had few good crossings. Fair Park formed a barrier. Cemeteries, both North and South, blocked large areas from street crossings. Also, there was no idea that Dallas would grow as it has. A separate town called East Dallas had been formed around the Houston & T.C. Station, and also other communities had sprung up in North and South Dallas. Their streets were laid out on a different axis from Dallas'. These caused innumerable problems where the city reached them.

With the railroads came the cotton buyers. Dallas was the center of the region producing the finest Texas cotton. Lower Elm St. became a curb cotton market. The newspaper reported that in 1874 Elm St. was a snow-white sea of cotton. By 1880, when 50,000 bales were brought in Dallas, most of this was stored on the streets. Finally a cotton exchange building was built at Commerce and Lamar to get the cotton market off the streets.

The church came to Dallas almost as soon as it was founded. Dallas has always been primarily Protestant, unlike the cities founded by the Spanish. The Methodist claim the first church, followed quickly by the Baptists, Christians, and Presbyterians. The first Catholic Mass was said in 1859, the first parish founded in 1872 and Ursuline Academy started in 1874. The Episcopalians arrived in 1860, and the well known Bishop Garrett arrived in 1874. His first official duty was to conduct a funeral for a man shot in the lobby of the hotel where this dignified English Bishop was staying. Bishop Garrett founded St. Mary's College in 1889.

Terrill School for Boys was formed in 1906 and was noted for combining frontier traditions with the strict discipline and the trimmings of the Eastern prep schools. The school proved so popular that a group of parents approached Headmaster Terrill about a similar school for girls and he suggested Miss Ela Hockaday to head it. Hockaday opened in 1913 at a site on Haskell where theYWCA's Proctor Hall now stands.

Public schools? The first State appropriations were made in 1841, but this was only a token which had to be extended by private subscriptions. Schools were not open all year. Finally, a City school tax and School Board were set up in the 80's. The development of new residential areas may be traced by the building of schools. The first ones were Cumberland Hill, still standing on North Akard; Travis, on McKinney Ave. where the Administration now is; Oak Grove, across from the Lone Star Gas Building; and the Columbian School, where Dallas Memorial Auditorium is. Crozier Tech occupies a site which has been a school site for ninety-five years.

During the 1880's, residential areas were added without any overall plan. Growth followed the old wagon roads. South Dallas, out Ervay St. was the old road to the ferry. Oak Lawn straddled the roads to Cedar Springs and McKinney. Ross was the longtime high and dry road to the ranches.

In 1886, T. L. Marsalis and his associates bought 2000 acres west of the Trinity

on a beautiful bluff overgrown with oak trees. What could they name it but Oak Cliff? Marsalis began to promote it as a residential suburb and a widely advertised auction of lots was held. Sales were better than anyone had expected, and Marsalis had someone bid privately for him to buy back some lots. One of his partners in this and in a wholesale grocery business, John S. Armstrong, was shocked at what he considered very poor business. He delivered and ultimatum to Marsalis -- "take either the groceries or the real estate, we are no longer partners." Marsalis took the lots and went broke. Mr. Armstrong later developed Highland Park.

Not many buildings dating back to the Seventies and the Eighties remain. There were impressive homes - showplaces before 1900, but not one remains the home of any family, much less its original family.

Dallas got a daily newspaper in 1885, The Dallas Morning News. This was a branch of the Galveston News founded in 1842. With the staff arriving from Galveston was Geo. B. Dealey who was largely responsible for what his newspaper became.

The Times-Herald was formed by two competitors of the News and when it passed into the hands Edwin J. Kiest in 1896, quickly established itself. However, in those first uncertain months, Kiest regularly pawned his gold watch for cash to meet his payroll.

Dallasites have always loved entertainment - fairs, theater, music! Field's Opera House, a small, poorly ventilated building, opened in 1873. There was no dressing room. Actors had to dress in their rooms in the Windsor Hotel, cross a covered bridge to the Exchange Hotel, enter a back room, climb out a window, cross a roof, enter another window of the Opera House which opened on the back of the stage. The process had to be repeated for each costume change! Fortunately for the arts in Dallas, several progressively larger and better equipped theaters followed Field's.

The State Fair began in the 80's, following three decades of County Fairs, although Fair Park didn't take on its present look until the 1930's, when it was almost entirely rebuilt for the Texas Centennial of 1936.

The Dallas Public Library opened in the 80's and was the scene of the first art exhibit. In 1900 it received a grant from Andrew Carnegie for a building, which served the city for almost sixty years.

Dallas achieved its goal of a University in 1915, when SMU opened with 706 students.

Probably the only time Dallas even partially lost faith in the future was during the panic of 1893. However, the City recovered with vigor. Oak Cliff became a part of Dallas in 1903, and five years later the Houston St. viaduct, now part of the Stemmons and Thornton Freeways, was built. This was the first roadway over the Trinity to be able to stand a real flood. About this same time Dallas first skyscraper - the fifteen story Praetorian Building - went up.

In 1910 the traffic picture was terrible. There were five railway stations, one for each railway serving Dallas. All were congested and outgrown. These railroads effectively cut off both South and North Dallas from any real growth because the grade crossings were so dangerous. The Trinity effectively cut off the West, because in flood time it became a raging torrent and a real

destroyer - this was before the levees were built. Dallas had grown out Ervay, Akard and Griffin Streets, rather like a tree growing in the crevices of a rock. Ervay and Akard met and ended at Ross. St. Paul was a series of short, unconnected streets. Harwood was crooked and narrow, with no North or South outlet. There was no Highland Park, no Munger Place, and Oak Cliff ended at Tyler Street. George Kessler was engaged to study the problem. His report was brought before the Park Board in 1911. Notable among his recommendations were that the railways be diverted from City Streets by belt lines around the city and a Union Station established. The Trinity needed levees. He gave a comprehensive plan for street widening, park and playground creation, and the elimination of grade crossings. Kessler's plan is primarily responsible for Dallas as it is today, although other planners came after him.

The Dallas philosophy is unchanged. It is aggressive, choosing its objectives after shrewd estimates of the probable direction of economic and social winds. The wheeler-dealers are still here, thank goodness.

Or perhaps we should quote from the Fort Worth Democrat these words of 1872. "The first thing Dallas children are taught to speak is 'HURRAH FOR DALLAS!'"

THE TENNESSEE GENEALOGICAL SOCIETY

Post Office Box 12124
Memphis, Tennessee 38112

If you are looking for ancestors in Tennessee, remember

"ANSEARCHIN" " NEWS

The official publication of The Tennessee Genealogical Society

Annual Subscription \$6.00
Free Queries to Members

Back Issues Available
Free Table of Contents

Master Surname Index to Assist Members
Index of Surnames Listed 1969 Seminar \$1.00
Shelby County, Tennessee, Marriage Records, 1819-1850 \$9.00

CALAHAN FAMILY BIBLE RECORDS

Submitted by Mrs. Jewel Young

2003 N. O'Connor Road

Irving, Texas 75060

Copied from the Calahan Family Bible. The Bible is old, the pages brittle and yellowed with age and the ink is faded. The covers and much of Genesis is gone. The Apocrypha is found between the Old and New Testament. At the beginning of the New Testament is a page, thus:

The
New Testament
of our

Lord and Saviour Jesus Christ

translated out of

The Original Greek

and with

The former Translations Diligently Compared and Revised.

Nashville, Tennessee

Published by A. H. Redford

for the Methodist Episcopal Church, South

1870

MARRIAGES:

William F. (Franklin) Calahan was born November 13, 1841, (married)

Priscilla Trigg, was born February 22, 1846. Married January 25, 1866.

J. A. (Joe Alexander) Calahan and C. M. (Callie) Gober married Jan. 25, 1905.

Maggie (Margaret Rachel) Calahan and J. L. (Joe) Weatherly was married Jan. 25, 1885.

R. H. (Rufus Henry) Calahan and Dollie Moad was married July 29, 1894.

Albert B. (Bruce) Calahan and Elizabeth Wood were married April 24, 1908.

Zerold I. (or J.) Steen and Annie D. (Drucilla) was married June 9, 1902.

Cuvier Wood and Mabel G. (Gertrude) was married Oct. 29, 1902.

BIRTHS:

Maggie R. Calahan was born November 6, 1866.

James T. (Trigg) Calahan was born Jan. 17, 1869.

William C. (Claud) Calahan was born Jan. 5, 1871.

Rufus H. (Henry) Calahan was born May 14, 1873.

Anna Drucilla Calahan was born Dec. 18, 1875 (uncertain whether this is 13 or 18)

Joseph A. (Alexander) Calahan was born April 16, 1879

Mabel G. (Gertrude) Calahan was born November 3, 1881

Albert B. (Bruce) Calahan was born June 2, 1884.

DEATHS:

W. C. Calahan died Jan. 10, 1895, age 24 years & 5 days.

W. F. Calahan died Jan. 8, 1920

Annie D. Steen, died March 12, 1920

Jim Trigg Calahan died _____ 1942.

Priscilla Trigg Calahan died Aug. 1, 1944

Dollie Calahan died 28th February, 1955.

W. F. Calahan & Mrs. Priscilla Calahan (wife) & children, & Mrs. Calahan's mother, a widow, Mrs. Mary Trigg and her younger children came to Texas in a wagon train from Maury and Marshall Co., Tenn. in the 1870's, and settled near Euless, Tarrant Co., Texas. (The words in parenthesis are mine - Jewel Young.)

BURIALS IN WEBB CHAPEL CEMETERY

Through June, 1970

Cemetery Located on Webb Chapel Road near Farmer's Branch, Texas
Submitted by Mrs. J.W. McMillan, 823 S. Greenville, Richardson, Texas 75080

- Asbury, Adda A. July 11, 1868-May 5, 1894, Daughter of Francis Wiggins & Eliza Askin Asbury
- Asbury, Eliza Askin, Sept. 2, 1838-Jan. 30, 1890, wife of Francis W. Asbury.
- Asbury, Francis Wiggins, Apr. 26, 1833-Sept. 5, 1911, son of Nelson T. & Sabbina K. Allen Asbury.
- Asbury, John N. Dec. 19, 1866-Oct. 8, 1885, son of F.W. & Eliza A. Asbury.
- Asbury, John W. Dec. 10, 1828-July 29, 1888, possibly a cousin of F.W. Asbury
- Asbury, William P. Aug. 16, 1874-Oct. 14, 1940 son of F.W. & Eliza Askin Asbury.
- Asbury, Anna Maud Demere Sept. 29, 1884-Sept. 29, 1949 wife of Wm.P. Asbury
Daughter of Wm. Herbert & Margaret L. Dennis Demere
- Aydelotte, Anna Laura Nov. 5, 1901-Aug. 12, 1902, daughter of John H. & Hallie A. Bryan Aydelotte.
- Aydelotte, Hallie A. Bryan, Oct. 26, 1876-Nov. 15, 1901 wife of John H. Aydelotte.
Daughter of Wm. Gaston Bryan & Emma Moodie Bryan sister of Essie Bryan Redwine.
- Ball, Ben F. Oct. 17, 1836-April 12, 1933
- Ball, Mollie W. Oct. 22, 1845-Feb. 25, 1910 wife of Ben F. Ball.
- Ball, Nannie A. Oct. 15, 1874-Jan. 14, 1897, daughter of Ben F. & Mollie W. Ball.
- Ball, Little Leroy, Jan. 5, 1904-Jan. 8, 1904, son of R.J. & M.C. Ball.
- Bell, Infant, July 9, 1925-July 9, 1925, child of Ralph W. & Mamie Lynn Henry Bell.
- Bell, Robert, Feb. 4, 1929-April 22, 1931, son of Ralph W. & Mamie Lynn Henry Bell.
- Brien, Fred T. April 11, 1867-Oct. 1, 1889 worked for G.L. Ford & family.
- Brent, Robert Price Sr. Dec. 20, 1888-March 30, 1970, husband of Allie Ford Brent.
- Brown, Anderson, Jan. 17, 1884-Jan. 3, 1954 son of Dr. Robert M. & Eudora C. Brown.
- Brown, Eudora C. May 10, 1847-Jan. 17, 1884 wife of Dr. Robert M. Brown.
Daughter of James & H. N. Anderson
- Brown, Julia A.G. (Dec. 4, 1818 - Dec. 5, 1894 wife of W. P. Brown.
- Brown, W. P. Oct. 2, 1814- Feb. 13, 1901
- Brown, Dr. Robert M. Sept. 17, 1843-July 29, 1900 son of W.P. & Julia A.G. Brown.
- Bryan, Emma Moodie, May 9, 1847-Dec. 21, 1880, wife of William Gaston Bryan.
Daughter of Francis W. & Louisa S. Moodie.
- Bryan, Thomas Ingram May 7, 1870-May 3, 1912 son of Wm.G. & Emma Moodie Bryan
- Bryan, William Gaston, Jan. 17, 1834-April 10, 1920, husband of Emma Moodie Bryan
Father of Essie Bryan Redwine
- Burton, Walter Pryor, March 26, 1906-Nov. 25, 1966 husband of Rhena Merle Cox Burton.
- Butler, Callied, Feb. 10, 1882-Dec. 16, 1882, daughter of J.F. & E.S. Butler.
- Chambers, Elisha Dec. 26, 1889 - 1961.
- Chambers, Ermine Harbin March 18, 1892 - 1929 wife of Elisha Chambers.

Connell, Nanelle Ogden, 1898-1959, wife of Robert O. Connell., daughter of Jack T. & Nellie Smith Ogden.

Cox, Allie May, July 28, 1873-Oct. 24, 1937, wife of Marion W. Cox.

Daughter of J. B. & Sarah Thompson May

Cox, Allen Howard, Jan. 9, 1864-Jan. 9, 1864, son of Howard & Mary Jane Webb Cox

Cox, Franklin Nov. 25, 1845-1862, son of Joseph H. & Margaret Cox

Cox, Howard Dec. 6, 1837-April 1, 1916, husband of Mary Jane Webb Cox.,

son of Joseph H. & Margaret Nolen Cox

Cox, Isaac Howard, Sept. 9, 1882-Jan. 4, 1968, husband of Mary Eleanora Harry Cox

son of Howard & Mary Jane Webb Cox

Cox, Helen Howard, June 13, 1901-June 13, 1901, daughter of Thomas J. & Sallie

Burney Cox

Cox, John Thomas Feb. 12, 1962-Feb. 24, 1962, son of Howard Joe & Mary Katherine

Fisher Cox

Cox, Joseph H. Sr. 1796-1860, husband of Margaret Nolen Cox

Cox, Joseph H. Jr. Aug. 8, 1835-Aug. 24, 1903 husband of Susan Cox.

son of Joseph H. Sr. & Margaret Nolen Cox

Cox, Margaret Frances Oct. 6, 1871-1941, Daughter of Howard & Mary Jane Webb Cox

Cox, Margaret Nolen March 15, 1812-1875, wife of Joseph H. Cox Sr.

Cox, Marion Whitfield, Oct. 4, 1865-Oct. 8, 1931 Husband of Allie May Cox, son

of Howard & Mary Jane Webb Cox

Cox, Martha Elizabeth Aug. 15, 1878-April 16, 1963, daughter of Howard & Mary

Jane Webb Cox

Cox, Mary Eleanora Harry Nov. 20, 1889-June 13, 1959 wife of Isaac Howard Cox

Daughter of

Cox, Mary Jane Webb Nov. 26, 1843-June 27, 1913 wife of Howard Cox

Daughter of I.B. & Mary Hughes Webb

Cox, Sallie M. Burney, March 12, 1874-July 13, 1901, wife of Thomas J. Cox

Cox, Thomas J. Nov. 12, 1848-May 15, 1905 son of Joseph H. & Margaret Nolen Cox

Cox, Willie Clyde July 22, 1891-July 26, 1910 son of Marion Whitfield &

Allie May Cox

Cox, Walter April 18, 1883 - May 10, 1884 son of Justin C. & Retta V. Smith Cox

Dafft, Joseph E. Nov. 8, 1870-May 4, 1935 (taught school at Farmers Branch)

Dafft, (mother) Annie (Reid), Jan. 25, 1889-June 8, 1962 wife of Joseph E. Dafft.

Demere, Arthur Oct. 25, 1877-July 27, 1879 son of Wm. Herbert & Margaret Letitia

Dennis Demere

Demere, Charlie Ford July 1896 - Infant son of Wm. H. & Margaret L. Dennis

Demere

Demere, Maggie Dennis (Margaret Letitia) Oct. 17, 1860-Oct. 29, 1898 wife of

Wm. Herbert Demere, daughter of Andrew Jackson & Sarah A. Webb Dennis

Demere, Elbert, Oct. 1898, Son of Wm. Herbert & Maggie Dennis Demere

Demere, Infant (no name) 1883 - Son of Wm. Herbert & Maggie Dennis Demere

Dennis, Infant (Alice or Alsey) 1882 daughter of A.J. & Sarah A. Webb Dennis

Dennis, Andrew Jackson Feb. 17, 1833-April 14, 1901 son of James Dennis &

Farmina Gunnels Dennis, husband of Sarah Almira Webb Dennis

Dennis, Bessie Sept. 23, 1894-Oct. 7, 1894, daughter of J.C. & M.J. Dennis

Dennis, Bessie Allen Asbury Aug. 6, 1872-April 30, 1955 wife of George

Newton Dennis, daughter of F.W. & Eliza Askin Asbury

Dennis, Callie S. July 19, 1887-Oct. 19, 1888, daughter of M. L. & M.A. Dennis

Dennis, Charles Henry Stephenson Jan. 7, 1893-Sept. 12, 1898, son of M. L.

& M. A. Dennis

Dennis, Daniel P. Nov. 11, 1836-Jan. 13, 1887 son of James Dennis & Parmina
Gunnels Dennis, brother of A. J. Dennis
Dennis, George Newton Dec. 28, 1869-April 19, 1929, husband of Bessie Asbury
Dennis, son of A. J. & Sarah A. Webb Dennis
Dennis, Gerald Allen Dec. 4, 1897-June 25, 1899, son of George N. & Bessie
Allen Asbury Dennis
Dennis, James Isaac March 30, 1862-March 23, 1948, husband of (1) Katherine
Meason Dennis, (2) Angie Pistole Dennis, son of A.J. & Sarah A. Webb Dennis
Dennis, John Aug. 18, 1870-Nov. 12, 1870 son of A.J. & Sarah A. Webb Dennis
Dennis, John S. Feb. 4, 1843-June 21, 1899, son of John M. & Julia A. Taylor
Dennis
Dennis, Julia A. Taylor March 14, 1816-July 2, 1885 wife of John M. Dennis
Dennis, Levi William Feb. 1864-Sept. 1897 son of A.J. & Sarah Webb Dennis,
husband of Nancy Zemora Roberts, father of Jewell Dennis Timmons
Dennis, Mary Hughes Oct. 22, 1878-July 18, 1900 daughter of A.J. & Sarah Webb
Dennis
Dennis, Nancy J. March 20, 1881-March 26, 1881, daughter of M.L. & M.A. Dennis
Dennis, Sarah Almira Webb, July 2, 1841-Feb. 23, 1928, wife of Andrew Jackson
Dennis, daughter of Isaac B. Webb & Mary Hughes Webb
Dennis, Sarah P. 1880-Nov. 1, 1880, daughter of A.J. & Sarah Webb Dennis
Dennis, William B. Dec. 4, 1847-March 4, 1907, son of John M. & Julia Taylor
Dennis, first husband of Matilda Dennis (Jordan)
Dennis, Willie H. Dec. 27, 1895-June 1, 1897 son of J.S. & L.F. Dennis

Dooly, Alpha Sept. 17, 1880-July 10, 1963, daughter of M.D. & Elizabeth Dooly
Dooly, Elizabeth Oct. 10, 1850-May 31, 1930, wife of M. C. Dooly
Dooly, Helen Aug. 9, 1882-Oct. 19, 1882 daughter of M.C. & Elizabeth Dooly
Dooly, Homer Aug. 29, 1883-Sept. 6, 1963, son of M.C. & Elizabeth Dooly
Dooly, Hope Aug. 29, 1883-Nov. 26, 1883, son of M.C. & Elizabeth Dooly
Dooly, M.C. Jan. 23, 1852-May 19, 1920, husband of Elizabeth Dooly
Dooly, Willie I. Nov. 20, 1885-June 27, 1887 son of M.C. & Elizabeth Dooly

Dunivin, Lizzia D. Nov. 7, 1883-Dec. 7, 1883, daughter of J. Dunivin & Frances
E. Webb Dunivin. Lizzia's mother's first husband was Isaac Newton Webb

Eaton, Luther Dishman, March 18, 1886-Oct. 31, 1886, son of R.W. & Mary Eaton
Eaton, Sarah Bell April 20, 1888-Feb. 6, 1890, daughter of R.W. & Mary Eaton

Ferguson, Guy Sept. 26, 1897-Sept. 26, 1897, son of P.M. & Ida A. Ferguson
Ferguson, Ida A. May 23, 1869-Oct. 2, 1897, second wife of P.M. Ferguson
Ferguson, Sarah F. July 23, 1856-June 10, 1895 first wife of P.M. Ferguson
headstone states that she was a member of the Methodist church for 25 years.

Ford, Evelyn Floy Feb. 21, 1918-1940, daughter of Howard M. & Ella Smith Ford
Ford, Gerald Louis June 29, 1844-Feb. 9, 1916 husband of Sophronia Frances
Webb Ford

Ford, Howard Manard Nov. 5, 1877-1938 husband of Ella Smith Ford, son of Gerald
L. & Sophronia F. Webb Ford

Ford, Nannie Hughes Dec. 28, 1879-Aug. 3, 1883 daughter of G.L. & Sophronia
F. Webb Ford

Ford, Phyllis Ann 1942-1943, daughter of Manard L. & Emma Henry Ford
Ford, Margaret Sophronia Frances Webb Aug. 23, 1852-June 5, 1932 wife of
Gerald Louis Ford, daughter of Isaac B. & Mary Hughes Webb
Ford, Ella (Mrs. H.M.) wife Howard Ford, b. d. July 23, 1970

Gilbert, Julia A. July 4, 1836-Feb. 15, 1881 wife of Dr. S. H. Gilbert
Gilbert, Dr. S. H. May 19, 1828-May 14, 1890

Gillespie, Dr. Charles C. Aug. 21, 1822-Oct. 12, 1887
 Gillespie, Helena West, Jan. 17, 1841-June 9, 1882, wife of Dr. C.C. Gillespie
 Daughter of Robert G. & Mary Ann West- on headstone she was Corresponding
 Secretary of the Womans Missionary Society of the North Texas Conference
 of the Methodist Church

Gravely, Alvin Will June 6, 1883-Oct. 1951, husband of Maggie May Taliaferro
 Gravely son of John Gravely
 Gravley, Ella 1861-1895. first wife of Joseph Benjamin Gravley
 Gravley, Joseph Benjamin June 15, 1859-June 5, 1934 son of
 husband of (1) Ella (2) Zuleika Dennis Gravley.
 Gravley, Lillie L. March 11, 1890-Feb. 26, 1899 Daughter of Barney A. &
 C.A. Gravley
 Gravley, Zuleika' Dennis July 30, 1866-Dec. 12, 1957 second wife of J.Ben Gravley
 Daughter of Andrew J. & Sarah A. Webb Dennis

Hardin, John 1847-Sept. 25, 1934
 Hardin, John T. June 8, 1883-April 1, 1952

Harmon, Rosa (Rose Marie) May 18, 1877-Aug. 29, 1956

Henry, Abner J. Feb. 11, 1875-Nov. 26, 1969
 Henry, Lizzie Ball, Aug. 23, 1877-April 20, 1946 wife of Abner J. Henry
 daughter of Benf. & Mollie W. Ball

Horton, Sallie T. 1824-1908 mother of Nancy Jane Smith

Johnston, Infant (Annie) daughter of John A. Hannah Longmire Johnston

Jones, Martha Oct. 9, 1921- May 7, 1950

Jordan, Matilda March 4, 1867-May 12, 1945 her first husband was Wm.E. Dennis
 her second husband was Sam T. Jordan
 Jordan, Sam T. Dec. 24, 1869-Nov. 17, 1933

Kennedy, Bell, Feb. 7, 1861-Dec. 5, 1863 daughter of J. M. & C. Kennedy
 Kennedy, C. wife of James M. Kennedy
 Kennedy, James M. March 17, 1829-Dec. 14, 1900
 Kennedy, Prudence Row Jan. 15, 1836-Sept. 29, 1855
 Kennedy, Warren B. Aug. 16, 1859-Oct. 28, 1860 son of James M. & C. Kennedy

Kirby, John D. Dec. 21, 1903-April 12, 1957 husband of Janice Ford Kirby

Lathem, Minnie A. Aug. 28, 1891-Dec. 6, 1918 Wife of R. S. Lathem
 Lathem, Robert Sidney Jan. 26, 1881-Jan. 8, 1962.

Longmire, Charles April 27, 1814-Aug. 10, 1883
 Longmire, C. C.
 Longmire, J. H.
 Longmire, Mary C. Feb. 16, 1856-July 21, 1905 wife of W. A. Longmire
 Longmire, Mary J. March 7, 1847-March 25, 1871
 Longmire, W. A. July 7, 1849- Feb. 4, 1918

Moodie, Louisa S. May 3, 1819-May 18, 1895, wife of Dr. Francis W. Moodie
 Their daughter, Miss Lou, taught at the Marsh School. Miss Lou was an aunt
 of Essie Bryan Redwine (Miss Lou was Ladye Dennis Hall's first teacher).

Meyers, Belle Sept. 8, 1868-July 17, 1901 second wife of George Franklin Meyers
Meyers, Ella P. Kennedy Mar. 3, 1866-Feb. 4, 1890 first wife of George Franklin
Meyers, daughter of James M. Kennedy
Meyers, George Franklin 1855-1937 husband of Ella Kennedy Meyers & Belle Myers
Meyers, Infant June 20, 1901-June 20, 1901, daughter of George F. & Belle Meyers
Meyers, John Evans June 19, 1897-Sept. 25, 1898 son of George F. & Belle Meyers

Nelson, Flora B. Feb. 17, 1907-April 29, 1934 wife of Enoch Nelson, daughter
of Dan Braggs

Newton, Infant Dec. 3, 1904-Dec. 3, 1904 child of Oscar & Alma Smith Newton

Noell, Michael, June 10, 1959-June 10, 1959, son of Charles & Ammye Noell
Noell, Ralph E. May 12, 1958-May 12, 1958, son of Charles & Ammye Noell
Noell, Infant June 23, 1960-June 23, 1960 son of Charles & Ammye Noell
Noell, Glenda Louise Sept. 22, 1934-Nov. 11, 1935 daughter of Ralph L. &
Nannie Henry Noell
Noell, Nannie Henry June 20, 1900-Dec. 2, 1958 wife of Ralph L. Noell
Daughter of Abner J. & Lizzie Ball Henry
Noell, Ralph L. 1892-1934

Northcut, Infant April 26, 1899-April 26, 1899 son of W.A. & F.M. Northcut

Ogden, Henry Othole Dec. 28, 1890-Mar. 16, 1962 son of Jack T. & Nellie
Smith Ogden
Ogden, Hudson D. 1907-1940 son of Jack T. & Nellie Smith Ogden
Ogden, Jack T. 1857-1925 husband of Nellie Smith Ogden
Ogden, Jack T. Jr. 1910-1912 son of Jack T. & Nellie Smith Ogden
Ogden, James W. June 27, 1903-April 13, 1953
Ogden, Jessie M. July 25, 1907
Ogden, Nellie Smith 1873-1938 wife of Jack T. Ogden, daughter of P.C. &
Nancy Jane Smith
Ogden, P. Raymond 1892-1941
Ogden, Paulita 1914-1914
Ogden, Sallie Sue 1930-1930

Perry, Amanda Cox Jan. 24, 1852-March 23, 1889 wife of W. F. Perry
daughter of Joseph H. & Margaret Nolen Cox
Perry, Susan F. Dec. 12, 1858-Sept. 29, 1889 wife of W. M. Perry
Perry, W. F. Dec. 6, 1843-July 29, 1905

Pruitt, Mary Ann Oct. 3, 1825-July 28, 1910 mother of Mrs. Ben Ball

Rickett, Enloe - no dates

Rosen, E. E. Oct. 9, 1913-Sept. 13, 1933
Rosen, H. G. Aug. 13, 1862-April 2, 1935

Russell, Rosina Cox July 30, 1878-May 25, 1954 wife of D. A. Russell
Daughter of Joseph H. & Susan Cox

Salmon, Little Tom Feb. 28, 1900-April 14, 1901, daughter of Dr. & Mrs.
R. H. Salmon

Scheideker, Alfred G. Feb. 19, 1853-April 11, 1922 friend of Warren Taliaferro
and family.

Slaughter, H.J. Jan. 8, 1841-Oct. 8, 1882

Smith, Annie A. Cox April 12, 1869-Jan. 25, 1894 wife of Clyde Smith,
 Daughter of Howard & Mary Jane Webb Cox

Smith, Clarence Oct. 20, 1879-May 9, 1882 son of P.C. and Nancy Jane Horton Smith

Smith, George Henry March 23, 1898-Feb. 6, 1899, son of W.D. & A.B. Smith

Smith, Jim E. July 31, 1869-Feb. 16, 1941 son of P.C. & Nancy J.Horton Smith

Smith, Nancy Jane Horton 1851-1930, wife of P.C Smith

Smith, P. C. Oct. 30, 1847-April 29, 1885

Smith, Preston C. Aug. 13, 1883-Jan. 8. 1917 son of P.C. & Nancy Jane Smith

Taliaferro, Ann Webb Apr. 8, 1849-July 12, 1929 wife of Warren Taliaferro
 daughter of Isaac B. & Mary Hughes Webb

Taliaferro, Eva M. Draper Dec. 1, 1876-Feb. 4, 1968 second wife of Herbert W.
 Taliaferro

Taliaferro, Herbert Warren Sept. 21, 1878-May 28, 1962 son of Warren & Ann Webb
 Taliaferro

Taliaferro, Jefferson Blackman June 4, 1876-Mar. 30, 1884 son of Warren &
 Ann Webb Taliaferro

Taliaferro, Lecate Stalcup 1885-1910, first wife of Herbert W. Taliaferro

Taliaferro, Mary Ruth March 3, 1883-July 19, 1884 Daughter of Warren & Ann
 Webb Taliaferro

Taliaferro, Newton Webb Aug. 4, 1880-Nov. 3, 1902 son of Warren & Ann Webb
 Taliaferro

Taliaferro, Warren Feb. 17, 1843-June 15, 1929 husband of Nancy Ann Mariah Webb
 Taliaferro

Taliaferro, Wilruth 1908-1909 Daughter of Herbert W. & Lecate Taliaferro

Talley, Robert Sutton May 13, 1908-May 18, 1919 Son of Swain & Jessie Demere
 Talley

Taylor, Drover C. Oct. 23, 1886-Sept. 11, 1887 son of J.L. & L.C. Taylor

Thedford, Mamie Sales Rosen, Aug. 17, 1877-Nov. 25, 1969

Thomas, Benjamin Price Jan. 6, 1820-Apr. 16, 1865

Thomas, Mary Will May 26, 1848-Jan. 6, 1865, Daughter of B.P. & Sarah F. Thomas

Thomas, Sarah Frances Feb. 23, 1822-Feb. 12, 1901

Thurlow, Barbara Nell, June 1, 1933-June 2, 1933 daughter of T. L. & Alma Lois
 Ford Thurlow

Thurlow, Thomas Lawson May 29, 1905-June 19, 1944 husband of Alma Lois Ford
 Thurlow

Vann, Elmer Dec. 18, 1902-May 12, 1904 son of D.E. & E.W.S. Vann

Warren, Joseph Cox 1939 - son of Farrell & Dorothy Joe Cox Warren

Warren, Walter Scott Sept. 8, 1937-Feb. 18, 1965 son of Farrell & Dorothy
 Joe Cox Warren

Watterman, Elizabeth Cox Feb. 26, 1833-1858 daughter of Joseph H. & Margaret
 Nolen Cox

Webb, Alice E. July 8, 1839-Jan. 27, 1847 daughter of Isaac B. & Mary Hughes
 Webb.

Webb, George Hallena Feb. 4, 1878-Dec. 3, 1878, daughter of Joshua Whitfield & Sarah C. Dennis Webb

Webb, Ida Will March 26, 1880-Feb. 3, 1902, daughter of Joshua W. & Sarah Catherine Dennis Webb

Webb, Isaac Blackman June 4, 1802-Nov. 13, 1880, husband of Mary Hughes Webb
 Founder of Webb Chapel Methodist Church

Webb, Isaac Newton July 1, 1846-1878 son of Isaac B. & Mary Hughes Webb
 husband of Frances (Fannie) who later married a Mr. Dunivin

Webb, Isaac Whitfield, son of Wm. Douglas & Olevia Merrell Webb

Webb, John Blackman Dec. 14, 1873-Dec. 17, 1873 son of Joshua W. & Sarah Catherine Dennis Webb

Webb, John Edward, son of Wm. Douglas & Olevia Merrell Webb

Webb, Julia Ann Nov. 6, 1872-Feb. 6, 1873, daughter of Joshua W. & Sarah C. Dennis Webb

Webb, Mary Hughes, Feb. 10, 1816-Sept. 20, 1887, wife of Isaac Blackman Webb
 daughter of Wm. Hughes & Alcey Carr Hughes

Webb, Mary N. Oct. 30, 1878-Nov. 11, 1878 daughter of Isaac Newton & Fannie E. Donald Webb

Webb, Olevia Merrell Oct. 1, 1838-June 25, 1894 wife of Wm. Douglas Webb

Webb, Samuel H. May 30, 1854-Dec. 4, 1880, son of Isaac B. & Mary Hughes Webb

Webb, Wm. Cornelius, son of Wm. Douglas & Olevia Merrell Webb

Webb, Wm. Douglas Feb. 23, 1836-June 21, 1925 husband of Olevia Merrell Webb
 son of Isaac B. & Mary Hughes Webb

West, Ann Rebecca, daughter of Robert Jentry & Mary Ann West

West, Cora

West, Eula Oct. 19, 1867-May 28, 1906, daughter of John R. & Emma West

West, Gussie Jan. 15, 1869-Jan. 26-1896, daughter of John R. & Emma West

West, John R. 1842-1913

West, Mary Ann 1814-1850 wife of Robert J. West

West, Robert J. 1812-1879

West, Ryland, son of Robert J. & Mary Ann West

West, Swift, son of Robert J. & Mary Ann West

West, Emma R. Winn, wife of John R. West

Wilroy, Wm. Stanley, Feb. 12, 1896-June 29, 1966, husband of Annie Marion Cox
 Wilroy

Winn, Ann R. Dec. 26, 1843-March 9, 1874 wife of Wm. McKendree Winn

Winn, Francis Asbury 1814-1878

Winn, Mary Ann 1869-1962

Winn, Walter 1864-1899 son of Wm. McKendree & Ann R. Winn

Winn, Wm. McKendree 1839-1912 husband of Ann R. Winn, son of Francis Asbury Winn

ANNUAL BOOK AWARD

Presented each year by the Local History & Genealogical Society, Dallas, Texas.
 The Annual Award for best Book will be presented at the Annual Workshop in May,
 1971. Please submit your entries to:

Mrs. Lucile Boykin, Head, Texas History & Genealogy Department
 Dallas Public Library
 1954 Commerce Street, Dallas, Texas 75201

DEADLINE for submitting Book or Manuscript - APRIL 1, 1971

LOGAN-CHAMBERS BIBLE & FAMILY RECORDS
Submitted by Mrs. Juanita Moore
1123 Elmdale Place, Dallas, Texas 75224

FAMILY OF MATTHEW LOGAN

Matthew Logan, b. Nov. 5, 1772 Va., d. Nov. 11, 1820 in Clark Co. Ark.
m. Dec. 29, 1801, Missouri, Elizabeth Chambers (dau. of Jacob and Catherine)
b. May 20, 1785, d. Oct. 15, 1856. She married George Overbaugh on May 6,
1830 - by Isaac Ward (J.P.) Clark Co. Courthouse, Arkansas

THEIR CHILDREN

James Logan, b. Aug. 2, 1802, d. Aug. 20, 1806.
Eleanor Logan, b. April 24, 1804, d. Sept. 20, 1806
John Clark Logan, b. July 25, 1805, d. Nov. 13, 1865; m. Dec. 25, 1826
Dorcas Crow, b. Sept. 19, 1805, d. Nov. 15, 1880
William W. Logan, b. Aug. 4, 1807, d. May 25, 1838, m. Jan. 30, 1831
Eliza Wingfield Denton
Benjamin Chambers Logan, b. March 20, 1809, Wayne Co., Mo., d. May 9, 1888 at
Dobyville, Ark. m. Jan. 30, 1834 Sarah Ann Hillman Chambless, b. Sept. 28,
1815 in New Jersey, d. Jan. 24, 1885, Dobyville, Ark. Both are buried at
Carolina Cemetery, near Okolona, Clark Co. Arkansas.
Catherine Logan, b. Sept. 8, 1811, d. Sept. 10, 1815
Elizabeth Logan, b. Jan. 7, 1813, d. April 30, 1847 m. Dec. 2, 1830
Abraham Wells b. d.
Jacob W. Logan, b. Aug. 21, 1814, d. April 20, 1883, m. (1) Martha Pettit;
(2) Mrs. Elizabeth Phillips
Anselm Hamilton Logan, b. March 10, 1818 m. Lydia
Mary Logan, b. Oct. 12, 1820 d. married Gates

Bible and Family Records of Matthew and Elizabeth Logan furnished me by
Mrs. Sam O. Logan and Mrs. David Tudor.

Benjamin Chambers Logan and wife Sarah Ann Hillman Chambless
(1809-1888) (1815-1885)
Clark Co. Ark. THEIR CHILDREN

Elizabeth Jane Logan, b. Nov. 28, 1834 d. married Wingfield (Winfield).
William Franklin Logan b. Jan. 20, 1837, d. 1890, m. Jan. 20, 1859
Nancy P. Wingfield b.
Nancy Katherine Logan, b. Dec. 8, 1838, d. Feb. 12, 1908 m. Mar. 14, 1867
Okolona, Jasper Harwell, b. Jan. 25, 1831, d. Dec. 13, 1919
James McLain Logan, b. Nov. 8, 1840 d.
John Clark Logan, b. Jan. 6, 1843, d. Jan. 9, 1882 m. 1867 Fannie Rose b. d.
Thomas Jefferson Logan, b. Nov. 23, 1844, d. m. Cynthia Beard b. d.
Jacob Chamberlain Logan, b. Aug. 17, 1847, d. Aug. 6, 1909, buried at the Academy
Cem. near Nathan, Ark. m. Dec. 3, 1874 Margaret Elizabeth Dickey b. 1844 d.
Feb. 28, 1904 - buried March 2, 1904 at Beard's Chapel - near Emmet, Ark.
Sarah Ann Logan, b. Dec. 20, 1849, d. June 23, 1927, m. Dec. 26, 1868 William B.
Lawley, b. Oct. 22, 1843 (Birmingham, Ala.), d. Feb. 8, 1922 (Weleeka, Okla.)
Mary Ellen Logan, b. Dec. 15, 1851 d.
Benjamin Hamilton Logan, b. Mar. 16, 1854 d. May 31, 1925 (Prescott, Ark.)
m. Oct. 1, 1879 Julia Baird Orr, b. Aug. 22, 1858 (Centerpoint, Ark.) d. Feb.
29, 1940 (Prescott, Ark.)
Absalom Fletcher Logan b. Jan. 17, 1856 d. after 1928-9 m. July 26, 1877-Prescott
Clara Tyree b. Aug. 10, 1859 d. March 10, 1919
Martha Logan b. 1862 d. (listed in 1870 census)

BENJAMIN C. LOGAN, who was born March 20, 1809, moved to Arkansas in 1818, died May 9, 1888.

Bro. Logan, when young, joined the C. P. Church but after marrying, became a member of M. E. Church South and remained an honored member of the same for 54 years, or until the end of his life.

The writer formed his acquaintance in Dec. 1885 a few months after the death of his beloved companion with whom he had lived half a century and more. From old age and bodily afflictions he has been confined almost entirely to the house for several years. He frequently spoke to the writer about the loneliness of his life since the death of his wife. He looked forward with anxiety and anticipation of great joy when God would call him to rejoin the dear wife and other loved ones. He seemed anxious to go, but was willing to wait and suffer the will of God.

It was a means of grace to see his patience and resignation to the Divine will and to talk with him about the glorious realities and prospects of the future. The dear old brother has entered upon these realities and it is easy for us to imagine the glorious greetings that were awaiting him on the other side.

Many friends were present at the funeral services which were held in the afternoon after his death, at CAROLINE Presbyterian Church; and we laid him away in the adjoining cemetery to await the general resurrection.

We think of his life here only with pleasure. His children have his good name as their inheritance, and "Oh! what a precious heritage; more to be desired than silver and gold."

My dear brethren and sisters, I gladly and confidentially commend you to the God of your father for grace and consolation. Thank God Heaven is growing brighter and more attractive. God help us to get there where we will meet wife and baby, Mother and Father and all the good and glorified.

The inscription on his tombstone reads:

BENJAMIN C. LOGAN
born March 20, 1809
died May 8, 1888

"And I heard a voice from Heaven saying unto me--
Write-- Blessed are the dead which die in the Lord
from henceforth, yea; saith the Spirit, that they may
rest from their labors; and their works do follow them."

Rev. 14:13

SARAH H. LOGAN

SARAH H. LOGAN, wife of Benjamin C. Logan, departed this life Jan. 24, 1885. Sister Logan was a native of New Jersey. She had lived in Arkansas since 1828. In her 17th year she professed religion and joined the Church and lived a consistent Christian until called away to the Church Triumphant. In 1844-45 her home was one of my stopping places. Many times the writer enjoyed the hospitality of that Christian home. She and her husband succeeded in raising their children in great respectability.

They had been citizens of Clark County for 60 years. The wife has closed up a well rounded life and has left her aged companion to battle alone. It will not be long until a reunion will take place in that bright world where there will be no more parting.

Sister Logan was called away suddenly. She was preparing on Saturday for Sunday. Her husband hearing an unusual noise went to the cook-room door and discovered that she had fallen and was dead. She ceased at once to work and live. Bro. A. B. WINFIELD preached her funeral to a large concourse of citizens, called together out of respect to her memory.
"No sorrow, not as those who have no hope."

A. HUNTER
Feb. 5, 1885

FAMILY OF JACOB CHAMBERLAIN LOGAN

JACOB CHAMBERLAIN LOGAN, b. Aug. 17, 1847 Clark Co. Ark, d. Aug. 6, 1909
m. Dec. 3, 1874, Hope, Ark. Margaret Elizabeth Dickey, b. 1844, Tenn. d.
Feb. 28, 1904 - buried at Beard's Chapel - near Emmet, Ark.

CHILDREN

1. Margaret Jane Logan, b. Oct. 10, 1875, d. Dec. 11, 1921 (no issue) m. Sept. 1913 Plez Cornish
2. Benjamin Franklin Logan, b. Oct. 9, 1877, d. Mar. 1936, Valiant, Okla.
m. Dec. 11, 1901 Clemmie McBryde, b. April 14, 1882 d.
3. Sarah Elizabeth (Sallie) Logan b. Dec. 5, 1878, d. May 6, 1932 (bur. Restland)
m. Jan. 6, 1898 Edward Ezra Ellis (son of Asa Charles Ellis) b. July 25,
1874 (Warren, Ark.), d. Nov. 23, 1961 (Bur. Restland, Dallas)
4. William Henry Logan, b. July 21, 1880 d. Dec. 20, 1953, Huckaby, Tex.
m. Dec. 14, 1911 Eliza Little, b. Dec. 16, 1888 d. lives at Stephenville,
Texas (1970).
5. Thomas Edward Logan b. Dec. 19, 1885, d. Mar. 19, 1953 Hope, Ark. m. Dec.
23, 1908 Annie Edna Gilbert b. May 11, 1891 d. June 24, 1965.

The above Sarah E. Logan and E. E. Ellis were my parents.

JAMES LOGAN

b.
d.
m.

MARY McLAIN (McLEAN)

b.
d.

They were parents of:

MATTHEW LOGAN who married

b. Nov. 5, 1772 Dec. 29th
d. Nov. 27, 1820 1801

JACOB CHAMBERS

b. Jan. 6, 1759
d. May 10, 1819 age 29 yrs 4 mos
m. Nov. 25, 1783

CATHERINE CLARK (Katharine)

b. April 24, 1763
d. June 4, 1849 - aged 86 yrs 1 mo 10 days

They were parents of:

ELIZABETH CHAMBERS

b. May 2, 1785
d. Oct. 16, 1856 age 71 yrs. 5 mos. 14 days

"Earliest Missouri Records" (Louisiana) contains marriages of non-Catholics living in District of St. Genevieve. Sept. 26, 1796 to 1812.

Ref. Genealogical Society Quarterly: V. 11, 23

Copied by Frances J. Baldwin - Genealogist Nov. 1953

1801, Dec. 30

pages 67, 68

LOGAN, MATTHEW, son of JAMES LOGAN and MARY McLEAN (McLAIN) native of Virginia, of the Presbyterian faith to:
CHAMBERS, ELIZABETH, daughter of JACOB CHAMBERS and CATHERINE CLARK, native of Pennsylvania, of the Catholic religion.

Married at "Mine A Breton" at the home of Moses Austin.
MAXWELL Cure

Witnesses: M. AUSTIN
Michael QUINN
MOSES BATES
JACOB CHAMBERS

Elizabeth Chambers was the only child of Jacob and Catherine Chambers Matthew Logan with his wife, five children and his wife's parents joined a caravan over a mile long, destined for Arkansas in 1817. They spent a year at Magnet Cove. Early in 1819 they moved down the Caddo river near the old Military Road Crossing. While there their horses were either stolen or ran away. Jacob Chambers and his oldest grandson, John C. Logan, a lad of 13 years went back to Magnet Cove in search of the horses. Failing to find them, they endeavored to return home by waters of Ouachita and Caddo rivers. They ran into a swift current where the two rivers converge and their boat capsized and there on May 10, 1819, the grandfather, Jacob Chambers, was drowned. The grandson swam ashore and carried the sad news home. The body was recovered and buried on the West side of the Ouachita River.

Matthew Logan served as sheriff at the first court in Clark Co. Ark. (This data supplied by Rev. George W. Logan, son of John Clark Logan.) Matthew Logan was appointed Coroner of Clark County. He died in 1820, leaving wife and 7 children. Elizabeth later married again on May 6, 1830 to George Overbaugh.

CHAMBERS FAMILY BIBLE RECORDS

(copied from the photostat of the Bible)

MARRIAGES:

JACOB CHAMBERS and CATHERINE CLARK
was married Nov. the 25th ANO 1783

JOHN C. LOGAN and DORCAS CROW was married
December the 25th A.D. 1826

MATTHEW LOGAN and ELIZABETH CHAMBERS
was married Dec. the 29th Ano 1801

ABRAHAM WELLS and ELIZABETH LOGAN was
married on the 2nd day of Dec. A.D. 1830

BENJAMIN C. LOGAN and SARAH CHAMBLESS
was married Jan. the 30th A.D. 1834

WILLIAM LOGAN and ELIZA DENTON was married
Jan. the 30th A.D. 1831

ELIZABETH OVERBAUGH made her First
Communion May 7th, 1847

GEORGE OVERBAUGH and ELIZABETH LOGAN
was married May 6, 1830

FRANCIS DONOHOE, Pastor

CHAMBERS FAMILY BIBLE RECORDS

BIRTHS:

JACOB CHAMBERS was born Jan. the
Sixth Ano 1759

WILLIAM W. LOGAN was born August the
fourth Ano 1807

CATHERINE CLARK was born April the
Twenty-fourth Ano 1763

BENJAMIN C. LOGAN was born March the
Twentieth Ano 1809

MATTHEW LOGAN was born Nov. the
fifth Ano 1772

CATHERINE LOGAN was born September the
Eighth Ano 1811

ELIZABETH CHAMBERS was born May
2nd Ano 1785

JAMES LOGAN was born August the
second Ano 1802

ELENER LOGAN was born April the
twenty fourth Ano 1804

JOHN CLARK was born July the Twenty
fifth Ano 1805

MARY LOGAN was born Oct. the
12th Ano 1820

ADAM _____ was born December A.D.
1828.

ELIZABETH LOGAN was born January
the Seventeenth Ano 1813

JACOB W. LOGAN was born August the
Twenty first Ano 1814

ANLEM HAMILTON LOGAN was born March the
tenth Ano 1818

SARAH H. CHAMBLESS was born September
the 28th 1815

WILLIAM C. LOGAN was born Oct. the
twenty fifth A.D. 1827

CHAMBERS FAMILY BIBLE RECORDS

DEATHS:

JAMES LOGAN died August the
20th Ano 1806

ELENER LOGAN died SEPTEMBER the
20th 1806

CATHERINE LOGAN died SEPTEMBER
the 10th Ano 1815

JACOB CHAMBERS died the tenth
day of May Ano 1819 Aged fifty
nine and four months

MATTHEW LOGAN died Nov. the Twenty
seventh Ano 1820

WILLIAM W. LOGAN son of Matthew and
Elizabeth Logan died May the 25th
A.D. 1838 aged thirty years six
months and twenty one days.

ELIZABETH WELLS daughter of MATTHEW and
ELIZABETH LOGAN died April the 30th 1847
Aged 33 yrs. 4 mos., and 13 days

KATHARINE CHAMBERS The owner of this
sacred Book died the Fourth of June A.D.
1849 Aged eighty six yrs., one mo., & ten days

ELIZABETH OVERBAUGH departed this life on
the 16th of Oct. A.D. 1856 aged 71 yrs.,
5 months and 14 days

GEORGE OVERBAUGH departed this life the
23 Day of April A.D. 1855

JACOB W. LOGAN departed this life April
the 20th A.D. 1883

SARAH H. LOGAN departed this life Jan.
24th, A.D. 1885

MISCELLANEOUS LOGAN WILLS & DEEDS

MARYLAND - Frederick County
Frederick County Court, Frederick, Maryland

Will Book "A"-I, page 408 Will of James McClane 6 February 1770 To my loving
wife Dorcas the plantation whereon I now live with all the land on South side
Bennetts Creek during her natural life. At her decease to descend wholly to my
Brother William McClain during his natural life and then to his son James
Joshua McClain and his Heirs and if James Joshua McClain should die without
heirs then to remain the property of said William McClain. To my niece Sarah
Beech the bay horse called Jewel, one cow. I also give to the said Sarah's

sister Sinna Beech one cow and heifer.

Samuel Plummer

George Plummer, John Beall

JAMES MCLANE

Probated 21 Dec. 1771

Will Book "A"-I, page 504 Will of Matthew Logan 29 October 1772 To my beloved wife Jannet the one third of my moveable estate and land during her natural life and at her death to go to my beloved son Joseph Logan. My well beloved son Adam Logan to have twenty pounds My well beloved daughter Martha Logan to have thirty pounds My wife and Joseph Paxson to be executors

MATTHEW LOGAN

Alex'r Wildow

Samuel X Wightman, John Potter

Probated 28 July 1774

Will Book G. M. 2, page 526 Will of William McClain To my son Joshua McClain the debt due from Major Roger Johnson to be applied to the land purchased of Phileman Griffith, then the plantation to be to him. To my daughter Mary one slave To my daughter Susanna one slave

My son Joshua to be executor

his

WILLIAM XW MCLLAIN

mark

James Plumer, Edward X Linder

mark

Probated April 12, 1794

Will Book G.M.E. 2, p 101

Will of Robert Logan 16 October 1835

My body to be buried in a Catholic Cemetery

My niece Elizabeth Murphy daughter of Ann Murphy a two-story brick building tenement now occupied by my brother Patrick Logan.

To Rev'd Jno McClray \$30.00

To Thomas Kirk \$200.00

To Edward A. Lynch and James Gallagher \$40.00

My brother Patrick and Edward A. Lynch, Esqr., executors

Robert Logan

Deed Book E, page 462 19 June 1754

This indenture made the 19th June 1754, Between Samuel Plummer, son of Thomas, of Frederick Co. Md., Planter of the one part and William MacClean of Prince George County, Md., Planter, of the other. In consideration of sixteen pounds a tract in Frederick County called "Plummers Hunting Lott" formerly in the possession of Micaajah Plummer, situated near Piny Brook, containing 50 acres is hereby conveyed.

Solomon X Turner

Samuel Plemmer

Thos Witten

Deed Book E, page 946 19 December 1755

This indenture made the 19th December 1755 Between Charles Carroll Esqr. of the City of Annapolis, Md. of one part and William MacClean of Philadelphia County, Pa. of the other part. Whereas Daniel Carroll, late of Duddington Manor, Prince Georges Co. Md., Gentleman, by his last will and testament bearing date the 12th day of April 1734, did release unto his sister Mary his right to ten thousand acres of land by which he was entitled to half of two tracts of land now lying in Frederick Co. Md., the one called Carrolls Delight and the other called Carrolls Burch, containing each five thousand acres and Whereas

the said Daniel Carroll by his last will and testament authorized Charles Carroll to sell his share and whereas Charles Carroll party to these Presents is entitled to the other share. Now this Indenture witnesseth that said Charles Carroll as well for himself as by the Power granted unto him by the will of the deceased Daniel Carroll hath for and in consideration of the sum of forty five pounds Sterling paid by William McClean, all that tract called Carrolls Delight near the County Branch of the creek called Marsh Creek being the Westward corner to Ephraim Johnson, containing 200 acres.

William Baker
Charles Carroll

Deed Book E, p 948 19 December 1755
Between Charles Carroll, Esqr, of City of Annapolis, Md. of one part and William McClean of Philadelphia County, Pa. of other part. For 45 pounds sterling part of tract called Carrolls Delight containing 200 acres is conveyed. (all of above description is included in this deed.

William Baker, Charles Carroll, Junr
Charles Carroll

Deed Book M, page 214 21 April 1769
Between William McClain of Prince Georges Co. Md., Planter, of the one part and Joseph Walker Burton of Frederick Co. Md. of the other part, Planter. In consideration of thirty pounds paid by Burton all that tract called Plummers Hunting Lott lying in Frederick Co. on East side of run that falls into Bennetts creek containing 50 acres is conveyed.

his
William X McLain
mark

Jas. A. Beall
Chris'r Lowndes

Deed Book

PENNSYLVANIA - YORK COUNTY

Deed Book N, pp 408-410 21 May 1770
This indenture between William McClean, Senior of Cumberland Township in the County of York in Province of Pennsylvania Yeoman, and Elizabeth his wife of the one part and Moses McClean one of the sons of the said William and Elizabeth McLain of the same place, Surveyor, of the other part. In consideration of the sum of three hundred pounds, Pa. currency, and for other good causes and consideration them thereunto moving, have bargained and sold all that tract of part of a tract of land called Carrolls Delight and situated in the Township of Cumberland and laid off for two hundred acres is hereby conveyed.

Deed Book N, pp 411-413 21 May 1770
Between William McClain, Senior of Cumberland Township in the Province of York, Pa. Yeoman and Elizabeth his wife of the one part and William McClean Junior, the Eldest son of said William and Elizabeth of the Township of Hamilton Bann in Province aforesaid of the other part. Whereas Charles Carroll, Esqr., of City of Annapolis conveyed part of a tract of 5000 acres on Monocacy called Carrolls Delight supposed to be in the Province of Maryland but by the running of the Division line between Pennsylvania and Maryland, the said tract was found to be wholly in York County, and part in Hamilton Bann Township and part in Cumberland. This conveyance found in Liber E, folio 948-950. Now, this indenture witnesseth that for and in consideration 240 pounds and for other good casues' and consideration them hereunto moving, have bargained and sold to William McClean, Junr. the above described tract of land.

Marriage Register dated 1780-1860

p 270 No. I March 12, 1790 Ann McClain to Jopseh Frye
" " July 1, 1783 Comfort McClain to Menjamin Chillicoat
" " July 1, 1783 Elizabeth McClain to Daniel Heck
p 273 " April 15, 1784 Mary McClain to Jacob Hoffman
p 276 " September 23, 1786 Susan McClain to John Hinton
p 267 " March 2, 1791 Daniel McClain to Anna Mosteller
p 268 " August 4, 1783 John McClain to Elizabeth Yates
p 269 " November 3, 1796 Joshua McClain to Elizabeth Bennet
p 273 " September 25, 1780 William McClain to Mary McDonnough
p 273 " April 30, 1790 William McClain to Mary Briske
p 236 " March 19, 1778 William Logan to Margaret Shelar
p 65 " August 21, 1793 John Cramer to Mary Crise

Berkeley County Court, Martinsburg, W. Va.

DB 6, p 254 1 Feb. 1784

Between Jane Logan of Berkeley Co. Va of one part and Peter Light of same place of the other. In consideration of 50 pounds I Jane Logan have sold the half of the grain in the ground, 1 gray mare, and one sorrel mare with colt with a white face one year old and two black cows with a white face, one 12 years old and the other 6 years, 1 feather bed and 3 iron potts with all the other household and kitchen furniture remaining and being in the possession of Jane Logan.

Jane X Logan

DB 10, p 139 4 January 1791,

Know all men by these presents, that I, Jane Logan of Berkeley County, Va. for 500 pounds have bargained and sold to James Wilson a tract of land lying and being in the said county on the main road near Watkins Ferry on which said Jane now lives, containing 270 acres which was purchased by James Logan Dec'd of a certain David Watkins and devised by the said James Logan to said Jane Logan, his wife.

Henry X Johnson

Jane X Logan

DB 12, p 459 5 April 1796

Between Jane Logan widow and relict of James Logan, Dec'd, of the one part and James Wilson of same place of otherpart. In consideration of 100 pounds a tract in Berkeley Co. corner to John White on the West side of waggon road thence crossing said road to John Shearer containing 270 acres, which was granted by Lord Fairfax to David Watkins and by him sold to James Logan, in his life time who was possessed thereof for many years previous to his death and in his will devised to his wife Jane Logan.

Moses Collins

Thomas Duncan, John Parcells

Jane X Logan

Administration Bond Book A, no pagination

Jane Logan and Robert Cockburn bound 100 pounds,
17 April 1782, Jane Logan, Administratrix of James Logan, deceased

Will Book 1, pp 255-256

Dec. 21, 1781

Wife: Jane Logan

Son: Thomas Logan

Daughter: Mary, wife of James McDaniel

Executrix: wife Jane Logan

Test:

Robert Cockburn

William Ward

John Acton

Probated 17 April, 1782

Lincoln County, Ky.

Will of James Logan, Lincoln County, Ky.

Will Book A, Page 156

May 23, 1787

Wife: Martha

Sons: James, Matthew, Hugh, David and Jonathan, Charles, Robert Allison

Daughter: Martha Logan

Friend: Benjamin Logan

Test: Alexander Gaston

William

Mary Gaston

Probated July 15, 1788

SURNAME QUERY INDEX-GENEALOGY DEPARTMENT, DALLAS PUBLIC LIBRARY
DALLAS, TEXAS

GRABER

H. W. The Life Record of H. W. Graber, RB G728. Texas Collection

GRABLE (Grabel)

Wilson Lee, Mulenburg, Ky. B. 1827 d. 1927. Wilson Lee Grable was said to have been of Black Dutch and Irish descent. Was a tanner in Ky. M. Mary Anne Simmons, had 9 children: Virgil Lee, Samy, Jake Morrison, Nanny, Mary Francis, Dolph, Richard, Henry, Jonathan Eugene all born in Ky. Moved to Texas ca. 1870 and lived in Authon, Tex. between Whitt and Weatherford. Buried near Adelle. Do not know names of parents. (Mrs. Thomas Cherryhomes, 437 West Live Oak, Jacksboro, Texas, Box 575. Phone LO7-2456)

GRADY

Mary Elizabeth. In Jackson Co., Ga. 1820. Said to have married William Gideon, died early left 3 daughters and one son John. Is she the daughter of John Grady and wife Mary of Va. later Franklin Co., Ga.? (Mrs. Stephen C. Moom, 431 Candler St., Gainesville, Ga. Phone-Lenox 4 3978)

GRADY

John. Ireland, 1835. Came to Texas 1859. Joined Conf. Cavalry 1862. Discharged Hempstead 1865, Married Susan Hutchinson 1868/1866. Son John David b. 1869 Van Buren, Ark. Others: Hugh, Jenny, Edwin, James, and Nanora. Buried Temple, Texas 1908. (John C. Grady Jr. P.O. Box 444, Palm Bay, Fla. 32901)

GRADY

Nancy. Wife of Rev. Isaac Crutcher of Woodford Co., Ky. was born after 1807. Information wanted concerning ancestor, siblings, and children of Nancy Grady (Crutcher). (R.G. Brown, 3rd, 818 Kellog, Carthage, Texas. OX3-5107.)

GRAGG (Gregg)

Augusta Co., Va., Tenn. Colonial War Record. (Mrs. W. I. Fleetwood, 1209 W. Abram, Arlington, Texas)

GRAHAM

John Wesley II. B. 1852. D. 1887, White Country, Arkansas. Contact for exchange of information. (Jack R. Blackster, 10028 Santa Garza Dr., Dallas 28, Texas)

GRAHAM

Sophia A. m. Daniel McDonald probably in Va. Died probably in Franklin Co., Tenn. Dau. Hannah b. 1790 m. Peter Sells 1807. (Mrs. Ben Glusing, Box 1321, Kingsville, Texas).

GRAMMER

Came to Ark. in 1700's. Anything connected with family. (Bobby Jay Grammer, 3135 Vandina Dr., Dallas 16, Texas)

GRANBERG

Married a Blount. N.C., Ga., Miss. Anything on family. (Mrs. William D. Penn, 4423 Westway).

GRANT

Wyatt Jefferson. b. 1833, Tenn. m. 1854, Ill. Frances Summers. D. 1879 Texas. Need parents and location in Tenn. (Mrs. Thoams George III, Box 564, Corsicana, Texas)

GRANTHAM

Susannah. Born and raised in Ga. b. about 1789. Married a Mr. Sheffield, migrated to Mississippi about 1808, lost her husband on the way. Later married Capt. Jacob Guice in Franklin Co., Miss. in 1811. (Mrs. Harvie B. Blanton, 3010 Alabama, Dallas, Texas)

GRAVLEY (Gravely)

John L., Lula, Barnie, Mack, Pickens or Pendleton, S.C. 1800-1850. Carrollton, Dallas Co., Texas, Collin Co., Texas 1850-today. (Barbara Rimmer, 9111 Lindaro, Dallas, Texas)

GRAVES

See p. 213 Lost Tribes of N.C. by Ray. pp. 242 foll.

GRAY

John m. Leanne Kline. Child born at Marietta Ohio, 1853. Died approx. 1861 from illness in Union Army. Children: Lib m. Ward-Marietta, Ohio, Bell m. Racer, Parksburg, W. Va., Emma m. Demming-Morrissonville, Ill., Tillie m. ?-California, David Ezra-Greeley, Colo., Ebenezer Stansbury-Danville, Ill., George Preston-Gibson City, Ill. (Mrs. J. F. Taylor, R. 1, Rockwall, Texas, PA2-4685)

GREEN

James Henry, Craven Co., N.C. 1865. (Mrs. J. B. Bennett, Rt. 1, Box 465, Dallas, Texas)

GREEN

John b. 1788, d. 1850's. Barzilla, b. 1826. S.C. 1788-1800, Barren Co., Ky. 1800, Lawrence Co., Miss. 1830-1848, Miss. to La. 1848-present. M. Elizabeth Wroten b. 1786, S.C. Children: Urb. B. 1806-Miss., Aquilla b. 1815, Miss., Henry b. 1822-Miss., Barzilla b. 1826-Miss., Hester b. 1829-Miss., William b. 1831 Miss., Moses b. 1833-Miss., Wiley, Sarah, Elizabeth, Nancy. Family reunion every in June or July, Homer, La. Desire to correspond with any descendants. (Mrs. W.A. Lowrey, 906 Warfield Way, Richardson, Texas 75080, 235-1915)

GREEN

William W. Baptist clergyman. Murray Co., Ga. and Polk Co., Ark. B.N.C., Rutherford Co., Ark. b. 1813, d. 1887. Want information before 1813 of his family. Married to Hannah Dover. His daughter Mary Ann and her descendants came to Comanche, Texas about 1865 and are known to me since that time. Will exchange information. W.W.'s father was Amos Green. Mother was Eliz. Searcy. (Mrs. H. C. McCrary, 6112 Anita, Dallas, Texas)

ADDITIONS TO SURNAME INDEX:

ADDINGTON

Jesse (1814-1902). Union Co., S.C. Water Valley, Yalobusha Co., Miss. Died 1902, Texas. 1814 (born) Lived in Miss. 1840-1875. Looking for Jesse's parents. Will appreciate any info. on any Addingtons in U.S. (George H. Bull, P.O. Box 1071, SMU, Dallas, Texas 75222. Phone 691-1748)

AGNEW

James (1711-1770) and Samuel (1738-1790). Adams Co., Penn. 1717-1770. Abbeville, Co., S.C. 1770-1790. Proof of ancestry and descendants. (George H. Bull, P.O. Box 1071 SMU, Dallas, Texas 75222 phone 691-8748)

ASHBROOK (Ashbrooke)

Thomas-probably son of Peter. Need proof. Henrico and Chesterfield Co., Va. Died 1833 Chesterfield Co., Va. m. possibly twice. wife named in will. One son Bolling R. Ashbrook-m.(1) Lucy Clark (2) Elizabeth Snelling. Moved to Linn Co., Mo. in 1830's. (Mrs. Dan Hemphill, 1007 West 15, Odessa, Texas 79760, FR7-2157)

BATES

Michael (ca. 1740-1800) & Catherine (Dreher) Germany or England, Newberry Co., S.C. 1765-1800. Looking for ancestry and descendants. (George H. Bull, P.O. Box 1071 SMU, Dallas, Texas 75222 phone 691-8748)

BOND

Thomas and John Pearson b. 1765-? Md., Richland, Lexington Cos., S.C. Ancestry and descendants wanted. (George H. Bull, P.O. Box 1071 SMU, Dallas, Texas 75222 phone 691-8748)

CLARKE (Clark)

Peter. Henrico and Chesterfield Co., Va., Lunenburg Co., Va. Peter d. 1833 Will from 1600s-1900. Had sons Field Clarke, Peter Clarke and others. Daughters: Lucy Clarke m. Bolling R. Ashbrook. (Mrs. Dan Hemphill, 1007 West 15, Odessa, Texas 79760. Phone - FE7-2157)

CUNDIFF (Cumdiffe)

Jeremiah. Henrico and Bedford Co., Va. to Linn Co., Mo. b. 1828 d. 1895. Married Lucy Bolling Ashbrook Chesterfield Co., Va. ca 1856 and moved to Mo. (Mrs. Dan B. Hemphill, 1007 West 15, Odessa, Texas 79760, FE7-2157)

DAVIS

Thomas Jefferson (1840-1912). Collin Co., Gainesville, Cooke Co., Texas. 1868-1875, ?-1912. Looking for parents and birthplace of T. Jefferson Davis. He was born in Texas. Don't know what county. (George H. Bull, P.O. Box 1071, SMU Dallas, Tex. 75222. Phone 691-8748)

FUDGE

Jacob (1720-1790) Lancaster Co., Penn., Edgefield Co., S.C. 1790. Ancestry and descendants wanted. (George H. Bull, P.O. Box 1071 SMU Dallas, Tex. 75222)

HUTCHINS CEMETERY

Hutchins (Dallas County), Texas
 Submitted by Mrs. L. I. Cansler, Jr.
 9850 Lakemere Drive, Dallas, Texas 75238

Hutchins Cemetery is located within the town of Hutchins, ten miles south of downtown Dallas, on Denton Road a few feet to the northwest of Lancaster-Hutchins Road. Graves in the central portion of the cemetery are irregularly laid out, being the older section which was in use before survey. Dallas County deed records (Book 241, pp. 390-91) contain a map of the original survey performed by Charles Archer in May 1895. The plat was adopted as official in March 1900 by Trustees of the Hutchins Cemetery--George H. Pangburn, J. I. Irwin and Joseph T. Brightwell-- in a resolution notarized by B. D. Atwell and recorded in company with the plat.

A number of graves are unmarked. The oldest marked graves begin 4-15-1878 with Dr. E. Elgan, followed on 5-11-1878 with Thomas L. Campbell and on 11-15-1880 with Orpah G. Campbell. The most recent burial prior to the conclusion of the reading of gravestones was that of Allie Bass, who died in June 1970 on the home place on which he was born at the age of 95 years.

Five persons buried in the plot were born prior to 1820: Orpah G. Campbell, 1811; B. A. Atwell, 1813; N. L. Ham, 1817; Malinda Pruitt, 1819; and Margaret Fisher, 1819.

The following diagram divides the cemetery into four sections as a means of showing comparative location of graves within the plot.

(Colored section joins at the rear of the cemetery--not here recorded.)

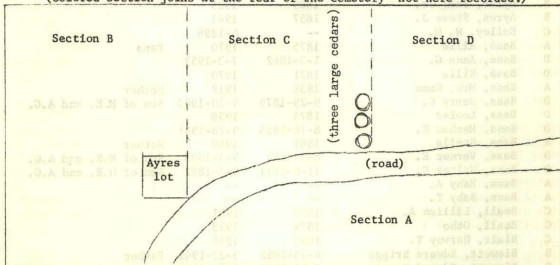

(Denton Road)

Hutchins is the hometown of the compiler, and the cemetery is the resting place of three of her grandparents-- D. L. Todd, Sarah Elizabeth Todd, and Sarah Ann Blewett.

Section	Name	Born	Died	Comment
B	Acker, Infant of Robert and Marie	2-2-1936	2-2-1936	(Todd lot--marker lost)
B	Adams, John	1854	1946	
B	Adams, Polly	1854	1929	
D	Allen, L. C.	10-1852	12-1925	Father
C	Anderson, Alex Pritchard	7-11-1886	9-20-1892	Son of O.N. Anderson
C	Anderson, Nancy	12-25-1862	1-3-1934	Mother
C	Anderson, O.	3-11-1853	10-17-1903	Woodmen of the World
D	Armstrong, Dimple Worley	12-8-1906	5-13-1967	Pretty Mama
D	Arvin, Mrs. Maude D.	6-29-1903	8-20-1966	
D	Atwell, B. A.	12-28-1813	6-26-1896	Born in West River, Md.
D	Atwell, Benjamin Dodson	5-8-1842	3-17-1928	Born Baltimore, Md. Lived in Texas over 50 yrs., dying in Hutchins Tex. Union Soldier 1861-65. Husband, Father, Friend.
D	Atwell, DeEmma C.	9-15-1849	9-29-1884	Born Jamestown, N.Y. Wife of B.D. Atwell
D	Atwell, Horton B.	4-9-1872	5-10-1923	Son, Brother, Friend
D	Atwell, Kate Simpson	12-3-1859	12-8-1946	Born Sparta, Tenn. Died Hutchins, Tex. Wife, Mother
D	Atwell, U.S. (Bob)	1894	1944	
C	Ayres, Blanche Rawlins	10-20-1871	2-29-1896	Wife of Sam
C	Ayres, Laura Rowe	10-24-1870	11-28-1892	Wife of Sam
B	Ayres, Minnie H.	1872	1957	
B	Ayres, Mollie R.	1861	1941	
B	Ayres, Sam	1846	1925	
B	Ayres, Sam, Jr.	1889	1925	
B	Ayres, Steve J.	1857	1941	
C	Bailey, W. M.	--	6-1898	
A	Bass, Allie	1875	1970	Papa
D	Bass, Anna G.	1-3-1862	7-3-1953	
D	Bass, Ellie	1871	1970	
A	Bass, Mrs. Emma	1838	1912	Mother
D	Bass, Henry E.	9-29-1879	9-10-1903	Son of M.E. and A.G.
D	Bass, Louise	1871	1958	
D	Bass, Mathew E.	8-18-1856	9-28-1931	
A	Bass, Stella	1881	1940	Mother
D	Bass, Verner E.	8-1-1884	9-4-1903	Son of M.E. and A.G.
D	Bass, Walter E.	11-6-1881	9-7-1882	Son of M.E. and A.G.
A	Bass, Baby A.	--	--	
A	Bass, Baby T.	--	--	
C	Beall, Lillian A.	1887	1961	
C	Beall, Otho	1879	1933	
C	Blair, Harvey T.	1883	1936	
B	Blewett, Edward Briggs	6-13-1882	3-22-1945	Father
B	Blewett, Edward Gervis	7-23-1914	3-31-1947	
B	Blewett, Josie Elmer	3-6-1880	11-16-1928	Mother
B	Blewett, Nancy Elizabeth	7-20-1885	12-22-1942	Our Mother
B	Blewett, Olen Briggs	8-23-1912	3-15-1934	
A	Blewett, Omer L.	2-5-1897	1-4-1916	
B	Blewett, Sarah Ann	6-18-1858	12-16-1937	
B	Blewett, Virgil M.	12-12-1880	9-17-1938	

<u>Section</u>	<u>Name</u>	<u>Born</u>	<u>Died</u>	<u>Comment</u>
B	Bonneau, Molly S.	7-20-1878	7-10-1968	
B	Boss, Sidney	9-23-1859	5-17-1920	Wife of G.E. Boss
B	Boyers, Infant of Clyde and Louise	--	--	(Todd lot--no marker)
D	Brightwell, J.H.	3-10-1826	7-28-1894	
D	Brightwell, J. L.	9-22-1865	10-15-1905	Woodmen of the World
D	Brightwell, Sarah F.	7-8-1836	1-30-1900	Wife of J.H.Brightwell
B	Brown, Dollie O.	1893	1936	
B	Brown, T.C.	1879	1937	
C	Buchanan, Jessie G.	1894	1951	
C	Buchanan, Vallie V.	--	--	(joint stone-not deceased)
D	Bussey, Anne Lavinia	12-11-1867	2-17-1955	
D	Bussey, Charles H.	11-29-1844	6-6-1923	
D	Bussey, Charles H., Jr.	6-27-1892	10-15-1951	
D	Bussey, Maria A.	1833	1914	
B	Cain, Alice B.	1869	1949	Mother
B	Cain, John P.	1885	1921	
-	Campbell, Evadna Ruth	1899	1899	(aged 2 mos.-no marker)
-	Campbell, Infant of Henry and Robbie	1926	1926	
-	Campbell, Bessie	-	-	Infant of John & Mary (no marker)
-	Campbell, Ida	-	-	" " " "
C	Campbell, John A.	1849	1910	
D	Campbell, Lee Elmo	1873	1935	Father
C	Campbell, Mary J.	1855	1930	Mother
C	Campbell, Orpha G.	1-13-1811	11-15-1880	Wife of T.J.Campbell
C	Campbell, Thomas L.	12-14-1849	5-11-1878	Son of T.J. and Orpah
B	Cantrell, James L.Jr.	7-12-1903	5-5-1966	
B	Cantrell, Lonnie J.	7-10-1894	11-18-1968	
C	Carnes, Alva Campbell M.D.	8-7-1883	5-12-1970	
C	Carnes, Alva Wood, M.D.	6-21-1856	10-28-1937	Father
C	Carnes, Minnie Lee Simpson	10-28-1861	1-27-1944	Mother
D	Carter, Dona F.	1879	1944	Mother
D	Carter, Jessie M.	1876	1955	Father
D	Carter, Jessie Graves	8-2-1924	12-29-1925	
D	Carter, Wm. Stovall	2-5-1900	1-20-1961	
D	Chaney, James H.	11-1-1899	4-2-1921	
C	Chapman, A.B.	11-9-1873	12-4-1926	
D	Chapman, Alfred	6-25-1825	3-3-1915	
B	Chapman, George C.	9-15-1857	12-19-1919	
B	Chapman, Lou A.	10-1-1858	9-24-1899	
C	Chapman, Lucy V.	6-23-1874	9-1-1954	
C	Chapman, Lue E.	3-31-1855	10-7-1876	Daughter of J.G. & N.C.
D	Cheatham, R. G.	--	11-19-1908	Aged 46 yrs.
B	Childress, Dora	1-28-1873	10-18-1943	(stone in error-born 1875)
B	Childress, Elina	7-10-1839	8-11-1917	Wife of T.J.
B	Childress, James Howard	7-1-1917	12-29-1968	Husband and Father
B	Childress, James W.	1890	1959	Father
B	Childress, Jessie Ann	1895	1949	Mother
B	Childress, John J.	1869	1959	(husband of Dora Todd)
B	Childress, Robert Sidney	1914	1929	Son
B	Childress, T.J.	11-1-1839	1-18-1937	Father
D	Chilton, A.J.(Jack)	2-16-1871	10-16-1931	
D	Chilton, Willie	5-29-1875	6-6-1965	

Section	Name	Born	Died	Comment
A	Choyce, George W.	4-21-1858	8-20-1914	
A	Choyce, Nancy R.	9-13-1851	8-27-1930	
A	Choyce, Sarah H.	11-27-1855	10-17-1934	
C	Clark, A. S.	1-8-1834	8-26-1905	
C	Clark, Alonzo B. (Lonnie)	1-6-1864	9-23-1875	Son of A.S. and N.G.
C	Clark, Nancy G.	8-4-1838	6-1-1905	Wife of A.S.
B	Clements, John T.	2-21-1843	7-21-1919	
B	Clements, Mary Jane	1844	1940	
C	Clevenger, Charley P.	7-14-1872	1-24-1938	
C	Clevenger, Isabel H.	3-30-1837	1-9-1916	
C	Clevenger, John	5-30-1837	4-14-1900	
C	Clevenger, L.D. (Dick)	4-9-1864	7-1-1949	
B	Clymer, J. G.	12-21-1847	2-8-1924	
B	Coffman, Joe Marvin	11-8-1917	10-28-1918	
B	Coker, Harve	5-2-1884	3-23-1919	Woodmen of the World
B	Coker, J.O. (Jim)	1878	1952	" " "
B	Coker, John T., Sr.	1872	1921	
B	Coker, John Thomas	5-5-1914	8-29-1959	Texas-Private U.S. Army - World War II
B	Coker, Katie	1884	1958	W.B.A. emblem
B	Coker, M. W.	7-11-1848	5-9-1918	Wife of W.J. Coker
B	Coker, Necie L.	6-1-1875	9-16-1956	
B	Coker, Wm. Houston	4-17-1899	6-10-1918	Son of M.G. & Geneva
B	Coker, W. J.	7-23-1842	--	
B	Comstock, Arthur	1932-	1963	Honey
C	Cook, Addie	9-26-1863	12-19-1922	
C	Cook, George	6-27-1898	4-29-1901	Son of T.J. & A.C.
C	Cook, T. Jeff	8-29-1849	10-18-1900	Aged 2 yrs, 10 mos, 2 dys. Huband of Addie C.
C	Cook, Tommy	9-3-1899	11-25-1899	Dau. of T.J. and A.C. Aged 2 mos, 22 days
D	Cortemegli, Gertrude P.	1-23-1919	12-27-1961	
D	Daniel, Bettie	1-30-1881	8-3-1922	Wife of A.A. Daniel Mother of Janette and Glenn
D	Daniel, Edna Mae	1882	1953	Mother
D	Daniel, F.R.	1876	1937	
D	Daniel, Lura Ann	1870	1959	
D	Daniel, Mary E.	2-16-1848	12-14-1943	Mother
D	Daniel, Sallie	1-9-1878	2-5-1913	Wife of Frank Daniel
D	Daniel, Sam W.	1874	1960	Daddy
D	Daniel, Uncle Tobe	1869	1951	
D	Daniel, W. E.	5-14-1846	6-21-1899	
D	Davis, J. T.	1876	1930	
D	Davis, Jim	8-8-1853	3-14-1914	Father
B	Davis, --	--	--	(surname only on stone)
B	--	--	--	(adjoining grave has similar stone, no name)
C	Dawdy, A.	12-18-1826	1-23-1901	
B	Dawdy, Ollie Ross	1-31-1920	7-19-1921	
B	Dawdy, Ross	12-4-1884	9-1-1951	
B	Dawdy, Willie Beatrice	11-5-1886	8-10-1968	
B	Duffer, James H.	10-19-1858	8-12-1943	Father
B	Duffer, Mary G.	3-28-1856	6-17-1928	Mother
D	Edwards, Fannie Atwell	8-3-1875	8-1-1961	
D	Edwards, Elouard R.	10-11-1872	5-21-1906	

Section	Name	Born	Died	Comment
D	Epperson, Edgar E.	1-9-1905	7-8-1956	Husband and Father
D	Epperson, Ellen	3-15-1849	1-25-1925	
D	Epperson, J. W.	1-17-1838	4-20-1912	
C	Elgan, Alvin	1-17-1895	1-24-1895	Son of J.B. & Elizabeth
C	Elgan, Dr.E.	1-15-1821	4-15-1878	
C	Elgan, Margaret	2-26-1825	10-3-1883	
D	Ferguson, J.R.	1871	1934	
D	Ferguson, Mary Elizabeth	10-20-1876	1-18-1968	born in
C	Fisher, Margaret	5-8-1819	5-25-1883	Wife of S.A.Fisher-Tenn.
C	Fitzjarrel, Sammeye	10-14-1877	7-18-1878	Son of J. and S.
C	Fitzjarrel, Eli	7-24-1875	12-31-1880	Son of J. and S.
D	Floyd, Kathryn	6-19-1898	7-4-1963	Mother
D	Floyd, Leslie D.	12-1-1879	10-3-1950	
B	Franklin, Michael Ward	8-29-1944	8-31-1944	
A	Garrett, Joseph Thomas	9-17-1917	4-23-1968	
C	Gaston, A.A.	5-20-1881	1-14-1914	
C	Gaston, Bettie M.	9-29-1854	7-17-1895	Wife of J.H.Gaston
C	Gaston, Billie	1876	1927	
C	Gaston, Jack Miller	2-7-1874	7-15-1942	
C	Gaston, John H.	11-17-1848	7-16-1921	
C	Gaston, Robert H.	11-28-1878	5-5-1962	
C	Gaston, Belle Richardson	1877	1969	
C	Gaston, Augustus Ayres	--	--	
D	Gibson, Jessie R.	8-9-1894	2-28-1904	Son of G.C. & N.E.
B	Goard, Ida M.	3-9-1884	12-14-1956	Mother
D	Goar, Julia E.	1851	1929	
B	Goar, King R.	12-27-1881	8-3-1950	Father
D	Goar, S. F.	1847	1900	
D	Gosnell, Ellen	1848	1922	
D	Gosnell, Fred	1887	1925	
D	Gosnell, Samuel	1851	1923	
D	Graves, Richard Watson, M.D.	10-25-1857	8-12-1943	Pappy
D.	Graves, Thaddeus Cullen	--	2-15-1932	Tex.-Pvt. 315 Engr.- 90 Division
D	Graves, Thaddeus Cullen Jr.	5-29-1921	8-19-1921	
D	Griffin, Infant son of J.L. and Dora	12-5-1902	12-5-1902	
D	Grubbs, Susie Ellen	3-12-1866	1-22-1908	Wife of J.P. Grubbs
B	Hall, Billy Fred	8-25-1927	12-28-1931	Son of W.B. & L.F.
B	Hall, Lorene	5-6-1907	1-27-1929	
D	Ham, Mary L.	5-15-1830	4-30-1907	Nee Haltom
D	Ham, N. L.	12-27-1817	3-2-1898	
A	Hamilton, E. Homer	7-29-1902	1-15-1911	Son of J.H. & M.C.
A	Hamilton, Dr. John H.	6-28-1857	4-22-1906	
A	Hamilton, Lawrence C.	1877	1960	Father
A	Hamilton, Melissa C.	1860	1921	
C	Hancock, June Margaret	6-13-1916	9-28-1935	Wife of E.B. Hancock
D	Harkins, Hobart H.	2-12-1905	3-23-1961	Husband
D	Harkins, Cora M.	11-29-1905	--	Wife
C	Harris, Carl	9-18-1884	12-2-1893	
C	Harris, Gracie	8-18-1889	9-12-1890	Dau. of H. and M.H.
C	Harris, Herman, Sr.	1-9-1844	9-7-1908	
C	Head, Earnest	8-1-1865	10-16-1888	Son of Henry E. and L.F.
C	Head, H. E.	1-22-1821	5-25-1904	Father

Section	Name	Born	Died	Comment
B	Higdon, Annie Mason	1-5-1846	10-20-1923	My Mama-Our Aunt Katie
B	Hill, Ola May	--	1-12-1898	Aged 8 yrs. Adopted dau. of J.W. & Fannie Miller
D	Hollomon, Nettie	10-10-1859	6-15-1911	Wife of W.O.Hollomon
B	Howard, George	1873	1933	
B	Howard, Alice	1877	1968	
D	Hubble, L. T.	7-28-1885	1-11-1907	Wife of W.R. Hubble
B	Hudler, Maude D.	11-24-1892	1-21-1962	
B	Hudler, Jim G.	1887	--	(Joint stone-not deceased)
B	Hudson, D.B.	1857	1927	
C	Huff, D.E.	2-14-1864	11-28-1892	Born Gwinette Co., Ga. Died Hutchins, Tex.
B	Hyden, Billy Warren	7-24-1921	6-27-1955	Texas-Pvt. 1537 Base Unit A.A.F.-World War II
B	Hyden, Mary Etta	1897	6-23-1966	
D	Irwin, James I.	5-2-1869	7-2-1917	Woodmen of the World
D	Irwin, Lula B.	1873	--	
D	Irwin, John S.	12-5-1909	1-22-1911	
D	Jackson, Mabel	9-9-1878	7-22-1898	Wife of Robert Jackson
B	Johnson, Frank	6-3-1900	4-5-1955	Tex.-Pvt. Co. B 445 Res. Labor Bn.QMC-World War I
B	Johnson, James T.	10-22-1865	4-5-1917	Woodmen of the World
D	Jones, Silas Lee	4-9-1879	12-19-1964	
A	King, Henry F.	3-1-1905	4-4-1962	
D	King, Mrs. Laura Lee	--	3-13-1966	
A	King, H. A.	8-22-1877	6-8-1960	
A	King, Maudie	6-19-1874	3-16-1947	
C	Kiser, W. B.	3-12-1842	12-20-1881	
B	Langford, Wallace W.	1885	1962	
C	Lederer, Fred	9-12-1851	1934	(in vault)
C	Lederer, Margaret	--	1935	" "
C	Lederer, Sophia	2-9-1827	8-27-1906	
D	Leggett, Geary E.	7-27-1867	4-3-1897	Son of L.E. & L.M.
D	Leggett, L.E.	10-2-1836	1-23-1908	Co. G 84 Pa. Inf.
D	Leggett, L.M.	1-29-1841	4-20-1923	Mother
C	Lemon, Elmira H.	9-25-1826	7-3-1893	Wife of T.O.Lemon
C	Lemon, Tilman O.	8-25-1836	9-5-1896	
C	Littlefield, George W.	7-16-1858	12-31-1895	Born South Carolina
B	Macon, Eva Ovella	1879	1943	Mama
B	Macon, Thomas Joel	1862	1921	Papa
D	Malone, D.A.	--	--	
C	Maroney, Willie	6-5-1891	10-8-1892	Son of W.M. and Zula
B	Martin, John Lenard	6-16-1927	6-26-1947	Son
B	Martin, Paul Henry	6-30-1895	4-15-1955	Tex-Pvt. Demob. Det.- World War I
B	Martin, Viola	12-22-1894	11-24-1929	
B	Maughs, Edith Amonette	1900	1959	
D	McCain, J. F.	3-5-1882	1-24-1911	
C	McCain, Sidney E.	6-15-1878	3-16-1908	
C	McCain, Zachariah	12-26-1851	3-1-1905	Woodmen of the World
B	McCaffey, I.T.	12-15-1861	9-1-1949	
B	McCaffey, I.T. Jr.	1918	1940	
B	McCaffey, Katie	10-19-1869	8-19-1919	
B	McIntire, Allie Mae	1900	1930	Mother
B	McIntire, Charles Lyonell	1918	1920	

<u>Section</u>	<u>Name</u>	<u>Born</u>	<u>Died</u>	<u>Comment</u>
B	McIntire, James Durwood	1920	1932	Our Son
D	McMullen, Agnes	1-18-1899	3-10-1899	
D	Merritt, Johnnie Alma	6-23-1904	9-13-1920	
B	Miller, Carrie	11-8-1854	9-5-1925	Our Grandmother
B	Moore, Baby	3-7-1911	3-7-1911	
B	Moore, Birdie	5-8-1910	5-25-1910	
B	Moore, George Samuel	12-19-1904	7-18-1960	Tex.-Pfc. 75 Base Hq. and A.B. Sq.A.A.F.- World War II
D	Moore, George W.	2-14-1842	9-29-1909	
B	Moore, George W.	11-24-1867	12-21-1933	
B	Moore, Mary M.	9-25-1869	3-19-1912	
D	Moore, Phebe	9-7-1844	12-22-1914	
B	Moore, Samuel I.	1880	1970	
B	Moore, Susie E.	1896	1954	Mama
D	Moore, W. A.	10-26-1879	12-30-1899	Son of G.W. and Phebe
D	Moore, Wm. J.	1869	1916	Woodmen of the World
A	Mousner, John	1869	1945	
A	Mousner, Johnnie	1904	1961	
A	Mousner, Roy Milburn	--	1912	
A	Mousner, Teresa	1879	1963	
A	Murphey, Margaret Lucretia	1-7-1952	1-8-1952	(dau. of Rev. Jimmy and wife Marilyn of Christian Church)
B	Napier, S.L. (Bud)	12-18-1889	3-29-1968	
B	Napier, Sallie	1860	1953	
B	Nevitt, Ward Scott	5-4-1959	7-15-1961	
D	Nichols, Gilbert	9-23-1895	6-23-1896	Son of D.A. & Ida
B	Nix, Minnie	10-12-1891	6-19-1893	Dau. of W.E. and S.E.
C	Nix, W.E.	11-17-1868	10-12-1915	Woodmen of the World
A	Odell, Daisy C.	1-15-1867	10-15-1946	
A	Odell, L. B.	12-9-1861	3-2-1907	
A	Odell, Mary C.	3-25-1840	12-3-1908	
B	O'Keefe, John A.	9-11-1899	7-16-1929	
B	O'Keefe, John A., Jr.	7-25-1926	5-17-1936	
B	O'Keefe, Timothy	7-12-1877	10-21-1957	Husband and Father
B	O'Keefe, Tom Elliot	9-10-1898	11-22-1960	Tex.-Cpl. U.S. Army - World War I
B	O'Keefe, Zetta B.	3-16-1895	6-20-1960	
C	Osborn, Shirde M.	4-14-1875	4-3-1895	
D	Paine, James Francis	1-4-1894	1-10-1895	
D	Paine, John S.	6-16-1851	9-27-1927	
D	Paine, Lucinda M.	12-24-1870	8-4-1849	
D	Paine, Oliver M.	5-25-1903	1-20-1962	
D	Paine, Jessie Lee	1-27-1905	4-5-1907	
D	Paine, Quanah Jackson	1-5-1897	7-29-1917	
C	Pangburn, George	2-1-1864	1-31-1955	
C	Pangburn, Henry	5-29-1873	6-1-1952	
C	Pangburn, Mary M.	10-28-1867	2-9-1952	
C	Pangburn, Nellie P.	7-21-1870	8-1-1949	
C	Pangburn, Henry	1829	1892	Father
C	Pangburn, Lila	1865	1892	Sister
C	Pangburn, Susan O.	4-10-1837	2-17-1906	Mother
D	Pate, Alice M.	5-28-1866	2-7-1914	Wife of S.D.

Section	Name	Born	Died	Comment
D	Pate, Stephen D.	11-30-1844	8-15-1899	Born La.-Died Hutchins, Tex.
C	Payne, H. L.	3-19-1826	3-10-1902	
C	Payne, Mary E.	--	2-16-1956	(aged 92- no marker)
C	Payne, W. E.	10-4-1855	3-26-1895	Son of H.L. and Sally E.
C	Payne, W. E.	1-18-1900	6-9-1902	Son of R.L. and L.E.
B	Percival, Eva Dunn	10-15-1866	10-31-1925	Our Mother
B	Percival, Jackie	1-26-1919	8-5-1924	Our Little Girl
B	Percival, John C.	12-4-1848	4-29-1929	Our Father
B	Percival, Roy G., Jr.	6-15-1920	6-15-1920	Our Baby
C	Perigo, Baby	--	--	
C	Perigo, Dave G.	7-2-1884	2-11-1951	Daddy
C	Perigo, Mary M.	8-14-1895	--	Mama
B	Perry, Lennie Lee Chapman	7-16-1892	12-24-1965	
C	Peyton, Millard Filmore	3-16-1850	6-9-1883	
C	Peyton, Thomas Green	11-18-1825	5-26-1889	
B	Phinney, Mary Ella Coker	1884	1918	
D	Ponder, Larkin	12-29-1883	1-30-1887	Son of H.W. and M.E.
D	Ponder, Margaret	10-15-1826	3-19-1893	Aged 67 yrs, 5 mos, 4 days
D	Ponder, Willie	12-17-1875	2-28-1893	Son of H.W. and M.E.
C	Potter, Ole R., Sr.	7-28-1880	2-21-1949	Father
D	Price, Sarah	4-1-1899	10-29-1936	Sister
C	Pruitt, Ernest	--	--	Children of Lou & Bessie
C	Pruitt, Willie	--	--	" " " "
C	Pruitt, Fay	--	--	" " " "
D	Pruitt, Malinda	1819	1898	
D	Raby, Millie Lee	9-12-1898	7-4-1901	Dau. of W.L. and A.
B	Ratcliff, Infant of B.W. and M.E.	12-12-1903	12-12-1903	
C	Rawlins, Alvin Lawrence	9-3-1892	7-10-1894	
B	Rawlins, Bessie H.	1889	--	(Joint stone with Wiley H.; not deceased)
D	Rawlins, Claude L.	1-23-1873	12-16-1954	Daddy
C	Rawlins, James V.R.	6-29-1861	7-13-1951	
C	Rawlins, Katherine	4-16-1907	1-20-1958	Nana
C	Rawlins, Lavinia	10-11-1890	--	(Not deceased)
C	Rawlins, Lee C.	11-6-1867	6-22-1927	
D	Rawlins, Mamie	1-19-1880	1-3-1960	Mother
C	Rawlins, Marvin Earl	5-22-1875	6-23-1943	
C	Rawlins, Rella Elizabeth	10-16-1879	6-3-1954	
B	Rawlins, Wiley H.	10-14-1891	1-28-1964	
D	Reynolds, Foster	1887	1915	
D	Reynolds, Malinda A.	1870	1941	
B	Reynolds, Maritna Comstock	6-20-1910	6-25-1955	
D	Rich, Berta	1897	1937	Wife
D	Rich, Mittie Frances Mangum	1908	--	
D	Rich, Richard Edwin (Bud)	1892	1945	
D	Rich, T. J.	1890	--	
B	Roper, James R.	1858	1923	Father
D	Samuel, Eliza	1844	1920	
D	Samuel, S. P.	1837	1920	
C	Schultz, Emma Foote	4-11-1888	8-12-1958	Mother
C	Schultz, John H. C.	1859	1936	
C	Schultz, John Henry, Jr.	11-25-1888	8-6-1969	Father

Section	Name	Born	Died	Comment
C	Schultz, Mary Alterman	1863	1945	
D	Scruggs, A. B.	7-10-1885	4-24-1886	(Note: A large stone on
D	Scruggs, G. G.	7-6-1855	4-18-1886	this lot had fallen and
D	Scruggs, G.G. Jr.	9-22-1887	4-8-1909	could not be read.)
D	Shellito, John S.	1894	1943	Father
D	Shipp, Della Mae	7-6-1921	6-4-1924	Baby Daughter
C	Sillings, Erma Sue	1926	1927	
C	Sillings, Irma	7-18-1896	6-28-1931	
C	Sillings, Milton Hugh	1926	1927	
B	Simmons, Annie Chapman	8-28-1890	7-23-1968	
B	Simmons, Minnie Jane	2-10-1881	3-24-1970	
B	Simmons, Wm. Richard	1891	1966	Pop-Husband of A.M.
D	Simms, Margaret Jean	1925	1925	
C	Simons, Alva R.	3-13-1893	9-23-1964	Texas-Wagoner U.S. Army - World War I Texas-Pvt. 129 MG Bn. 35 Div.
C	Simons, Willie S.	8-6-1891	12-9-1931	
D	Slocum, Catherin	7-16-1847	2-27-1925	
D	Slocum, Charls	8-27-1875	5-31-1916	
D	Slocum, Henry	5-31-1874	6-26-1904	
D	Slocum, John P.	11-29-1847	3-16-1927	
C	Smith, Ada Enola	4-9-1894	1-9-1898	Child of C.D. & Minnie B.
B	Smith, Benj. Frank	11-20-1897	6-28-1967	
B	Smith, Dora E.	1-30-1898	1-28-1928	Wife of J.Y. Smith
A	Smith, Florence H.	4-11-1862	10-20-1908	Wife of W.D. Smith
D	Smith, Jess D.	1-23-1882	3-2-1962	Born in Emory, Rains Co., Tex.
C	Smith, Lavinia Fay	7-6-1896	1-11-1898	Child of C.D. & Minnie B.
C	Smith, Lella B.	1881	1964	
C	Smith, Lola Nea	11-2-1890	5-23-1897	Child of C.D. & Minnie B.
B	Smith, Mary Lou	9-26-1911	11-26-1958	Mother
C	Smith, M. Boone	4-29-1908	10-28-1934	
C	Smith, Sidney S.	1874	1955	
A	Smith, W. D.	1850	1924	
B	Spencer, John W.	1842	1927	
B	Spencer, Lucy K.	1881	1945	
B	Spencer, Mary J.	1847	1931	
C	Stenson, Ella	9-6-1907	7-24-1967	Wife and Mother
C	Stone, Hendrick S.	1-31-1885	1-31-1885	Son of W.P. and L.N.
C	Stone, Dr. Wm. P.	2-14-1829	10-13-1886	Masonic emblem
C	Strong, Melissa Ann	9-5-1863	11-11-1914	
B	Strong, Willis	1882	1935	
C	Swires, Mary R.	11-14-1856	4-20-1877	Wife of George Swires
C	Tatom, Betsy Gaston	8-19-1883	8-2-1969	"Muds"
C	Tatom, Henry C.	3-8-1876	9-19-1911	Mizpah
A	Tessman, August C.	1861	1952	
A	Tessman, Bird M.	1871	1957	
D	Tessman, Kittye Atwell	2-2-1896	12-11-1952	
B	Thomas, Christopher E.	8-8-1963	1-10-1966	
C	Thomas, Grover D.	--	2-9-1924	Tex-Chauffeur 1 Cl. 679 Aero Sq.
C	Thomas, Nettie E.	1869	1945	
C	Thomas, Wm. L.	1863	1936	
D	Thompson, Thomas Edward	10-20-1886	10-18-1918	Woodmen of the World
B	Todd, D. L.	1-26-1855	11-30-1937	

Section	Name	Born	Died	Comment
B	Todd, Ethel	--	--	(Dau. of J. G.)
B	Todd, Sarah E.	--	11-22-1922	Aged 63 years
C	Turns, J. M.	11-20-1840	11-21-1900	
C	Underwood, Bobby Wayne	12-3-1941	9-25-1966	Son
C	Underwood, Thomas	8-8-1913	12-25-1965	Father
C	--	10-5-1874	6-5-1956	Hutchins Mama
C	Underwood, Walter	2-23-1901	6-1-1955	
B	Vaught, Elna Mae	10-18-1903	4-29-1939	
C	Wagner, Martha J.	6-6-1875	8-17-1939	
D	Wagner, Marvin W.	10-14-1909	1-5-1958	
C	Wagner, Walter P	12-1-1874	6-7-1930?	
B	Ward, Margaret Mary	12-3-1916	2-20-1924	
B	Ward, Thomas Dennie	8-15-1888	9-11-1962	
B	Ward, T. D. Jr.	8-23-1918	2-22-1924	
B	Ward, Wm. Jack	10-24-1921	9-30-1922	
B	Ward, Lallie Madge	2-21-1891	--	
B	Warner, Donnie	1879	--	
B	Warner, Frances Elvina	1863	1949	
B	Warner, John Porter	1848	1929	
B	Warner, Willie	1874	1944	F-L-T Metropolis 378
A	Whisnand, Burta	1876	1962	
A	Whisnand, Henry C.	1873	1943	
A	White, Allie	1859	1939	
A	White, J. S.	7-16-1843	8-6-1905	
C	White, Laura L.Gaston	3-22-1875	1-4-1901	Wife of Hal E. White
D	Wierick, Tennessee	1-8-1886	1-2-1889	Dau. of G.W. and M.G.
B	Williams, Bessie J.	1900	1954	Mother
B	Williams, Freddie	7-20-1933	12-12-1937	
B	Williams, John W.	1893	1951	Father
D	Willoughby, Arch J.	1851	1905	Father
D	Willoughby, Eliza J.	1849	1929	Mother
A	Wood, Mary Lucille	3-28-1900	2-10-1904	Dau. of B.S. and Mattie
D	Worley, Glif B.	1-13-1904	12-28-1955	Husband and Daddy
D	Worley, Infant son of Glif and Dimple	--	2-17-1927	
B	Worsham, Pinkie An	11-24-1887	2-17-1920	
B	Wright, Henry W.	4-16-1869	5-23-1952	
B	Wright, J. E.	1827?	1-19-1884	(Floral spray said Mother.) (or 1894)
D	Wyerick, Ophelia	6-7-1897	6-5-1898	Dau. of G.W. and M.G.
D	Yates, Lester Lee	--	10-15-1917	
D	Yates, Myrtle	1892	1929	Daughter
D	Yates, Verda Willie	--	1-24-1915	
C	Young, G.	--	10-4-1907	Father
C	Young, P.	--	2-25-1912	Mother
C	Youngblood, Maggie A.	10-1-1861	2-1-1943	
C	Youngblood, W. T.	7-16-1857	5-13-1911	Woodmen of the World

THE STRACHAN FAMILY BIBLE

Records copied by Mrs. Eugenia Butler Toland and Mrs. Betty Harvey Butler from the Strachan Family Bible, now in the possession of Mrs. Maud Christian Dial of Big Sandy, Texas. There is no longer a Title Page, but the following appears between the Old and the New Testament:

The New Testament references by the late Rev John Brown, Minister of the Gospel at Haddington, New York. Printed by Hodges & Campbell and sold at their respective bookstores. M.DCC.XCII.

William Strachan was born on Sunday, the 30th of August, 1752 Old Stile.

Helena Bogert was born on Sunday, the 7th of Feb. 1768.

Ann Ferguson, mother of William Strachan, died Jan. the 2nd, 1786, aged 65 yrs.

Daniel Ferguson, her husband, died Oct. 13 1787, age 67 years.

Wm. Strachan and Helena Bogert was married by the Rev Mr. Myers at Preakness on Sunday the 24th day of March, 1782.

Alida, our first child was born on Monday morning 8 o'clock the 8th January, 1787 and was baptized by the Rev Dr. John Rogers the 4th of Feb. following.

On Monday, the 3rd day of November, 1788 was born our second child, a son which died the 6th, only 3 days old.

Ann our third child, was born on Friday evening 8 o'clock the 15th day of January, 1790 and was Baptized by Doctor Rogers the 21st February following.

William, our fourth child, was born on Tuesday Morning 6 o'clock the tenth day of January, 1792 and was Baptized by Dr. Rogers the 5th of February following.

David Ritzema, our fifth child, was born on Saturday between 12 and one o'clock (noon) the First day of March 1794 and was Baptized by Dr. McKnight the 30th of the same month.

Eliza Kermit, our Sixth Child, was born on Tuesday afternoon at five o'clock the twenty-third day of February, 1796, and was Baptized by the Rev Doctor McKnight on Monday the 28th of March following.

Helen, our Seventh child was born on Monday afternoon at five o'clock the twenty-third day of April, 1798 and died the 26th of June following.

Died at his house, No. 83rd Pearyl St. in the City of New York on Friday morning October 12th, 1798, a quarter after three o'clock of the prevailing fever, Capt Wm. Strachan, after a severe indisposition of six days. Aged forty six years one month and two days. His remains were decently interred in the old Presbyterian Church yard the same morning at half after five o'clock.

8. A posthumous son born 6th of May, 1799 and Baptized by Mr. Van Vanbrauken Nov. 21, 1799, Henry Kermit. Capt. Kermit and wife sponsors.

On Thursday 1/4 past seven o'clock, in the evening, June 20, 1799, died at The Hermitage, Beekman, in the house of her father, Helena Strachan, age 31 yrs 4 months and 13 days. Her remains were interred June 22, in Hopewell Church yard.

Henry Kermit Strachan died on Tuesday, March 11, 1800, at Beekman, age 10 months, 3 days - was interred on the following day in Hopewell Church yard in his Mother's grave.

Alida Strachan, died on Friday at 1/4 part of 12 o'clock 26th March 1813 and was interred in her Father's grave. Aged 26 yrs. 2 months and 18 days.

David R. Strachan - Died on Thursday the 20th October, 1848 at the Farm, of Saints Rest, Salt River Township, Shelby County, Missouri. Aged 52 yrs and 7 months.

W. B. Christian died March _____ 1862, 5 o'clock P.M.

David S. Anderson and Ann Strachan was married by the Rev James Rosmeyer at Hackensack on Monday 6th of May, 1816.

Samuel Cassidy and Eliza Kermit Strachan were married at St Michael's Church by the Rev W Jarvis on 20th Nov., 1816.

David R. Strachan and Hester Frazier were married by the Rev Mr Wm Smart at Ogdensburgh St Lawrence Co, on 13th Aug, 1817.

1. Helena Alida was born 13th Sept 1818 and was baptized by the Rev Mr. Clinton.
2. Hester Ann Elizabeth was born the 3 June 1820 and was christened by the Rev Mr. Clinton.
3. Wm. Ritzema was born 13 Dec. 1822 and was baptized by the Rev James McAuley

Died at Ogdensburgh Jan 15, 1827 at 8 o'clock P.M. Hester Strachan, aged 25 years 3 months 26 days.

David R. Strachan and Maria Matilda Young were married by the Rev Daniel Dervelle at the Brainerd Church on the 3 day of March 1834.

1. Maria Antoinette Keren-Happuch our first child was born 1/2 past 1 p.m. on the 3 of April 1835 and baptised by the Rev Charles G. Fimney
2. Timothy Bryant, our second child was born on 3rd of September 1836 and baptised by the Rev Mr. Lusk of Jersey City

Timothy Bryant, our second child died August 30, 1837 - interred in Harsinus (?) burying grounds

3. Rudolphus Bryant, our third child was born at 1/2 past 10 o'clock on Friday P.M. 15th Dec. 1837 and baptised by the Rev Mr Leavett June 13, 1838
4. Cornelius Bogert our fourth child was born the 25th of May 1839 about 8 o'clock A.M. and was baptised by Rev Mr Polman
5. Henry Fitz Warren our fifth child was born 25th of Sept. 1841 at 2 o'clock A.M. and baptised by Rev Mr Maker

6. Edward Degrove our sixth child was born April 26th 1844 in N. York City

Helen Alida wife of L N Fowler oldest daughter of D R and Hester Strachan died 25 of May 1841, intered in the church vault of the 7th Presbyterian Church of New York

Lorenzo N Fowler and Helena Alida Strachan were married by the Rev Mr. Leavitt June 13, 1837

Edward W DeGrove and Hester Ann Eliza Strachan were married at the Brainard Church by the Rev Mr Smith October 27th 1841.

Helen Strachan Anderson Fowler was born the 13th June 1838.

Edward Ritzema DeGrove was born the 5th May 1848 in New York City

William B. Christian and Maria Antoinette Strachan were married by Rev Mr. Nunan March 14, 1854.

Ida Lizzie Langdon Christian was born Feb 28th 1855

John Henry Meason and Maria A. Christian were married Oct 4, 186_ by Rev Wesley McMurray at Bacon Chapel Shelby Co Mo.

Martha Melville Meason was born on Sunday 6 o'clock PM July 10, 186_

Hester L. Meason was born Nov. 26th 1866 at 5 o'clock AM

Edward L. Gould Meason was born Mar 25, 1869 at 11 o'clock A.M.

Eva Matilda Christian was born Mar 8, 1857

Helen Cornelia Christian was born Sept. 27, 1859

Willie Maud Eugenia Christian was born Dec 8, 1861

Letter written by Lieut. William Strachan while serving in the Second Artillery Regiment under the command of Col. John Lamb, New York, to his future father-in-law, Nicholas Bogert, Preakness, New Jersey. Letter is now in the possession of Robert K. Butler, a descendant of William Strachan.

Art'y Park February 14, 1781

Hon Sir,

Whilst writing to the younger part of the family I cannot help dedicating a line to you Sir and first then let me congratulate you on the most excellent news from the Southward, which I suppose your News Papers will tell you the particulars of, but least you may not see them so soon as this letter, I will transmit a few particulars. It was on the 17th day of January that the Brave General Morgan, with only eight hundred, defeated the Rash Col. Tarlton with one thousand, and pursued him upward of twenty miles. The following I took from a hand bill published by order of Congress, and the gentleman who had it was going on express to his excellency - The enemys loss 10 commissioned

and 100 rank and file killed, 29 commissioned and 500 privates prisoners, and 200 wounded - 2 pieces of artillery, 2 standards, 800 muskets, 1 traveling forge, 35 baggage waggons, 70 Negroes, 100 dragoon horses. Our loss only 12 killed and sixty wounded and they engaged with bayonets for a considerable time. May they always share the same fate is sincerely wished by the writer of these lines. When, my dear Sir, shall we live in our native place again. When shall War be done away with, and peace Sweet peace again bless our land. What a happiness will it be to us poor inhabitants of New York, when we all meet again. It is beyond conception. Therefore, shall not offer to point it out, but leave it to the period which I hope is not far off. For any thing new among us is not, peace & harmony seem to dwell, and tho not the best situated, yet I believe as contented as any other troops, but why trouble you any further, perhaps tired already. Well, Sir, I will quit after presenting my best respects to your worthy Partner in Life, to my little Nancy, Caty and in a word to the whole of your family. My best wishes attend and may every one of you experience happier times and live to enjoy all those pleasures which your minds can fancy. Especially enough of them to satisfy in the room of the many difficulties you have all encountered with. I shall not add, but remain tho at a distance the same as heretofore.

Your sincere well wisher,

Billey Strachan

(Letter described the Battle of Cowpens, S.C.)

ADVERTISING POLICY

The Local History and Genealogical Society accepts orders for advertising space in THE QUARTERLY.

R A T E S

\$25.00:	Full page,	8 x 11 inches, 1 time
15.00:	1/2 page,	1 time
10.00:	1/4 page,	1 time
1.50:	1 inch,	1 time

GENERAL INFORMATION ABOUT SOCIETY ACTIVITIES

Mr. Hershel W. Anderson, President
4012 Centenary Drive
Dallas, Texas 75225 Tel.: 361-1280

Mrs. R. F. Dishman
10609 Longmeadow Dr.
Dallas, Texas 75238 Tel.: 348-1575
Articles for the QUARTERLY

Mrs. Duane C. Cleere
1820 N. Beltline Road
Irving, Texas 75060 Tel.: 252-2508
Membership - Send \$6.00 Membership Dues for 1971.

COLLIN COUNTY, TEXAS - 1867
 ASSESSMENT OF PROPERTY SITUATED IN OTHER COUNTIES
 Submitted by Mrs. Edward Hughston
 5314 Palomar Lane
 Dallas, Texas 75229

Special effort was made to copy accurately these original records from the 1867 Collin County, Texas, Assessment Book. Editorial remarks and questionable interpretations are enclosed in parenthesis.

OWNER or AGENT	ABST.#	ORIGINAL GRANTEE	ACRES	COUNTY
Adamson, L.	358	Jay (or Jocy), Geo.	320	Denton
Aldredge, J.R.	367	Howard, Jos.	62	Dallas
Allen, Jthn.	505	Pizano, Elizano	2800	Denton
" V.H.	-	Brown, Crawford	320	Tarrant
" "	-	Cook, H.	160	Denton
Bain, Arma M.	421	Mahurum, Thos.	212	Fannin
" K.	-	Bubu, Jo.	160	Wise
" "	-	Rogers, John	320	"
Barnell, Frank	451	Morrison, J.P.)	244	Grayson
" "	389	Langston, Jas.)	-	-
" "	457	Morrison, J.P.)	140	Grayson
" "	389	Langston, Jas.)	-	-
" G.W.	420	McBride, M.	288	Denton
Bateman, E.	-	Adamson, L.	80	"
Berry, Alex. agt.	139	Caldwell, W.	320	Dallas
" , Fitzhugh F.	152	Parks, E. K.	"	"
" "	370	Hughs, Jas.	15	"
" adm. Wetsel D.	-	-	-	Young
Beverly, Wm.	367	Howard, Jas.	200	Dallas
" "	68 2	Moore, Jose.	295	Dallas
(corrected to)	161			
Blanton, C. W.	-	McCoy (McCary?) M.B.	90	Parker
" "	-	Fleming, E. A.	160	"
Bounds, C. W.	813	Gude, E.	14	Denton
Boon, T.C.	71	Collom, C. M.	2214	Bowie
Boron, Jno. G.	384	Luper, Peter	148	Grayson
Bowman, J.D.	-	Secrest, Fielding	213 1/3	Dallas
" "	280	Edwards, Jas.	565	Dallas
Bounds, W. J.	813	Gude, E.	14	Denton
Brinlee, Hiram	197	Brinlee, Hiram	226	Montague
Brown, T.S.	674	Wheeler, Thos.	90	Grayson
Bumpass, J.K. (line drawn through)	-		-	Hopkins
Buck, W. F.	71	T.E. & L. Co.	320	Throckmorton
" O.E. Agt.	32	"	"	"
" "	988	"	"	"
" "	12	"	"	Palo Pinto
" "	9	"	"	" "
" "	408	"	"	Jack
" "	244	"	"	Archer
Carr, R. B.	38	Burleson, A.	500	Grayson
Carr, "	82	"	480	Fannin
Chambers, E.	-	Chambers, E.	320	Dallas
(Chreelune(?), G.B.	435	Martin, G.R.	100	Denton
Coleman, A.N.	337	Musse, Nancy	500	(illegible) (Harrison?)

OWNER or AGENT	ABST.#	ORIGINAL GRANTEE	ACRES	COUNTY
Hedgecoxe, O., agt	36	T.E. & L. Co.	320	Throckmorton
(? Gerchwin, May et.)	73	"	"	"
-	234	"	320	Young
-	14	T.E. & L. Co.	320	Young
-	746	"	"	"
-	7	"	"	Palo Pinto
-	280	"	320	Baylor
Hedgecoxe, O.agt.	813	"	"	Shackleford
" , F.G.	790	"	"	Young
"	75	"	"	Throckmorton
"	13	"	"	Palo Pinto
"	6	"	"	"
"	61	"	"	Clay
"	19	"	"	"
"	881	"	"	"
"	147	Gilbert, Dan	40	Stephens
" , O.exec.	304	T.E. & L.	320	Travis
Hedgecoxe, H.O. desc.	1140	"	"	Young
"	1141	"	265	"
"	1142	"	"	"
"	492	"	"	Jack
"	534	"	"	"
"	533	"	"	"
"	489	"	"	Shackleford
"	488	"	"	"
"	396	"	"	Stephens
"	399	"	"	"
"	506	"	"	"
"	575	"	"	"
"	807	"	"	"
"	299	Speer, Geo. W.	15	Travis
Hedgecoxe, O.guard	-	"	"	"
" H.O. Jr.	305	T.E. & L. Co.	320	Young
" O. agt.	13	"	"	Archer
" Harrison G.	15	"	"	"
"	14	"	"	"
"	65	"	"	Montague
"	531	"	"	Stephens
"	57	"	"	"
"	276	"	"	Young
"	523	Scott, Jthn. P.	"	"
Hedgecoxe, O. agt.	55	T.E. & L. Co.	"	Palo Pinto
for Stacy, H.M.	-	"	-	-
"	729	"	"	Young
"	205	"	"	"
"	60	"	"	Throckmorton
"	966	"	"	"
"	55	"	"	Archer
"	95	"	"	Stephens
Hedgecox, R.F.	97	"	"	Shackleford
"	261	"	"	Stephens
"	86	"	"	Baylor
"	208	"	"	Clay
"	111	"	"	Montague
"	517	"	"	Young

OWNER or AGENT	ABST.#	ORIGINAL GRANTEE	ACRES	COUNTY
Hedgecox, R.F.	148	T.E. & L. Co.	320	Callahan
"	239	Hedgecox, R.F.	245	Denton
Henderson, W.R.	-	McKinnus, J.	25	Grayson
Herdon, G.	350	Jones, Murcella	100	Denton
Herring, D.	367	Howard, Jas.	220	Dallas
Heustis, Henry	143	Cook, H.	40	Denton
"	115	Harper, H.	47	Denton
Hubbard, W.	-	Winn, M.S. asn.	40	"
Huffman, John	157	Chowning, L.	80	"
"	187	Clack, L.	600	"
"	876	McNeil, L.H.	245	"
"	129	Cox, J.W.	143	"
Hull, (U.?) E.	-	Digby, T. asn.	320	Fannin
"	-	Recey, John	476	"
"	-	Chenowith, (W.?)	640	"
"	-	Dayley, W.B.	320	"
Johnson, John	309	Liddy, Francis	320	Parker
"	288	Herdin, Jas.	107	"
Jones, J.P. agt. of Jones, W.W. of Boyd, Thos.	637 475 594	Tucker, H. Roberts, S.R. Springer, E.F.	135 137 320	Denton " "
Jones, W.W. agt of Scott & Goff	- - -	Witt, W.W. Hobbs, Jas. Specks	160 170 160	" Dallas Denton
Kalfus, J.E.	-	Gilbert, J.	640	Johnson & Hill
Kelly, J.L.	255	Gibson, Levan	160	Grayson
Kennedy, T.G.	320	Kennedy, Geo.	640	Lamar
Kepler, G.W.	746	McDonald, C.B.	80	Hunt
Kerr, A.J.	-	Kerr, A.J.	160	Fannin
"	-	"	385	"
Klepper, Jo	367	Howard, Jas.	107	Dallas
Kno(x?), Josh.	60	Briscoe, J.R.	96	Kaufman
Lansford, M.S.	411	Mathewes, W.C.	320	Tarrant
" L.P.	-	Wilson, Jo. E.	"	"
Leslie, J.L.	25	Hardin, H.	8 6/10	Grayson
Lyday, H.R. agt.) Ruel, F.B.	-	Hunt, Elizer	344	Hunt
Mahon, Thos.	71	Collom, C.M.	967	Bowie
"	232	Mahon, Thos.	320	"
Martin, J.B.	455	Martin, G.R.	100	Denton
"	141	Cook D.	80	"
Mathews, W.G.	-	Casey, John	260	Dallas
McCarty, Wm.	659	Moore, J.F.	33	"
"	540	Stine, J.W.	541½	Kaufman
McKinney, Wm.	201	McKinney, Wm.	956	Red River
"	565	Runnells, W.D.	426	Fannin
" agt. of Dooley	101	Dooley, Geo.	1502	Cook
"	51	"	800	Montague
McMinn, Jo.	-	Majors, J.P.	716	Lamar
" at of William, M.J.	-	"	177	"
Millis, H.B.	457	"	352	Denton
"	455	Minton, G.R.	100	"
" Wm.	553	Ritter, Wm.	24½	"
Moore, M.	-	Bounds, J.W.	90	"
Nelson, (Jm.?) D. adm Bogard, Sam	895 94	Norwood, (D.) E. Holman, J.W.	267 369	" Madison

OWNER or AGENT	ABST.#	ORIGINAL GRANTEE	ACRES	COUNTY
Newsom (I.) D.	533	Slack, D.W.	491	Hunt & Fannin
Oglesby, L.W.	171	Cook, W.W.	280	Dallas
"	161	Chenowith, Jas.	57½	"
Pace, J.H. adm. of Witt, E.W.	302	Hodges, H.M.	160	Fannin
Patterson, Jas.	405	Pew, John	244	Lamar
" Wm.	409	Patterson, Wm.	160	Parker
Phillip, J.	71	Blum(well), W.	120	Grayson
"	72	"	206	"
"	483	Nix, B.	40	"
"	-	Dsuart(Dysart?)E.	320	Denton
Peques, G.H.	720	Peques, W.S.	"	Dallas
" , H.M.)	744	Vail, Hiram	160	Dallas
" G.W.)				
& Young, F.L.				
Partman, Geo.	736	Partman, Clayton	264	Grayson
" , W.A.	"	"	"	"
Potter, B.F.	171	McHall, Levin	320	Wise
Pugh, John by adm. Getcher (fish)	711	Hart, W.R.	218	Hunt
"	363	Murphy, A.	750	Lamar
"	405	Pew, Jno.	1053	"
Pulliam, M.S. (or L.)	722	Pulliam, M.S. (or L.)	166	Dallas
"	734	" W.W.	"	"
"	1196	"	77½	"
" P.E.	797	Pulliam, M.D.	10	Hunt
"	801	"	83	"
"	796	"	72½	"
"	802	"	60	"
"	794	"	31	"
"	799	"	22½	"
"	793	"	18 3/4	"
"	795	"	(83)	"
"	800	"	93	"
"	792	"	127	"
"	37	Byantim, L.M.	83	"
Pulliam, P.E.	-	B.B.B.&C.R.R.Co.	640	Wise
"	-	Wood, Sam W.	437	"
"	877	MacNiel, W.J.	160	Denton
"	-	Hawkins, W.	160	"
"	-	Haynes, J.W.	136½	Dallas
"	-	"	52½	"
"	-	Swam, G.A.	152	Fannin
"	499	Saddler, W.L.	160	Lamar
"	46	(Baslyne), Jas.	151½	Van Zant
Pullin, Peter E.	427	Gray, F.M.	320	Grayson
Purcell, I.F.	-	Anderson, D.	35	Denton
(Rensulur) P.W.	-	Bridges, J.	30	Denton
Rhea, W.A. & J.C.	-	Smith, N.	640	Grayson
Rigg(h), Jacob (Rounelle), R.F.	325	Hardin, W.	23½	"
Rogers, B.L.	507	Williams, M.	822	Hopkins
"	381	Keenan, C.G.	25	Denton
" , Clayton	441	McNeil, Wm.	34	"
" J.B.	942	Woodward, F.	160	"
" J.R.	-	Rogers, Jn. B.	"	"

OWNER or AGENT	ABST.#	ORIGINAL GRANTEE	ACRES	COUNTY
Routh, Jacob	136	Crist, Dan	382	Dallas
" Levin	501	Pollard, F.H.	80	Dallas
" Nancy, A.	367	Haward, Jas.	13	Dallas
Sachee, Wm.	857	Sachee, E.	320	"
" "	1212	Spoon, Jas.	160	"
" agt. Ramsey, H.	783	Ramsey, Isaac	501	"
"	784	"	139	"
Scuff, Richd.	565	Wilmoth, J.A.	160	Parker
Shelburn, B.(L.)	350	Jones, Nile	25	Denton
Shirley, Albert	385	Lorying, J.L.	320	Grayson
" Lewis	881	T.E. & L.Co.	"	Young
"	481	"	"	Throckmorton
"	502	"	"	Stephens
"	178	"	"	Young
Shirt, Jesse	506	Skiles, Harvie	"	Lamar
"	-	Carr, Wm.	"	"
"	294	Cole, J.W.	"	Wise
Simpson, G.W.	-	-	"	Dallas
Smith, C.S.	728	(Emmons) G.B.	32	Denton
"	-	Hackis, E.	160	"
Snodgrass, Jo	813	Gude, E.	25	"
Stallcup, Thos.	-	-	-	-
Stelzer, Murtro	-	Aldridge, W.	30	Denton
"	150	Graham, J.	160	"
Stennett, J.A.	118	Crigger, Wm.	11	Grayson
Stuart, Jas.	640	Spruce, J.P.	100	Fannin
"	567	Payton, M.A.	140	"
Tanner, B.M. by Franklin, J.W. agt.	-	Overton, J.M.	640	Dallas
Thompson, W.N.	455	Martin, G.R.	20	Denton
Throckmorton, J.W.	-	Watson, Carey	80	"
" & Dickson	720	William(son), J.	640	"
" "	798	Emmons, C.	206	"
"	87	Bridges, Jno.W.	640	Grayson
Townsend, J.W.	-	Simmons, Mary	160	Kaufman
Tucker, W.W.	-	Tucker, W.	440	Denton
"	-	James, C.	200	"
"	-	" "	70	"
Tuckerville, J.B.	599	Sutton, U.R.	36	"
Vance, F.J.	367	Haward, Jas.	100	Dallas
Waddill, R.L.	132	Miller, A.J.	1420	Montague
Warden, Jn. Sr.	97	Brown, John	100	Grayson
White, Geo.	1069	Curtis, J.W.	288	Dallas
"	376	B.B.B. & C.R.R. Co.	640	Archer
" agt.	386	Lynden, A.H.	1457	Denton
" for Hopkins, E.H.	387	Lynden, A.H.	19	"
"	412	"	1456	"
"	414	"	640	Montague
" , Geo. adm	132	Miller, J.J.	500	"
" for Hall, J.J.	-	-	-	-
" , Geo. agt.	83	Throckmorton, J.W.	32	Young
" for Throckmorton	86	Wash., S.A.	32	"
and others	87	"	32	"
"	66	McCoy, S.D.	32	"
"	1086	White, D.C.	600	"

OWNER or AGENT	ABST.#	ORIGINAL GRANTEE	ACRES	COUNTY
White, Geo. agt. for Throckmorton and others				
"	1089	White, D.C.	40	Young
White, Matthew	381	Kellum, C.G.	160	Denton
"	144	Cassady, T.	50	Denton
Wilkinson, M.	146	Cooper, Alex.	160	"
Wilkins, S.J.	367	Howard, Jas	10	Dallas
"	602	Mounds, J.W.	18	"
" Jas.C.	-	Gross(Cross), Sarah	921	Grayson
" Lee	225	Gibson, L.	120	"
" A.	670	Wilson, D.	80	"
" "	104	Frazier, Chs.	222	Wise
Wilson, T.B.	105	" "	822	"
Winn, M.J.	172	Cockron, W.	280	Denton
Wysong, C.W.	452	Riley, Jacob	320	Johnson

Correction - Collins Family Record

by Mrs. Dorothy E. Stimson
226 Middlebury Drive
San Antonio, Texas 78217

Copied directly from Family Bible.

Deaths

Albert Benjamin Collins son of Anderson Bov'd and Susan Ny Collins died Decr. 19th, 1854 Aged 10 months	A. B. Collins Died June 30, 1906 Aged 82 years, 1 month & 22 days
Sam B. Collins Died July 20, 1922	Susan N. Collins Died March 1st, 1918 Aged 82 years 2 months 17 days
Sarah Alice Stewart (nee Collins) Died Nov. 23rd, 1927 - 6 P.M.	

THE DALLAS HERALD
(Issue of 12 July 1856)

Though I do not abstract the front news pages of the paper, it is harder and harder to pass them by, for in 1856 history is in the making. The Herald's position is hardening; they despise the Republican Fremont and cannot mention the name of a northern state without a sneer. The Civil War is coming closer.

Various Counties

The following gentlemen are requested to act as agents for the Herald and are authorized to receive and receipt for subscriptions, advertisements, etc.

M. P. Everts, Lancaster, Dallas Co., George Wilson, Cedar Hill, Dallas Co., Capt. W. Quail, Birdville, Tarrant Co., Dr. C. M. Peak (?) and Julius Field, Ft. Worth, Tarrant Co., John L. Lovejoy, McKinney, Collin Co., John H. Prince, Weatherford, Parker Co., Jas. T. Hayes, Kaufman, Kaufman Co., J.O. Heath, Black Hill, Kaufman Co., E. W. Rogers, Waxahatchie, Ellis Co., Guy Stages (?) and Henry Trimble, Chambers Creek, Ellis Co., B.P. Smith, Sherman, Grayson Co., A. Beaton, Esq., Corsicana, Navarro Co., Jas. T. Lee, Porters Bluff, Navarro, A.P. Lloyd, Alton, Denton Co., S. S. Weaver, Gainesville, Cook Co., H. K. Latimer, Clarkesville, Red River Co., S. M. Dalton, Post Master, Palestine, A. T. Howell, Esq., Greenville, Hunt Co., Allen, Bagby & Co., Houston, Harris Co.

Dallas Co.

R. Warren Stone is selling his residence in Dallas.

At April Term, Wm. C. Hunnicut was appointed Administrator of the estate of John Beeman, Dec'd.

The Colony Certificate of Peters Colony issued to James Vance is lost. (Signed) Jacob Routh

Denton Co.

Animal taken up by Caswell Hall in Precinct #3 and estrayed before E. P. Lusk, J.P.

Animal taken up by C.C. Dickson and estrayed before E. Grace, Precinct #4.

Animal taken up by E.A. Orr and estrayed before S. A. Venters, J.P., Precinct #1.

Ellis Co.

Animal taken up by J. H. Hill and estrayed before J. B. Meridith, J.P.

Animal taken up by S. W. Buelay and estrayed before J. B. Meridith, J.P.

Animal taken up by R. W. Watson, one of the Commissioners of Ellis Co.

Tarrant Co.

Two mules have strayed from M. T. Johnson, living at Johnson's Station.

Issue of 26 July 1856

Collin Co.

A. H. Martin and R. C. Whisenant are summoned to appear in court to answer the complaint of J. G. Hise and A. Howard, Administrator and Administratrix of the estate of J. Howard, dec'd, in the case of debt, due by note of \$38., due 13 April 1856. (Signed) T. G. Kennedy, J.P., Acting J.P., Precinct #5.

A similar notice to G. W. Seabourne and P. C. Whisenant, who owe \$29.50.

A similar notice to T. R. Bowen and R. C. Whisenant who owe \$50.50.
A notice for Henry Newman to appear to answer the petition of James W. Bullock. Bullock holds two notes of Bullocks on which judgement is asked. Newman gave Bullock a mortgage on 50 acres of land in Collin Co., a part of the D. Anglin survey, Bullock prays that said mortgage be foreclosed and the land sold to pay said debt, interest and cost.
A similar notice that Alexander Horton is owed \$207.00 by Henry Newman. Horton holds a mortgage for 100 acres of land.

Dallas Co.

J.G. Lynch advertises he has near 200 brood mares and young mules. "I shall remain a week or two within a few miles of Dallas, East."
George H. Pegues took letters of Administration on the estate of F. S. Young, Dec'd.
Animal taken by M.P. Heffingum, estrayed before A. Beard, J.P.
Animal taken by Pleasant Taylor, estrayed before J. Porter, J.P.
Animal taken by G. F. Porter, estrayed before J. Porter, J.P.
Animal taken by James A. Smith, estrayed before T.C. Hawpe, appraised by John Howell and J. L. Smith.

Ellis Co.

Animal taken by J.R. Hill, estrayed before J.B. Meredith, J.P.
Animal taken by J.W. Bosley, estrayed before J.B. Meredith, J.P.
Animal taken by Thomas Jackson, estrayed before Wm. C. Sweatt, J.P.
Animal taken by R.W. Watson one of the Commissions of Ellis Co.

Johnson Co.

Animal taken by John P. Stewart, estrayed before John J. Reece, J.P.

McLennan Co. (Probably)

A fatal recounter occurred in this county about 18 miles S.W. of Waco on the 10th inst. between Joseph Hardin and his brother-in-law James M. Hardin which resulted in the almost instant death of James M. Hardin. Joseph Hardin shooting him in the left breast with one barrel of his gun and lowed down in the body with the other. Joseph Hardin surrendered himself to the proper authorities and after a full investigation the Justice of the Peace discharged him upon the grounds of his having acted in self-defence in the killing. (Taken from the Waco Statesman).

Tarrant Co.

Animal taken up by Wm. Gwinnett, living in S.W. corner of Tarrant, estrayed before Silas Estes, J.P.

Animal taken up by John Burnett living in the Cross Timbers, north of the west fork of the Trinity in Tarrant, appraised before A. Jasper, J.P.

Issue of 2 Aug. 1856 - Cook Co.

John Chromister of Cook Co. states that he was married to Lucy Ann McElroy on 29 July 1855 and that in the Sept. following the said Lucy Ann abandoned his bed and board, without any just cause, absenting herself from the State of Texas, that previous to said abandonment her conduct was outrageous in the extreme, and her cruel treatment to him..such that he suffered great mortification, injury and chagrin..and their living together is now insupportable. He prays for a decree of divorce, "a vincula matrimonii" from the said Lucy Ann Chromister, her residence being to him unknown.

Dallas Co.

John L. Fletcher appointed Administrator of the estate of Russell Fletcher, dec'd.

NEWS ITEMS FROM THE BOARD

We want to thank everyone who sent in their questionnaire and realize that we did not make it easy for you since we did not give you a return address. We really haven't had enough returns to feel confident of what the members want and we would appreciate it if you would fill it out and return it to: Mrs. J. R. Macdonald, 6415 Meadow Rd., Dallas, 75230. Fragmentary returns show no big changes desired, the Quarterly read from cover to cover, and interest in a trip to Austin.

* * * *

At least two members of the Society have recently bought microfilm readers and installed in their homes and both members are very enthusiastic. One new model can be used with an over-head light on. Complete census films through 1870, many of 1880 and a considerable number of books on microfilm are available from the Southwestern Genealogical Library, 3651 Douglas, El Paso, 79903. Send them a self-addressed, stamped envelope and ask for details. Have you run into the abbreviation, SAE, meaning Stamped, Addressed Envelope? It took a while to figure this out.

* * * *

Mr. Don Corbett, who has spoken twice to the Society, tells us that the LDS Library is planning on getting more microfilm readers at their library. This is a library where books are microfilms which have to be ordered from Salt Lake City. They have on microfilm many and various records, especially the invaluable county records. The library is at 1 Turtle Creek Village on Oak Lawn Ave.

* * * *

There are a number of places other than the Texas History and Genealogy Dept. where you can do research in Dallas. S.M.U.'s Fondren Library has a certain number of books that are of genealogical interest. They won't allow you to take them out, but you may go into the stacks and browse. The Bridwell Library, which is the theological library for S.M.U., has its own building. The upper floor, (go up the stairs) is devoted to Methodist History and has information on other denominations. The Librarian there is marvellously knowledgeable and very helpful.

Mr. J. B. Latimer, a past-president of the LH&GS, was named Assistant Governor General of the Mayflower Society in 1969. The Mayflower Society, which publishes an attractive Quarterly, is for those who had an ancestor on the Mayflower. At one of our society meetings Mr. Latimer told of recently being able to purchase a copy of a book written by one of his ancestors, Capt. John Mason, who d. 30 Jan. 1671-2!

* * * *

If there is a book that you absolutely have to have and can not find through any of the usual ways, did you know that you can have a copy made for you by University Microfilms, Ann Arbor, Michigan? It is a long slow process for the company first gets permission (if possible) and then has to find a copy of the book you want. If you know where a copy is, this would possibly speed things up. The pages are printed on double pages; the book is neatly bound in a soft cover with a name label on the front. The price depends on the number of pages. It is not cheap, but it is cheaper than a very scarce or rare copy. Mrs. Boykin has several catalogs listing books already available without special search.

* * * *

The Genealogical Courses which we co-sponsor with El Centro are over for the year and will not be repeated in the spring of 1971. Both the Beginning and the Level II Courses had about 35 members. Mrs. A. E. Lush and Mr. W. R. Conger taught the Level II; Mrs. Ben Dickson and Mr. Will F. Lourance the Beginners.

* * * *

Bereniece Jackson Bonner of the Society had an article in the December 1969 issue of our Quarterly titled, Fringe Benefits from Genealogy. A first section of it was published in the September "Genealogical Helper" and will continue in the next issue. This is quite an honor for Mrs. Bonner.

* * * *

By the time this issue is printed we will have a new President, a new Editor and some other new Board Members. Without the members who are willing to serve in time consuming and demanding jobs, there would be no Society, no meetings, no Quarterly, and no Workshop. Mr. Herschel Anderson, who has been President for two years, has served the Society well and deserves our thanks. One of our most ardent researchers, he will appreciate having time now to work on his own lines. Mrs. R. E. (Nelle) Dishman has been Editor of the Quarterly for three years and has put out four issues a year. It is a great compliment to her that so many of you expressed such enthusiasm for the magazine.

* * * * *

FROM: Mrs. Arthur Prestridge
3728 Park Lane
Dallas 20, Texas

Information sought on Harris RAWLS born S.C.? m. Sept. 1803 Richland Co. S.C. died 1837, Pike, Miss. Married Annie COON, born S.C. died about 1852. Who were their parents, brothers and sisters? They acquired passports to Miss. 1810 with two children. Settled Pike Co., Miss.

Information sought on John HODGE came to S.C. from Ireland, married Sally GREEN about 1823, returned to Ireland for son ? HODGE, born about 1818 by first wife. What was ? HODGE and mother's name? John HODGE killed by sister-in-law in S.C., about 1828. ? HODGE deserted by step-mother in S.C., when family migrated to Miss. Sally Green HODGE and five children migrated to Miss., with Allen and Polly GREEN, (parents of Salley Green HODGE).

* * * * *

BROWN, STEWART, DRISKILL, DEAN
STREET, COSGROVE, SHUMAN, WHITE, FERRELL, SCOTT, FORREST, STOKES

MRS. JOE R. (BETTY) STREET
3603 Vinecrest
Dallas, Texas 75229

* * * * *

NEWLY ELECTED OFFICERS AND DIRECTORS FOR 1971

Newly elected Officers and Directors of the Local History Genealogical Society for 1971 are listed below:

President Dr. Ben Lewis Smith, Jr.

Executive Vice President Mr. Levi A. Busby

Vice Presidents:

Program

Publication-Editor Mrs. James R. Macdonald

Communication Mrs. Jack A. Morris, Jr.

Membership Mrs. Duane C. Cleere

Treasurer

Directors at Large:

Mr. H. G. Askew

Mrs. Lucile Anderson Boykin

Mrs. A. E. Lush

Mrs. Harold C. McCrary

Mrs. Margaret Pratt

Mrs. Arthur Prestridge

Mrs. Thomas S. Walker

Replacement Directors At Large:

Mrs. Shelton H. Bricker

Mrs. R. K. Butler

Mrs. Lowell Cansler, Jr.

Mrs. W. Graeme Dixon

Miss Dorothy O. Sparrow

BY-LAWS - LOCAL HISTORY & GENEALOGICAL SOCIETY, DALLAS, TEXAS
ARTICLE III - MEMBERSHIP

- Section 1. Membership is open to any person interested in subscribing to the purpose of the Society, who submits a written application for membership to the Vice President in Charge of Membership, accompanied by payment of annual dues.
- Section 2. Membership shall be effective on a calendar year basis following acceptance of the membership application by the Vice President in Charge of Membership and/or acceptance of annual dues by the Treasurer.
- Section 3. Annual dues of one person or two persons within the same household who share one mailing of communications and publications of the Society shall be \$6.00 per annum payable before the 1st day of March. Dues received prior to September 1 shall be retroactive to January 1 with regard to publications. Dues received on or after September 1 shall be credited as the next year's dues. Should publications not be available to make the receipt of publications retroactive, then the dues shall be pro-rated on a quarterly basis at \$1.50 per quarter, and a refund made for publications not available.
- Section 4. With a contribution of \$9.00, along with the payment of \$6.00 annual dues, a member shall be recognized as a Sustaining Member for that year. With a contribution of \$19.00, along with the payment of \$6.00 annual dues, a member shall be recognized as a Patron Member for that year.
- Section 5. With a contribution of \$100.00, along with the payment of \$6.00 annual dues, a member shall become a Life Member of the Society, and shall thereafter be exempt from the payment of annual dues. During the life of the Life Member, the \$100.00 shall be placed on deposit in a Special Savings Account of the Society with the interest available in lieu of dues, for use by the Society. Upon the death of the Life Member, the \$100.00 shall accrue to the Society, to be used for such purpose as the Society shall direct. Should the Society be disbanded, the \$100.00 shall accrue to the general assets of the Society, to be disposed of as the Board of Directors direct.
- Section 6. An Honorary Membership of one year duration for some special service to the Society may be conferred by majority recommendation of the Board and majority vote of the membership in attendance at a meeting.
- Section 7. An Honorary Life Membership for outstanding service to the Society may be conferred by unanimous recommendation of the Board and majority vote of the membership in attendance at a meeting. An Honorary Life Member shall be exempt from the payment of annual dues.

PLEASE SEND YOUR 1971 DUES TO THE VICE-PRESIDENT MEMBERSHIP:

Mrs. Duane C. Cleere
1820 North Beltline Road
Irving, Texas 75060
Telephone: 252-2505

INDEX TO VOLUME XV, NUMBERS ONE, TWO, THREE, FOUR
OF THE QUARTERLY
1969

First name indicates issue, additional numbers are page numbers in that issue.
Issues are separated by symbols //.

NAME	ISSUE & PAGE	NAME	ISSUE & PAGE
Abernathy	4-25	Becket	1-4
Adams	3-13,14,15,16,17,23	Beckwith	4-8
Addison	3-20	Beeler	1-4,5
Akers	4-7,8	Behrens	2-10
Aldredge	3-37	Bell	1-5//2-17//4-25
Alexander	1-4//2-9//3-8,18	Benham	3-21
Allen	3-10//4-30	Bennett	3-2
Amis	4-24	Berry	2-25//3-10//4-6
Anderson	2-9,10//3-8,9,18 //4-12,13	Bestwell	2-8
Apperson	4-5	Betts	3-19
Applewhite	3-20	Bevill	2-39
Archer	4-20	Biggs	3-44
Armistead	4-20	Binkley	4-6
Armstrong	1-5	Birchfield	2-38
Arnold	4-31	Bird	3-2
Ash	4-6	Birdwell	4-25
Ashby	3-18	Black	3-9
Ashmore	3-37	Blackmore	1-5//3-42
Ashton	1-4	Blackwell	3-18
Atkins	3-18	Blanton	3-5,39
Atterbury	2-3	Blair	1-41
Ausberger	1-4	Blake	3-19
Austin	2-18	Blanks	4-11
Avery	4-23	Blubaugh	3-40
Ayres	4-20	Boatwright	2-29//3-36,44
		Boddy	4-5
Babb	3-44	Boone	4-31
Baggett	2-28//3-10	Booker	3-11//4-20
Bailey	3-10	Booth	1-5
Baird	1-5//2-16,25	Borin	2-25
Baker	3-19, 42//4-31	Boring	3-18
Balchmyer	2-25	Bostick	2-25
Ballard	3-20	Boswell	3-18
Ballew	3-2	Bottomly	3-18
Barber	3-33	Boughton	2-2
Barclay	4-7	Bouinich	3-35
Barksdale	2-38//4-20	Bouldin	4-20
Barney	3-9	Boulay	1-2
Bascom	3-18	Bourgeois	1-2
Bassett	3-7//4-31	Bousman	1-4,5
Bates	3-10	Bowyer	1-4
Bauer	4-20	Boyd	3-19
Bawelling	4-6	Boyle	3-18
Bean	4-20	Bradley	3-8,9//4-6
Beard	3-9	Bradshaw	2-25
Beck	3-39	Bradstreet	2-2
		Braisure	2-36,37

NAME	ISSUE & PAGE	NAME	ISSUE & PAGE
Brantley	4-7	Carrington	1-7
Brandon	3-2	Carroll	2-36, 38, 39//4-7
Brasher	4-31	Carson	3-18//4-6
Brennan	2-18	Carter	3-9, 18
Bressard	1-2	Cash	3-5, 43
Bressie	4-11	Castleman	1-5
Brewer	3-37	Cater	2-19
Bright	2-26	Caudill	3-22
Brocheart	1-2	Cecil	3-41
Brotherton	3-10	Chamberlayne	1-35
Browder	3-9	Chapman	4-5, 24, 25
Brown	1-4, 7//2-2, 9, 16, 17, 38//3-2, 7//4-12, 23	Cheaney	3-24
Browning	4-29	Cheatham	3-24
Bruen	4-31	Chenowith	2-2, 3
Brumfield	1-5	Chester	4-29, 30
Brumley	4-6	Chew	1-5
Brunette	1-2	Childers	4-25
Bryan	2-22	Chrisman	3-40
Bryant	4-24	Christian	1-2, 4//3-20
Buchanan	2-29	Christmas	4-20
Buford	4-25	Christy	1-4
Bullock	4-25	Claire	2-19
Bumpass	3-18	Clark	2-2, 5, 16, 40 //4-6, 20, 25
Burdine	3-43	Claypool	2-8
Burford	2-25//4-6	Cleane	3-29//4-22
Burke	4-22	Coburn	3-9
Burkett	2-8	Cochran	4-20, 31
Burkhart	3-20	Cock	3-30
Burt	4-31	Coffey	3-8
Burton	3-33	Cole	2-28//3-5, 29, 30 //4-6, 12, 13, 21
Burrow	2-7, 45	Coleman	2-16
Bussen	1-2	Colin	1-2
Butler	1-5//2-9//4-22	Collier	4-26
Buttram	4-22	Collins	3-18, 30//4-11, 24, 26
Byard	3-9	Colvin	1-4//3-33
Byers	1-41	Combs	3-38
Bynum	4-29	Come	1-2
Caddell	2-22, 23//4-30	Comly	2-25
Caldwell	4-7, 8	Connally	1-4
Callahan	4-6	Conner	4-24
Callaway	3-19	Constable	2-3
Campbell	1-4//3-18, 40 //4-25, 31	Converse	4-20
Canfield	3-7	Cook	1-4, 5//2-28//4-7
Cannon	1-4	Cooke	3-37
Cantrell	3-30	Cooper	3-5
Capers	3-18	Corcoran	3-9
Capes	3-18	Cotmer	2-27
Cappio	1-2	Coulter	1-5
Carmack	2-9	Cowan	1-39, 40, 41, 42//2-27
Carpenter	1-5//2-25//3-27	Cox	1-4//3-5, 21, 40//4-23, 24
Carr	4-6	Cozart	1-40
		Crabb	2-9

NAME	ISSUE & PAGE	NAME	ISSUE & PAGE
Crabtree	3-4	Dodson	1-6
Crafton	2-18	Doggett	3-18
Craig	1-4	Donaldson	2-25//3-10
Cravens	2-24,26	Dorein	1-4
Crawford	1-4//3-18	Dorman	3-19
Creckett	2-24	Doty	3-18
Creel	3-8	Doub	3-18
Creighton	4-29	Dougherty	3-43
Cresap	1-5	Douglas	1-4
Cretin	1-2	Dousman	1-5
Crisset	1-2	Drake	3-18
Crockett	2-26//3-9	Drane	2-26
Croghan	1-4	Draper	2-18
Crooke	1-4	Driskell	3-18
Crooks	1-5	Dudley	3-9//4-25
Crouch	3-18	Duff	3-40
Crowder	3-18	Dugger	5-23
Crown	3-37	Duke	2-16
Crozier	4-20	Dumas	3- 8
Crutcher	3-24	Dupot	1-2
Curan	3-37	Durant	3-20
Cureton	4-22	Dutton	3-11
Cullar	2-8	Duverney	4-8
Cumberford	1-5		
Curry	3-2	Eakins	3-9
		Early	3-18
Dabkowski	2-39	Earnest	4-6
Dade	4-20	Easton	3-9
D'Alton	1-5	Ecord	2-29
Danforth	3-10	Echols	4-22
Davie	4-11	Eddleman	4-6
Davis	1-5//3-8,18,31,43	Edgar	2-9
David	2-23	Edwards	3-18
Davidson	1-4	Egan	2-27
Dawson	3-2	Egger	3-27
Deems	3-18	Elam	3-24
Deering	3-18	Elkins	4-5
Decker	1-4	Eller	2-27
Delasseaux	1-2	Elliott	1-5,40//3-30
Delore	1-2	Ellis	2-29//3-37
Denton	2-8,9//4-5	Ellison	3-18
Deupree	3-24,25	Elroy	1-4
Devore	1-5	Emery	2-27
DeWeese	2-28	Engelking	2-27
Dexter	1-4	Eppes	2-27
Dibrell	3-18	Epperheart	3-5
Dickinson	1-4//3-42,43,44	Epperson	2-27
Dickson	3-10	Erskine	2-27
Dillard	2-18	Ervin	2-28//3-43,44
Dinfields	1-4	Erwin	1-5//2-28
Divine	4-30	Estes	2-28
Dixon	3-19	Estill	2-28
Dobbins	2-27	Eschbach	2-28
Dobyns	2-2	Estridge	2-28

NAME	ISSUE & PAGE	NAME	ISSUE & PAGE
Etheredge	2-28	Fomby	4-28
Eticer	2-28	Foraker	4-27
Etter	2-29	Foard	4-26,27
Etzler	2-29	Ford	4-26,27//2-46
Eubank	2-29	Forde	2-10
Evan-Evans	2-29,30//3-5,18,20	Fore	4-27
Everette	2-30	Foreliness	4-27,28
Everts	4-6	Foreman	4-27,28
Ewalt	1-5	Forgey	4-27,28
Ewell	2-30	Forster	3-10
Ewing	2-30	Forsythe	3-12//4-28
		Fortner	4-28
Fairley	2-26	Foster	1-42//3-37//4-28,29
Farine	1-2	Fought	4-24
Farmer	3-31	Fountain	4-29
Farr	3-31	Fouts	4-29
Farrer	3-31	Fowler	2-26//4-12,13,29
Faure-Pore	3-31	Fox	2-3//4-30
Faver	3-2	Foy	4-30
Fawbush	3-31	Frale	3-43
Fawks	3-32	Frame	4-30
Fears	3-32	France	3-7//4-30
Featherston	3-32	Francis	4-30
Fedorchak	4-27	Frank	4-31
Fellows	3-32	Franklin	3-2//4-30,31
Fender	3-32	Frantz	4-31
Feree	1-5//3-33	Fraysure	3-44
Ferrette	1-2	Frazier	2-19,20,21,22,23 //3-44//4-31
Ferguson	3-32,33	Frederick	4-6
Fewell	2-30//3-33	Freeman	1-5//3-38,39//4-31
Field	3-33,37	Fretwell	1-6
Fike	3-33	Frey	4-31
Findlay	3-34,35	Frichot	1-2
Finch	3-33,34	Friley	3-42
Fine	3-34	Frizzell	4-31
Finley	3-34,35	Frogg	1-4
Fisk	2-3	Froman	1-4
Fisler	3-35	Fugate	3-44
Fitch	3-8,35	Fuller	3-10
Fitzgerald	3-35	Fuqua	4-20
Fitzgibbons	4-22	Fyke	4-22
Flahart	3-35		
Flanary	3-21,22,23,35,40,41 42,43,44,45	Gaddis	1-5
Fleming	1-35,36//3-35	Galbreath	1-5
Fletcher	3-35,36//4-8	Gamble	2-24,26
Flinn	3-36	Gamewell	3-19
Flippen	3-36//4-26	Garden	4-23,25
Floyd	4-26	Garland	4-23
Flowers	4-26	Garrett	3-19
Flurry	4-31	Garvin	2-24
Folkes	4-26	Gatlin	2-18
Follansbee	4-26	Gibbons	2-18
Follett	2-2	Gibson	1-4

NAME	ISSUE & PAGE	NAME	ISSUE & PAGE
Giddings	3-20	Harber	4-27
Gideon	3-26	Harberger	4-5
Gilbert	4-30	Hardin	1-5
Giles	3-2	Hare	4-20
Gilkey	2-19	Hargroder	2-24
Gillispie	3-5	Haringer	4-6
Gilman	2-2, 3	Harrell	3-20
Girty	1-4	Harris	3-9, 10, 18, 37
Gists	1-4	Harrison	1-4, 5, 30//3-8, 18, 30, 37 //4-8
Glenn	3-18		
Glusing	2-28	Harrod	2-2
Goe	1-4	Hart	1-4//3-8, 10
Goetseed	1-2	Hartman	3-10
Gold	2-25	Harwell	4-23
Gooch	2-24	Haskev	3-36
Good	3-8//4-6, 22	Hatchett	3-24
Goodwin	3-20	Haught	3-8
Gordon	3-3	Hawkins	1-5//4-11
Gore	2-24	Haupe	2-26//3-9
Gose	3-43	Hawthorn	1-5
Gouffe	1-2	Haynie	3-19
Gouhenant	2-26	Hays	1-4//3-11, 19
Gould	4-20	Hazzelrigg	3-5
de Graffenreid	2-25	Heard	3-19
Graham	1-39, 40//3-41	Hearn	3-19
Grant	3-7	Heath	1-4, 5
Gratin	1-3	Hedge	1-4
Gratton	1-4	Hellums	3-2
Gray	2-24	Helsey	3-20
Greear	3-44	Helton	3-30
Green	1-39//3-18	Hembrec	4-10
Gregory	3-2-//4-11	Henderson	1-4//2-9, 31//3-18, 37
Grey	3-20	Hendricks	2-24//3-8, 9//4-6
Griffin	3-19	Henkle	3-18
Grizot	1-2	Henry	1-2//3-5
Groves	1-36	Hensell	3-10
Grumbles	3-2	Herdman	2-29
Guess	3-9//4-6	Heridon	3-42
Guillemet	1-2	Herrick	3-31
Guillott	1-2	Hickman	1-4//4-24
Gunn	3-35	Hicks	3-11, 18
Guy	2-25	Higarthy	1-5
		Hightower	4-12
Hackney	4-23	Hill	1-4, 5//3-20, 44//4-23
Hagood	2-24	Hillhouse	2-27
Haize	1-2	Hinley	1-5
Halstead	4-31	Hise	4-20
Hamill	3-18	Hobbs	3-41, 42
Hamilton	2-9, 19, 26, 28//3-19	Hoffman	2-3
Hammond	2-29	Hollister	2-18
Hampton	3-44//4-23	Holman	2-19
Haney	4-12	Hopkins	4-24, 25, 30
Hanley	2-25	Hood	3-8
Hanner	3-18	Hooker	2-31

NAME	ISSUE & PAGE	NAME	ISSUE & PAGE
Horton	2-29//3-40,44	Kellum	3-20
Hotton	4-5	Kelly	2-30
House	1-5//3-19,20	Kendall	2-3//3-5
Housley	2-9	Kenisell	4-20
Houston	4-20	Kennedy	3-10
Howard	3-2,3,40	King	3-20//4-8
Howe	4-6	Kingston	3-9
Howell	1-5//4-6	Kilgore	3-43
Hudgins	4-22	Kimbrough	3-3
Huffstetler	3-3	Kinney	4-27
Hugart	1-4	Koen	2-27
Hughes	3-18//4-24	Koger	3-41
Hull	1-5	Kolb	3-37
Huntley	3-35	Kisby	4-5
Hunter	3-18//4-31	Knox	2-9
Hutchinson	3-5,8		
Hutson	3-37	Lacy	3-18
Hutto	3-37	Lagoquey	1-2
Hyde	3-7	Lain	2-44
		Lamb	4-22
Igo	3-30	Lamberth	4-22
Innes	1-4	Lander	2-10
Innis	1-5	Lane	3-18//4-6
Irwine	1-5	Langhorne	3-18
Isbell	2-28	Lanus	3-18
		Latham	3-20
Jackson	2-24//3-8,30// 4-25,27	Latimer	2-26
Jacobs	2-16,17	Lawhorn	2-16
James	4-24,25	Lawrence	4-6,31
Jefferson	1-35	Lawson	3-30
Jenkins	3-30	Leach	2-2,3
Jennings	4-20,31	Ledbetter	2-9,24
Jessee	3-42	Lee	2-3//3-18//4-23
Jonas	3-3	Legrand	1-7
Jones	1-32,42//3-8,9,12,19, 30,35,37,40//4-10,11, 24,31	Leigh	3-18
Johns	4-20	Lemon	2-26
Johnson	2-26//3-3,7,18,37	Leonard	2-24//3-8//4-31
Johnston	2-9//3-43	LeRoy	2-3
Julianx	4-24	Lesis	3-18
		Lewis	1-26//3-3,5,18
Kamp	2-26	Lillie	3-20
Kavanaugh	3-18	Lipscomb	3-24
Kay	4-31	Little	1-41//2-8,9//3-10
Keele	3-3	Lindsey	4-22
Keeling	1-36	Lively	3-9
Keen	2-26//3-9	Livingston	2-3
Keenan	2-24	Lloyd	3-9
Keene	2-9	Lockhart	1-4//2-16//4-12,13
Keeney	2-9	Lofitis	4-11
Keithley	2-46	Logan	3-31,40,41
Keller	4-5	Long	1-4//2-9//3-39//4-7
		Lonsdale	2-36,37,38
		Lotta	3-18
		Louis	1-2

NAME	ISSUE & PAGE	NAME	ISSUE & PAGE
Love	3-37	Monroe	3-18
Loving	2-8,9	Montgomery	3-5,30//4-28
Low	3-9//4-6	Montuori	4-22
Lowden	3-40	Moody	3-18,33//4-23
Lowe	2-27	Moore	1-5,39//2-18,19//3-12, 18,36//4-11,24
Lowrey	2-9		
Lynn	1-5	Morgan	1-4
Lyons	2-8	Morehead	4-8
		Morse	4-20
Madden	3-18	Morris	2-19,30,36,39,46
Madison	1-35	Morrison	4-26
Magee	3-3	Moseley	2-16
Maggard	3-22,23	Moss	4-6
Malone	3-3	Morton	4-8,20
Mandelbaum	3-19	Mounce	1-4
Mandeul	1-2	Muchmoor	1-5
Manette	1-2	Mulliken	3-39
Mangum	3-12	Murphy	2-3,24
Manly	4-12	Murchison	3-18
Mann	3-8//4-20	Murdough	1-5
Marion	3-18	Murrah	3-19
Marlin	1-40	Murray	2-3
Marshall	3-42,43//4-3,6	Myers	1-5//2-8,9
Martin	1-5//3-18,37,44 //4-23,24,28	McAdoo	3-36
Mason	1-5	McAlister	3-18
Masten	3-8	McAllister	2-27
Massey	2-16,17//3-20	MacCallum	4-23
Matheny	3-31	McCarthy	2-2
Matthews	1-4//2-18,24//3-27 //4-29	McClenochan	1-4
Mattox	4-6	McCloud	4-20
Maury	3-37	McCombs	4-30
Mausion	1-2	McCool	2-38
Maxe	2-31	McCord	4-28
Maxie	4-23	McCoy	2-25//3-29//4-6
Mayberry	2-7	McCreary	4-31
Mayhew	4-20	McCullough	1-4
Mayo	1-36	Macdonald	2-44
May	3-36	McDeLore	1-2
Mays	2-18,19	McDonald	4-23
Mebane	3-12	McDowell	1-4//3-9
Melintick	3-40	McElroy	4-20,31
Melton	2-27	McElwaine	4-7
Merrifield	2-26//3-10	McFarland	3-18
Miller	3-10,39//4-5	McFerrin	3-18
Milward	2-44	McGillady	3-37
Minix	3-30	McGomery	3-43
Minter	3-35,37,40,41,42,43, 44,45	McGowen	3-20
Minton	3-37	McGown	3-19
Mitchell	3-18,19,20	McGuire	4-25
Modrall	2-29	McKee	1-5//4-6
Moffett	1-4	McKenzie	2-22,23//3-10
		McKinney	3-10
		McKissack	4-25

NAME	ISSUE & PAGE	NAME	ISSUE & PAGE
McKnight	2-30	Pelt	2-23
McLain	2-28	Pence	3-8
McLeod	4-25	Pendleton	3-43,44,45
McMahon	1-4//3-18,20	Pennington	3-5,21,41,42
McMurray	3-14	Penrod	4-6
McReynolds	4-7	Penticost	1-4
		Perry	2-46
Nancy	4-23	Pettibon	3-31
Nash	3-43	Pettigrew	3-13
Naylor	4-5	Pettis	4-24
Nederland	1-36	Pettus	3-31//4-23
Neeley	3-44	Pettyjohn	1-5
Neighbors	1-7	Phelps	4-27
Nevill	1-5	Phillips	4-5,24
Newton	2-25	Pierce	3-18
Nicholas	1-5//3-9,20	Pinkard	3-14,15,16,17
Nichollson	2-25//3-18,19//4-6	Pitts	2-18//3-18
Niedermaier	4-23	Poage	1-4
Noble	3-9	Polk	3-3
Nolen	2-19//3-3	Pope	2-25
North	4-31	Portat	1-2
Norton	3-20	Portevin	1-2
Nowlin	4-5	Portwood	3-24
Norwood	4-26	Powell	2-18//3-18
Nugent	3-10	Prentice	3-31
Nunnery	3-43	Price	3-31
		Pridemore	3-45
Oakley	3-5	Priot	1-2
Ogden	4-31	Pulgreen	3-37
Oliver	2-18//3-3,4	Pullen	4-24,25
Olney	3-7	Puryear	4-24
Ordway	4-25	Puyus	4-25
Ormsby	1-5		
Osborn	3-21,42,43,44,45// 4-25	Quinet	1-2
Outlaw	4-31		
Oswalt	2-40	Rabb	3-19
Owen	3-4	Ragsdale	3-10
		Ralston	3-18
Pamplen	2-4	Ramsey	2-10//3-31,42
Parker	2-26	Randle	3-18
Parks	3-18	Randolph	1-35,36//3-8
Parrish	2-25//3-11,12,13	Rapes	3-10
Parshall	4-29	Ratcliff	3-18
Parskall	4-20	Raulston	4-20
Parsons	3-42	Rawlings	2-24
Pate	4-23	Rawlins	4-5
Patterson	4-5,6	Ray	2-36,37,38,39,40//4-26
Patton	3-4,18	Raymond	3-8
Patrick	3-9	Redford	3-18
Payne	2-30//3-33	Redman	1-4//3-18
Peak	2-24,25//3-8	Redden	3-29//4-21-22
Peel	3-19	Reed	4-7
Peques	2-8	Rees	3-35
		Regan	4-6

NAME	ISSUE & PAGE	NAME	ISSUE & PAGE
Reilly	2-24	Schinter	4-5
Reinhardt	1-2	Schneider	2-17
Reiser	4-28	Schockley	4-29
Renau	3-18	Scott	1-5//3-19,38//4-5
Renoe	1-4	Scruggs	2-9
Revershaw	1-2	Scurry	3-8
Reynolds	3-9//4-25	Sellman	4-20
Richards	3-8	Senterfitt	3-4
Richardson	3-18,19,31	Shannon	3-8
Richmond	4-6	Shaw	3-8,20
Rideout	2-16	Shepherd	1-4//3-20
Riddling	2-23	Shapp	3-19
Riesu	4-28	Sheridan	4-22
Ritchie	4-11	Sherman	3-37
Robards	3-13	Sherwood	2-19
Roberts	2-24//3-12,13 //4-6,31	Shilling	2-18
Robertson	1-4,5//3-31	Shinks	2-26
Robbins	2-19//3-4	Shoemaker	2-39
Robinson	1-5//3-9//4-25	Shultz	2-2,3
Rockwell	1-37	Sigler	2-26
Rodes	4-24	Siller	3-9
Rodgers	2-26//3-18	Simms	2-38
Rogers	1-5//3-19//4-31	Simons	3-20
Roper	4-31	Simpson	1-4
Rose	1-5//4-25	Sims	3-9//4-6
Roseburg	2-29	Skaggs	3-9
Rosser	3-18	Skidmore	1-4
Ross	1-5//2-2//3-20	Skinner	4-26
Rosson	2-8	Slover	1-5
Rough	1-5	Smallman	1-4,5,7
Roya	1-2	Smith	1-4,5,41//2-2,8,9,16 //3-4,5,9,18,19,29,37 //4-6,24
Royal	3-9	Smyly	2-30
Rubble	3-18	Smyth	3-43
Rumple	1-37	Solley	2-39,40,41
Runnels	3-8	Sowell	3-33
Russell	3-20//4-22	Spafford	4-25
Rutherford	1-39	Spain	3-19
Ruthven	3-19	Speer	3-18
Rutledge	3-32	Spence	3-10
Ryan	1-5//2-22	Spencer	3-30,40,41
Sabin	3-6	Spivey	3-35
Sakelle	4-6	Stacy	4-24,25
Sample	1-5	Stacey	3-19
Sanders	2-31//4-23,31	Stanfill	4-22
Sanford	4-11	Stanton	2-30
Santerre	1-2,3	Stedman	2-30
Sargent	3-5,43	Steel	1-4
Saunders	3-8	Steele	1-39,40
Sawrie	3-18	Stephen	3-35
Sayre	2-25	Stephenson	1-4
Scarburd	3-8	Steploe	2-3
Schantoir	4-6	Stern	4-31

NAME	ISSUE & PAGE	NAME	ISSUE & PAGE
Stetson	2-9	Truslow	3-18
Stevens	1-4//3-18	Tucker	4-20
Stevenson	3-18	Turby	1-5//3-20
Steward	1-42//2-36	Turnipseed	3-37
Stewart	3-10	Turner	2-27//3-9//4-20
Stith	4-12		
Stockton	3-5	Undersood	3-9
Stokes	3-37	Urquart	2-24
Stone	2-8,26//4-5		
Stratton	3-9	Valentine	3-8
Stretcher	2-30	Vallindingram	1-4
Strewhern	4-22	Vanmetre	1-4,5
Stripling	2-19	Vannoy	2-27
Suggs	4-31	VanRensselaer	2-3
Sullivan	1-4//4-24	VanSchuyler	2-3
Summers	2-24//3-19	VanSwearengen	1-4
Sutphin	3-9	VanSycle	2-29
Suttle	4-25	Vaught	3-10
Swaffer	2-8,9,10	Vaughan	4-10
Swango	3-30	Vail	3-40
Swearingen	1-5	Veale	3-8
Sweet	1-4	Virgin	1-5
Swindle	2-25		
Swing	2-24	Waddell	4-6
		Wade	4-11
Taff	3-5	Wadsworth	3-18
Talbot	3-18	Wagner	1-5
Talley	3-19	Waldrup	3-11
Tanner	3-5	Walker	2-18,26//3-5,8,9,19,35 //4-25
Tarleton	1-36	Walle	2-30
Taylor	1-4,5//3-18,19, 20,43//4-23,24		
Teagard	1-5	Waller	6-20
Tees	1-4	Wallis	3-19
Terrell	2-24	Walls	4-23
Teter	4-20	Walter	3-33
Thevenet	1-2	Walthall	3-32
Thomas	3-5,9	Wampler	4-5
Thompson	3-43	Ward	1-4//3-30//4-5
Thornbrough	1-7//3-8	Warwick	1-5
Thornton	4-20	Watkins	3-5,18,31
Threlkheld	3-3	Waters	3-19
Tilly	4-29	Watters	2-44
Tims	3-9	Weaver	2-24//4-23
Tinnen	3-9	Webb	2-22
Tipton	3-40	Weddington	4-27
Tisinger	2-8,9	Weems	3-5
Toal	2-29,31	Welch	4-20
Tong	2-3	Wells	1-5
Townes	2-25//3-8//4-6	West	3-7//4-25
Townsend	3-20	Whaley	4-28,29
Trainer	3-18	Wheat	3-36
Trimble	3-5	Wheeler	1-5
		Whicker	3-11

NAME	ISSUE & PAGE	NAME	ISSUE & PAGE
Whipple	3-18,19	Winfrey	4-11
Whitacre	1-5//4-25	Winston	3-31
White	2-9//4-23,24	Wise	2-24//4-7
Whitefield	4-24	Wistner	1-5
Whitehead	4-22	Withers	4-27
Whitlock	1-36	Witt	2-24,25//3-29//4-21
Whitsley	3-42	Wolf	3-37
Whitt	3-40	Wolford	2-8
Whittington	2-7	Womack	3-8
Whorton	3-42	Wood	3-30,37
Wiggins	3-18	Woodruff	2-27
Wilbur	3-31	Woods	4-23
Wilburn	3-37	Woodson	3-31//4-20
Wilcox	3-6	Wooten	3-37
Wilkerson	4-24,25	Worsham	3-12
Wilkins	3-35//4-28	Wortham	3-13
Williams	2-22,23,29,40//	Wrenn	4-12
	3-5,10,20,30//	Wright	1-5//4-23
	4-6,30	Wrightman	3-19
Williamson	1-34,35,36,38,39,	Wroten	3-27
	40,41,42//	Wyman	4-6
	2-16,17,18,19,20,		
	21,22//4-6	Yates	1-5//3-9
Willet	4-29	Yeary	2-24
Willie	3-8	Yell	3-20
Willis	2-18//3-5	Yeomans	3-8
Willomet	1-2	Yokum	3-40
Wilson	2-9,25//3-8	Young	1-5//2-3//3-8,42,
Winans	3-18		43,44
Winchell	4-22	Younger	1-6,7

Note: Four articles are not indexed, the first three being alphabetically arranged, and the fourth being listed by consecutive years, and indexing it would require a supplemental index: the articles are:

1. Early Dallas County Cemetery Records - Vol. IX No. 2, pages 2-11.
2. Index to 1850 Census of Dallas County, Texas, No. 2, pages 32-35.
3. Recent Acquisitions, Texas History & Genealogy Department, No. 1, page 8.
4. Wayne County, Kentucky Early Marriage Records 1801-1813.
No. 1 pages 29-33
No. 2 pages 4-7

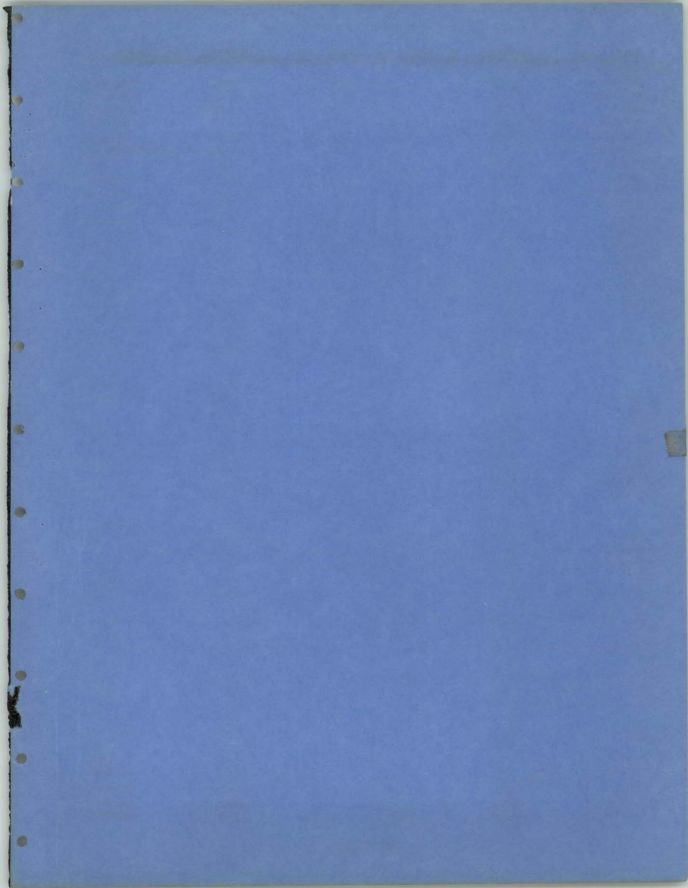

MRS. R. E. DISHMAN
Vice President, Publication-Editor
10609 Longmeadow Drive
Dallas, Texas 75238



Return Postage Guaranteed

Special Fourth Class Rate
BOOK

Mrs. Lucile A. Boykin
5717-C McCommas
Dallas Tx 75206